

SEC. 32, T 22 N, R 2 E, 3RD PM

EXISTING R.O.W 80' LT.

EXISTING R.O.W 60' LT.

EXISTING S.N. 057-0093
5 SPAN PCPS BOX BEAM BRIDGE
@ STA. 428+16.72, SKEWED 0°
292'-4" BK. TO BK., REMOVAL OF
EXISTING STRUCTURE NO. 1 I.O EACH

EXISTING R.O.W 60' LT.

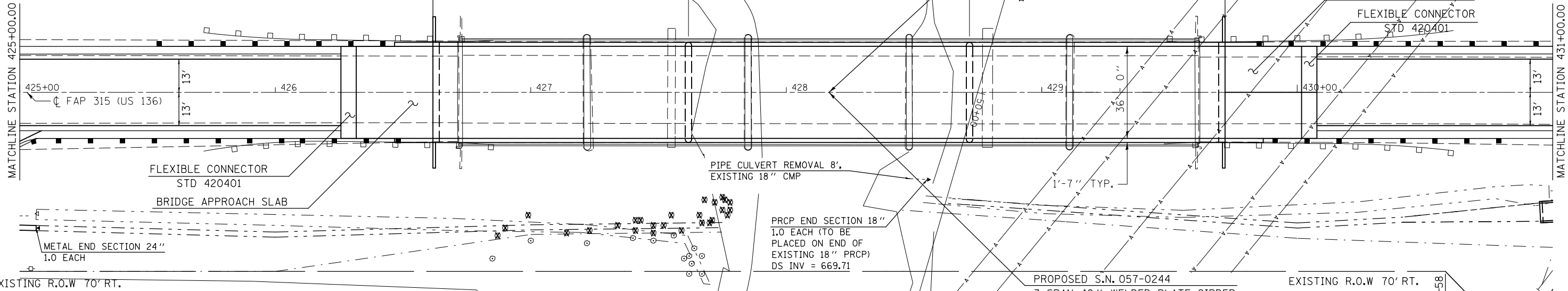

SEC. 5, T 21 N, R 2 E, 3RD PM

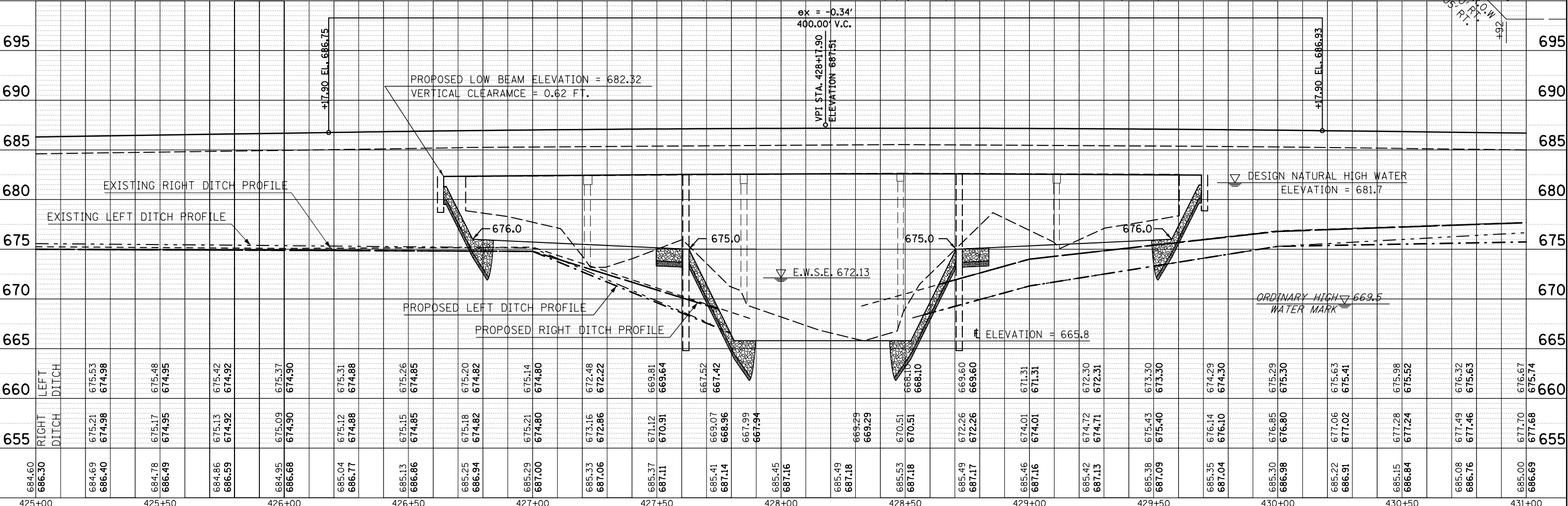

PROFILE	SURVEYED	DATE
	PLOTTED	
	GRADES CHECKED	
	STRUCTURE NOTATIONS CHECKED	
NOTE BOOK NO.		

FILE NAME =	USER NAME = hoganbj	DESIGNED -	REVISED -
c:\pwork\pwork\hoganbj\d0142533\d57052-shr-plnprf.dgn		DRAWN -	REVISED -
PLOT SCALE = 40.0000' / in.		CHECKED -	REVISED -
PLOT DATE = 8/22/2011		DATE -	REVISED -

STATE OF ILLINOIS
DEPARTMENT OF TRANSPORTATION

PLAN AND PROFILE SHEET

SCALE: SHEET NO. 3 OF 5 SHEETS STA. 425+00.00 TO STA. 431+00.00

F.A.P. RTF.	SECTION	COUNTY	TOTAL SHEETS	SHEET NO.
315	121BR-2	McLean	144	27
CONTRACT NO. 70552				
ILLINOIS FED. AID PROJECT				