

# TEMPORARY CONCRETE BARRIER LAYOUT - STAGE I

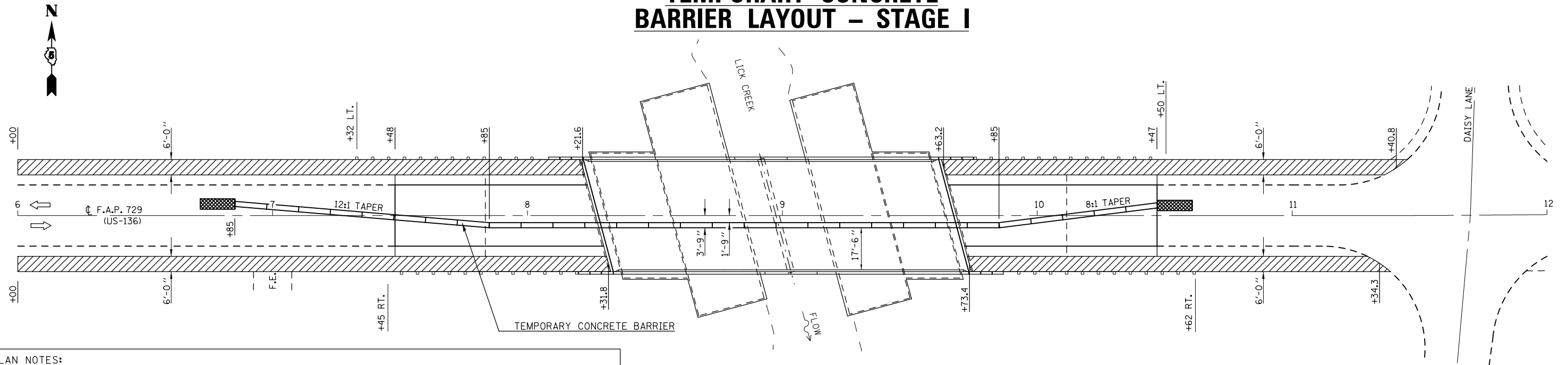

**PLAN NOTES:**

ALL STAGING DETAILS SET UP IN ACCORDANCE WITH TRAFFIC CONTROL AND PROTECTION 701321.

PRIOR TO BARRIER PLACEMENT TRAFFIC CONTROL SHALL BE SET UP IN ACCORDANCE WITH STANDARD 701201.

FOR ADDITIONAL DETAILS ASSOCIATED WITH TEMPORARY CONCRETE BARRIER, SEE STANDARD 704001.

THE CONTRACTOR SHALL PROVIDE AND MAINTAIN ACCESS TO COMMERCIAL AND PRIVATE PROPERTIES ABUTTING THE HIGHWAY BEING IMPROVED IN ACCORDANCE WITH ARTICLE 107.09 OF THE STANDARD SPECIFICATIONS.

REFLECTORS AND VERTICAL PANELS FOR BARRIER WALL, BRIDGE RAIL AND GUARDRAIL SHALL BE INCLUDED IN THE COST FOR THE APPLICABLE TRAFFIC CONTROL PAY ITEMS.

ATTACH VERTICAL PANELS TO THE GUARDRAIL AT 25 FOOT CENTERS. THIS COST WILL BE INCIDENTAL TO STANDARD 701321.

REFLECTORIZED TEMPORARY MARKING TAPE SHALL BE PLACED THROUGHOUT THE TAPER, ALONGSIDE THE WORK AREA, ON BOTH SIDES OF THE WORK AREA FROM STOP BAR TO STOP BAR. ALSO, ANY EXISTING MARKINGS THAT CONFLICT WITH THE STAGED TRAFFIC MARKINGS SHALL BE REMOVED. COST OF THE REMOVAL OF EXISTING MARKINGS AND FOR THE PLACEMENT AND REMOVAL OF TEMPORARY MARKINGS SHALL BE INCLUDED IN COST FOR APPLICABLE TRAFFIC CONTROL PAY ITEMS.

# TEMPORARY CONCRETE BARRIER LAYOUT - STAGE II

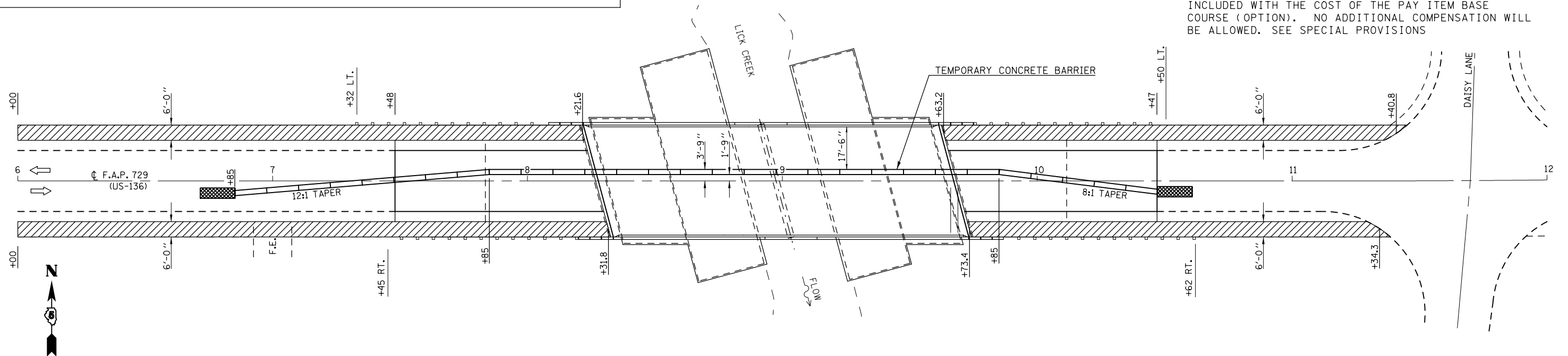

**SYMBOLS**

- TEMPORARY CONCRETE BARRIER
- IMPACT ATTENUATOR
- BASE COURSE (OPTION)

**SCHEDULE FOR BASE COURSE (OPTION)\***

STA. 6+00.0 LT. TO 8+21.6 LT.	147.7 SQ YD
STA. 9+63.2 LT. TO 11+40.8 LT.	118.4 SQ YD
STA. 6+00.0 RT. TO 8+31.8 RT.	154.6 SQ YD
STA. 9+73.4 RT. TO 11+34.3 RT.	107.3 SQ YD
<b>TOTAL: 528.0 SQ YD</b>	

\* EXCAVATION REQUIRED TO PLACE THE BASE COURSE IS INCLUDED WITH THE COST OF THE PAY ITEM BASE COURSE (OPTION). NO ADDITIONAL COMPENSATION WILL BE ALLOWED. SEE SPECIAL PROVISIONS

FILE NAME =	USER NAME = s1msgm	DESIGNED - GMS	REVISED -
ei:\pwwork\pwwid\msgm\0132144\057056-sht-Structure Repair Plans.dgn		DRAWN - GMS	REVISED -
	PLOT SCALE = 40.0001' / in.	CHECKED -	REVISED -
	PLOT DATE = 6/14/2011	DATE -	REVISED -

**STATE OF ILLINOIS  
DEPARTMENT OF TRANSPORTATION**

**TEMPORARY CONCRETE BARRIER LAYOUT  
S.N. 092-0144**

SCALE: SHEET NO. 3 OF 18 SHEETS STA. TO STA.

F.A.P. RTE.	SECTION	COUNTY	TOTAL SHEETS	SHEET NO.
729	38BR-1	VERMILION	25	6
CONTRACT NO. 70596				
FED. ROAD DIST. NO.		ILLINOIS FED. AID PROJECT		