

$\Delta = 1^\circ 43' 33''$  (LT) SEC. 19, T 14 N, R 13 W, 2ND P.M.  
 $D = 0^\circ 10' 08''$   
 $R = 33,943.18'$   
 $T = 511.25'$   
 $L = 1,022.43'$   
 $E = 3.85'$   
 $e = \text{-----}$   
 $T.R. = \text{-----}$   
 $S.E. RUN = \text{-----}$   
 $P.C. STA. = 122+85.90$   
 $P.T. STA. = 133+08.33$



A.R. STA. 126+54 EXIST. S.N. 023-8039  
 EXIST. R.C. BOX CULVERT 8'-0" X 4'-0"  
 SKEWED 10 DEG. RIGHT FORWARD  
 WITH CAST-IN-PLACE  
 END SECTIONS TO BE REMOVED  
 REMOVE EXISTING STRUCTURE NO. 1

PROPOSED S.N. 023-8064, STA. 126+55  
 PRECAST CONCRETE BOX CULVERT (M273)  
 12'-0" X 4'-0" X 38'-0", NO SKEW  
 U.S.F.L. ELEV. 662.10  
 D.S.F.L. ELEV. 662.00  
 WITH CAST-IN-PLACE END SECTIONS-2 EACH  
 BOX CULVERT END SECTIONS, CULVERT NO. 1

6" PVC WATER MAIN  
 PLACED +/- 42" DEPTH

EXISTING 24" FIELD TILE

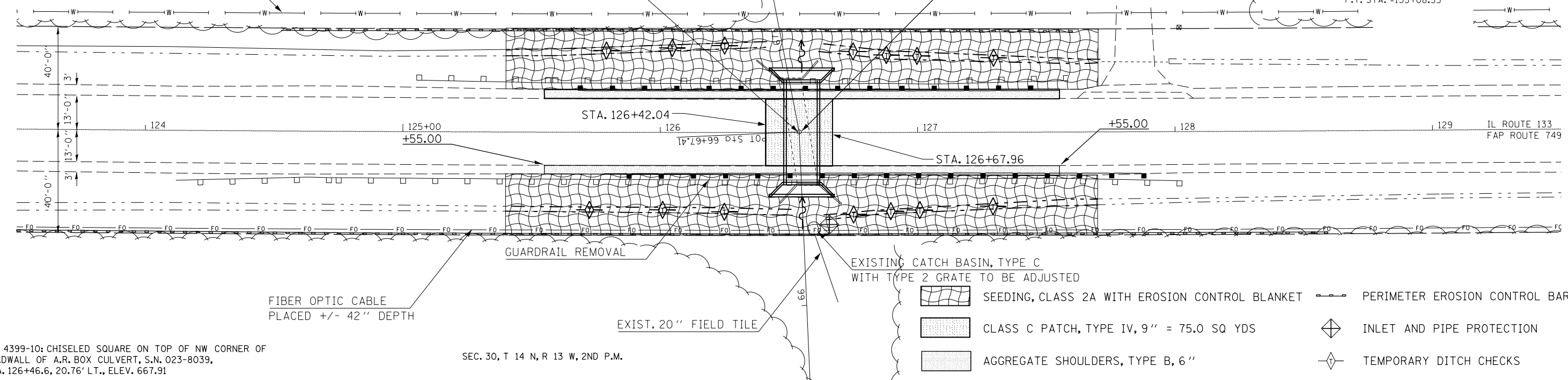

FIBER OPTIC CABLE  
 PLACED +/- 42" DEPTH

GUARDRAIL REMOVAL

EXISTING CATCH BASIN, TYPE C  
 WITH TYPE 2 GRATE TO BE ADJUSTED

EXIST. 20" FIELD TILE

- SEEDING, CLASS 2A WITH EROSION CONTROL BLANKET
- CLASS C PATCH, TYPE IV, 9" = 75.0 SQ YDS
- AGGREGATE SHOULDERS, TYPE B, 6"
- PERIMETER EROSION CONTROL BARRIER
- INLET AND PIPE PROTECTION
- TEMPORARY DITCH CHECKS

BM 4399-10: CHISELED SQUARE ON TOP OF NW CORNER OF  
 HEADWALL OF A.R. BOX CULVERT, S.N. 023-8039,  
 STA. 126+46.6, 20.76' LT., ELEV. 667.91

SEC. 30, T 14 N, R 13 W, 2ND P.M.

LIMITS OF ROADWAY WORK

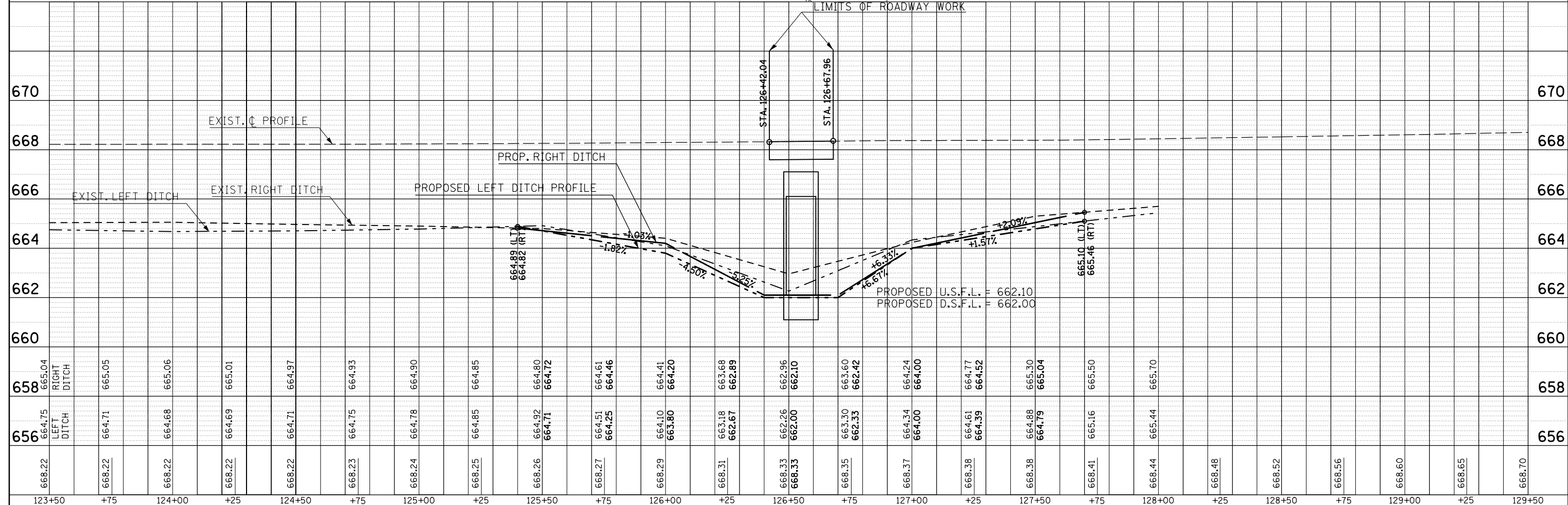

|                             |  |
|-----------------------------|--|
| DATE                        |  |
| BY                          |  |
| PLAN                        |  |
| SURVEYED                    |  |
| PLOTTED                     |  |
| GRADES CHECKED              |  |
| STRUCTURE NOTATIONS CHECKED |  |
| NOTE BOOK NO.               |  |
| CARD FILE NAME              |  |

|                             |  |
|-----------------------------|--|
| DATE                        |  |
| BY                          |  |
| PROFILE                     |  |
| SURVEYED                    |  |
| PLOTTED                     |  |
| GRADES CHECKED              |  |
| STRUCTURE NOTATIONS CHECKED |  |
| NOTE BOOK NO.               |  |
| CARD FILE NAME              |  |

|                                       |                    |            |           |   |  |                           |                   |        |              |           |
|---------------------------------------|--------------------|------------|-----------|---|--|---------------------------|-------------------|--------|--------------|-----------|
| FILE NAME =                           | USER NAME = keyarb | DESIGNED - | REVISED - | <b>STATE OF ILLINOIS</b><br><b>DEPARTMENT OF TRANSPORTATION</b> | <b>PLAN &amp; PROFILE: PROP. S.N. 023-8064 CULVERT NO. 1</b> | F.A.P. RTE.               | SECTION           | COUNTY | TOTAL SHEETS | SHEET NO. |
| c:\pwork\pwork\keysrb\0104347\0570618 | sh-t-plnprf_20.dgn | DRAWN -    | REVISED - |   |  | 749                       | 14BR, 14CR, 123CR | Edgar  | 115          | 18        |
| PLOT SCALE = 40.0000' / in.           |                    | CHECKED -  | REVISED - |   |  | CONTRACT NO. 70618        |                   |        |              |           |
| PLOT DATE = 8/25/2011                 |                    | DATE -     | REVISED - |   |  | ILLINOIS FED. AID PROJECT |                   |        |              |           |