

PLAN	SURVEYED	BY	DATE
	PLOTTED		
	ALIGNED		
	CHECKED		
	FILE NAME		
	NO.		

PROFILE	SURVEYED	BY	DATE
	PLOTTED		
	GRADES CHECKED		
	STRUCTURE NOTATIONS CHECKED		
	NO.		

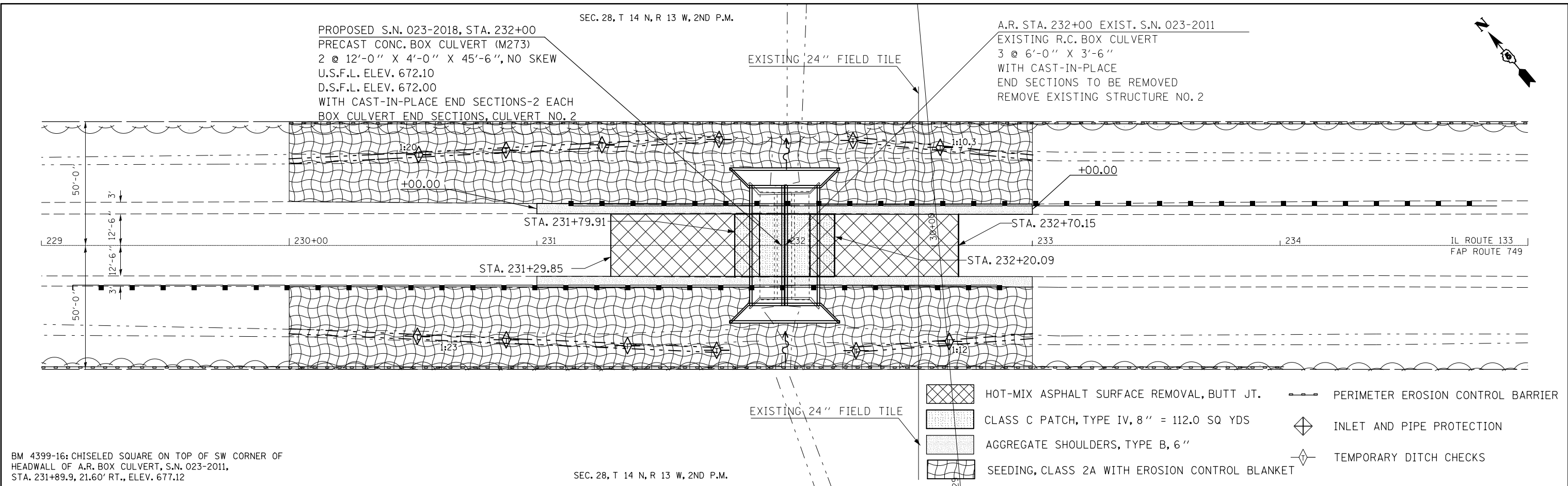

BM 4399-16: CHISELED SQUARE ON TOP OF SW CORNER OF HEADWALL OF A.R. BOX CULVERT, S.N. 023-2011, STA. 231+89.9, 21.60' RT., ELEV. 677.12

SEC. 28, T 14 N, R 13 W, 2ND P.M.

- HOT-MIX ASPHALT SURFACE REMOVAL, BUTT JT.
- CLASS C PATCH, TYPE IV, 8" = 112.0 SQ YDS
- AGGREGATE SHOULDERS, TYPE B, 6"
- SEEDING, CLASS 2A WITH EROSION CONTROL BLANKET
- PERIMETER EROSION CONTROL BARRIER
- INLET AND PIPE PROTECTION
- TEMPORARY DITCH CHECKS

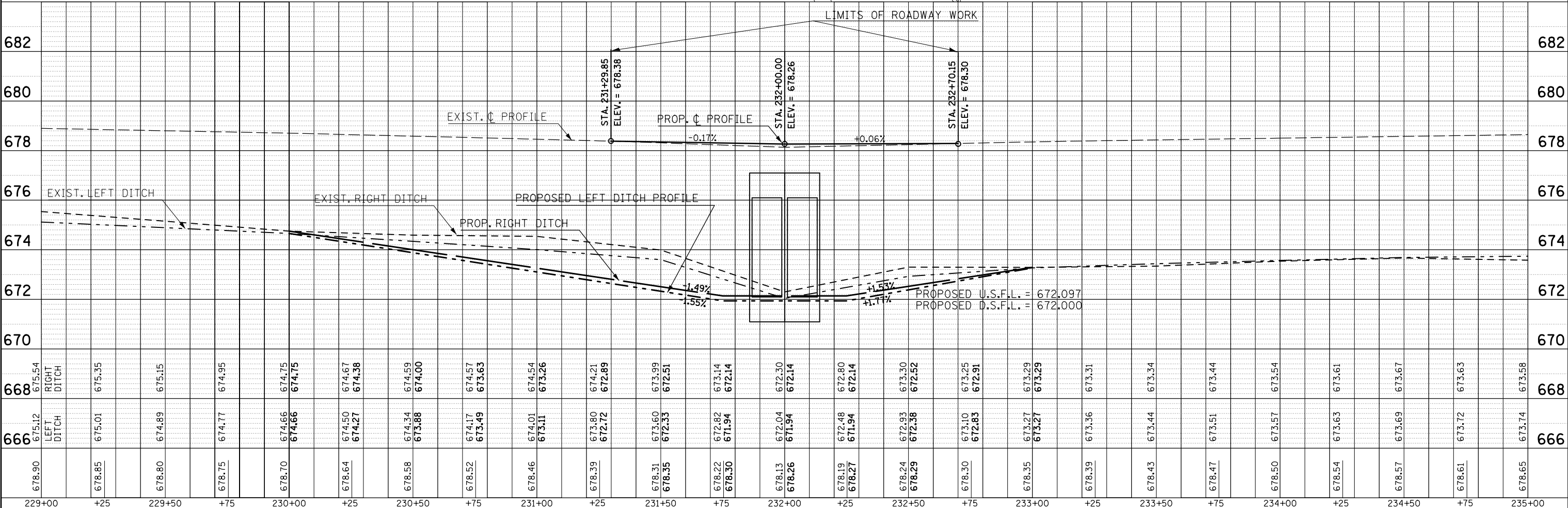

FILE NAME =	USER NAME = keyarb	DESIGNED -	REVISED -
c:\pwork\pwork\keysrb\d0104347\0570618	sh-t-plnprf_20.dgn	DRAWN -	REVISED -
	PLOT SCALE = 40.0000' / in.	CHECKED -	REVISED -
	PLOT DATE = 8/25/2011	DATE -	REVISED -

STATE OF ILLINOIS
DEPARTMENT OF TRANSPORTATION

PLAN & PROFILE: PROP. S.N. 023-2018 CULVERT NO. 2

SCALE: SHEET NO. 1 OF 1 SHEETS STA. TO STA.

F.A.P. RTE.	SECTION	COUNTY	TOTAL SHEETS	SHEET NO.
749	14BR, 14CR, 123CR	Edgar	115	23
CONTRACT NO.			70618	
ILLINOIS FED. AID PROJECT				