

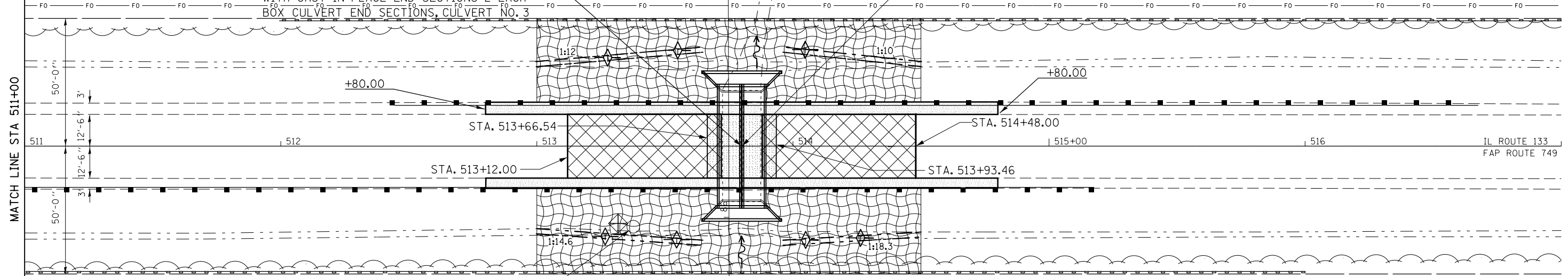

PROPOSED S.N. 023-8065, STA. 513+80
 PRECAST CONC. BOX CULVERT (M273)
 2 @ 8'-0" X 3'-0" X 45'-6", NO SKEW
 U.S.F.L. ELEV. 700.54
 D.S.F.L. ELEV. 700.44
 WITH CAST-IN-PLACE END SECTIONS-2 EACH
 BOX CULVERT END SECTIONS, CULVERT NO. 3

EXISTING 16" FIELD TILE

A.R. STA. 513+80 EXIST. S.N. 023-8306
 EXISTING R.C. BOX CULVERT
 2 @ 7'-0" X 2'-0"
 WITH CAST-IN-PLACE
 END SECTIONS TO BE REMOVED
 REMOVE EXISTING STRUCTURE NO. 3



PLAN	SURVEYED	BY	DATE
	PLOTTED		
	GRADES CHECKED		
	STRUCTURE NOTATIONS CHECKED		
	NOTE BOOK NO.		
	CADD FILE NAME		

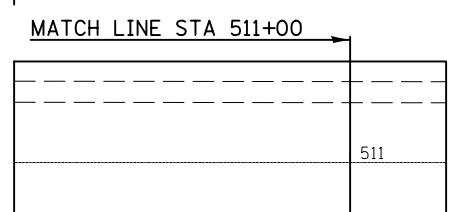

EXISTING CATCH BASIN, TYPE C
 WITH TYPE B GRATE TO BE ADJUSTED

BM 4399-35: CHISELED SQUARE ON TOP OF SE CORNER OF
 HEADWALL OF A.R. BOX CULVERT, S.N. 023-8306,
 STA. 513+87.4, 21.49' RT., ELEV. 704.42

- HOT-MIX ASPHALT SURFACE REMOVAL, BUTT JT.
- CLASS C PATCH, TYPE IV, 8" = 75.0 SQ YDS
- AGGREGATE SHOULDERS, TYPE B, 6"
- SEEDING, CLASS 2A WITH EROSION CONTROL BLANKET
- PERIMETER EROSION CONTROL BARRIER
- INLET AND PIPE PROTECTION
- TEMPORARY DITCH CHECKS

SEC. 5, T 13 N, R 12 W, 2ND P.M.

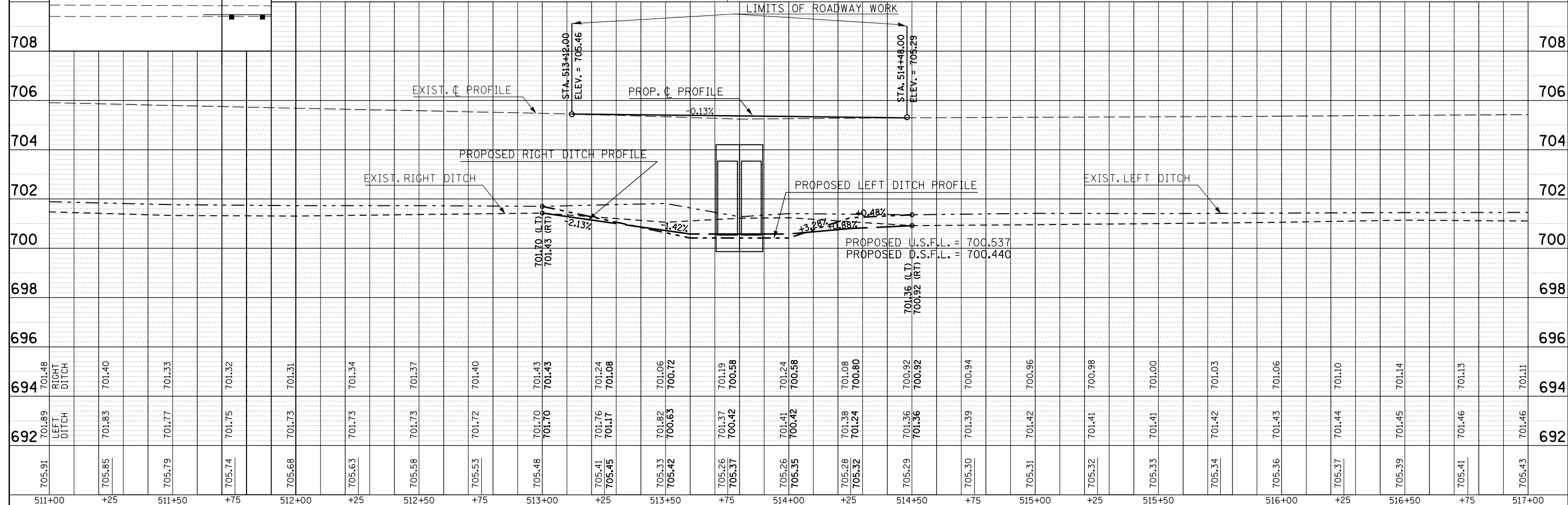

PROFILE	SURVEYED	BY	DATE
	PLOTTED		
	GRADES CHECKED		
	STRUCTURE NOTATIONS CHECKED		
	NOTE BOOK NO.		
	CADD FILE NAME		

FILE NAME =	USER NAME = keyarb	DESIGNED -	REVISED -	<p align="center">STATE OF ILLINOIS DEPARTMENT OF TRANSPORTATION</p> <p align="center">PLAN & PROFILE: PROP. S.N. 023-8065 CULVERT NO. 3</p>	F.A.P. RTE.	SECTION	COUNTY	TOTAL SHEETS	SHEET NO.
c:\pwork\pwork\keysrb\d0104347\0570618	sh-t-plnprf_20.dgn	DRAWN -	REVISED -		749	14BR, 14CR, 123CR	Edgar	115	29
	PLOT SCALE = 40.0000' / in.	CHECKED -	REVISED -		CONTRACT NO. 70618				
	PLOT DATE = 8/25/2011	DATE -	REVISED -		ILLINOIS FED. AID PROJECT				