

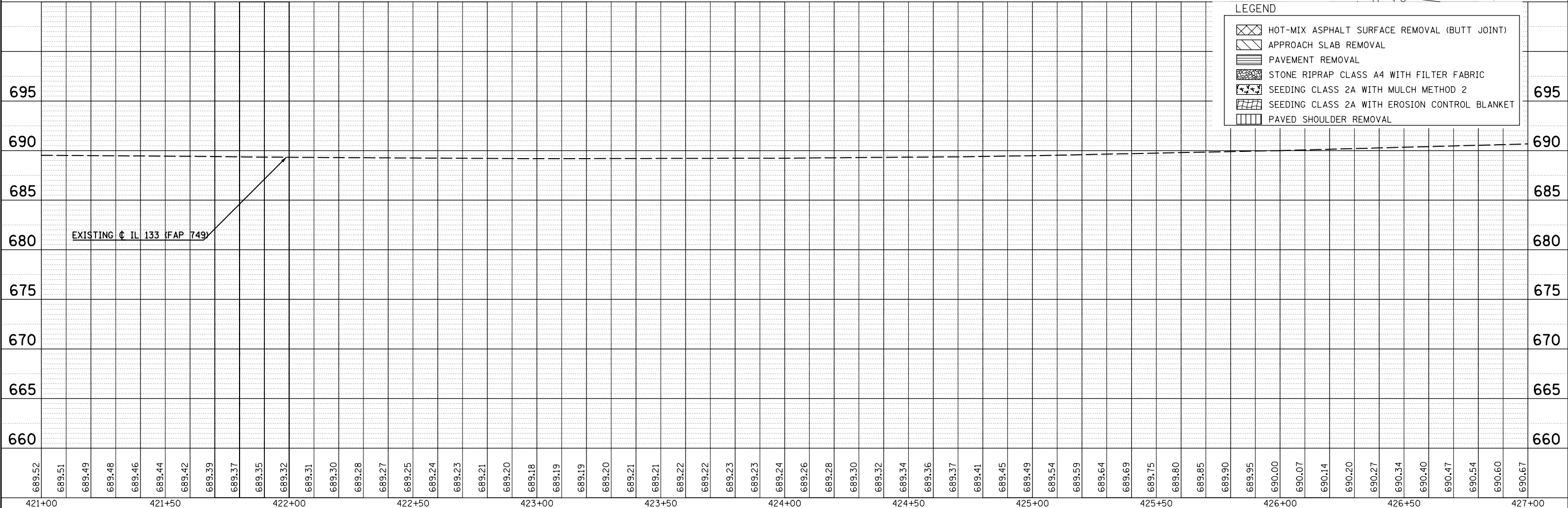

PLAN	SURVEYED	BY	DATE
	PLOTTED		
	CHECKED		
	FILE NAME		

PROFILE	SURVEYED	BY	DATE
	PLOTTED		
	CHECKED		
	FILE NAME		

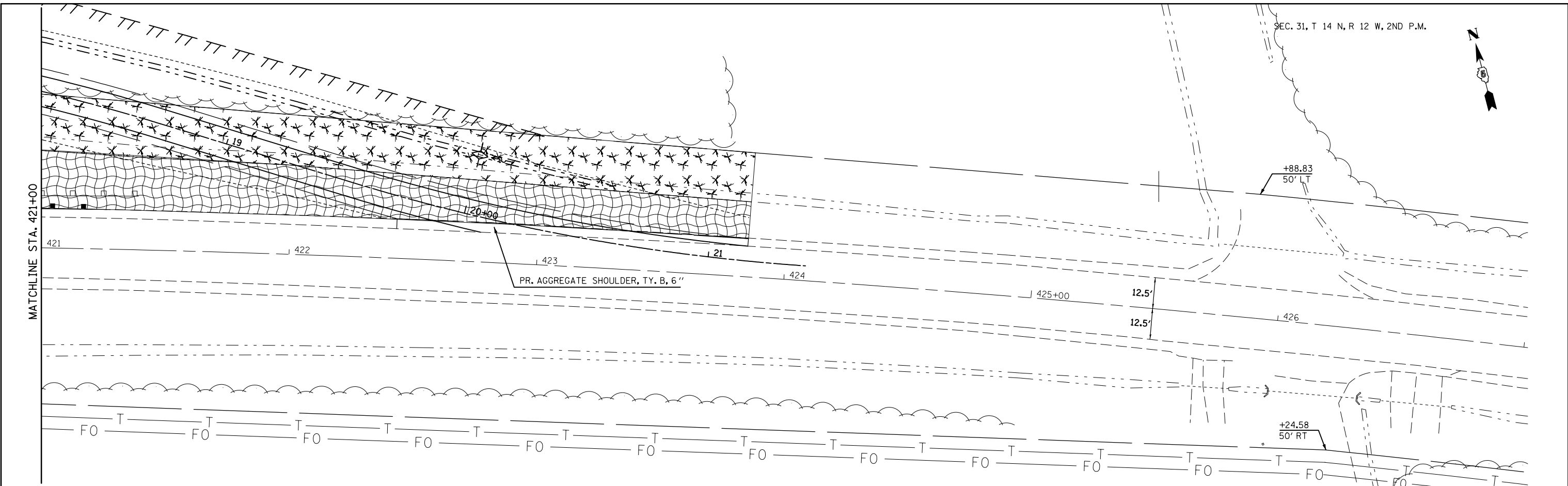

**LEGEND**

- HOT-MIX ASPHALT SURFACE REMOVAL (BUTT JOINT)
- APPROACH SLAB REMOVAL
- PAVEMENT REMOVAL
- STONE RIPRAP CLASS A4 WITH FILTER FABRIC
- SEEDING CLASS 2A WITH MULCH METHOD 2
- SEEDING CLASS 2A WITH EROSION CONTROL BLANKET
- PAVED SHOULDER REMOVAL

FILE NAME =	USER NAME = keyarb	DESIGNED -	REVISED -	<b>STATE OF ILLINOIS DEPARTMENT OF TRANSPORTATION</b>	<b>IL 133 OVER DRAINAGE DITCH NO. 7 PLAN AND PROFILE</b>	F.A.P. RTE.	SECTION	COUNTY	TOTAL SHEETS	SHEET NO.
c:\pwork\pwork\keyarb\0104347\0570618	plan_sheets.dgn	DRAWN -	REVISED -			749	14BR, 14CR, 123CR	EDGAR	115	36
	PLOT SCALE = 40.0000' / in.	CHECKED -	REVISED -			CONTRACT NO. 70618				
	PLOT DATE = 8/25/2011	DATE -	REVISED -			ILLINOIS FED. AID PROJECT				