

STATE OF ILLINOIS
DEPARTMENT OF TRANSPORTATION
DIVISION OF HIGHWAYS

F.A.I. RTE.	SECTION	COUNTY	TOTAL SHEETS	SHEET NO.
74	(57-23,57-24)RS-1	MCLEAN	175	1
		ILLINOIS	CONTRACT NO. 70648	

D-95-006-08

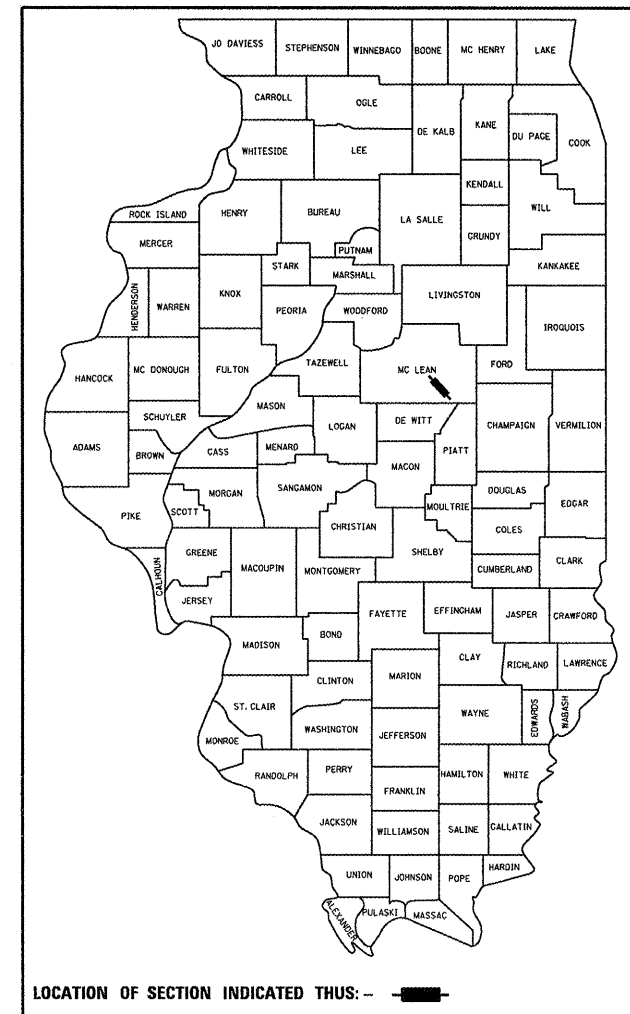

FOR DETAILED LOCATION MAP, SEE SHEET NO. 2
 FOR INDEX OF SHEETS, SEE SHEET NO. 3
 FOR SUMMARY OF QUANTITIES, SEE SHEET NO. 5 - 9

NOTE:
 SEE GENERAL NOTES FOR STRUCTURE INFORMATION

CURRENT TRAFFIC DATA

F.A.I. ROUTE 74

	LEG "A"	LEG "B"
2011 ADT =	19,500	18,800
PV % =	68.9	67.6
SU % =	4.0	3.9
MU % =	27.1	28.5

TRAFFIC DATA LOCATIONS

LEG "A" = DOWNS TO LE ROY
 LEG "B" = LE ROY TO US 136

DESIGN DESIGNATION

INTERSTATE

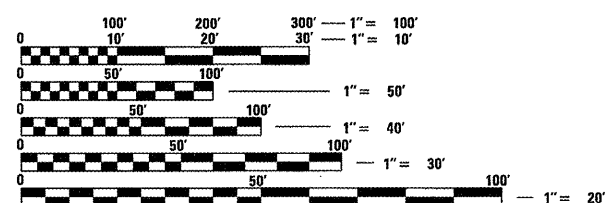

FULL SIZE PLANS HAVE BEEN PREPARED USING STANDARD ENGINEERING SCALES. REDUCED SIZED PLANS WILL NOT CONFORM TO STANDARD SCALES. IN MAKING MEASUREMENTS ON REDUCED PLANS, THE ABOVE SCALES MAY BE USED.

J.U.L.I.E.
 JOINT UTILITY LOCATION INFORMATION FOR EXCAVATION
 1-800-892-0123
 OR 811

TOWNSHIPS: DOWNS, EMPIRE

PROJECT ENGINEER: JASON STULTS
SQUAD LEADER: GREG EAGLIN
 217-465-4181

CONTRACT NO. 70648

PROPOSED
HIGHWAY PLANS

F.A.I. ROUTE 74 / (I-74)
SECTION (57-23,57-24)RS-1
PROJECT ACIM-074-5(165)150
RESURFACING (INT-2ND)
MCLEAN COUNTY

C-95-006-08

DOWNS TO EAST OF LEROY

SECTION: (57-23,57-24)RS-1
 BEGINS @ STA. 1111+00.00

STATION EQUATION:
 STA. 1241+13.89 (BK) =
 STA. 100+00.00 (AH)

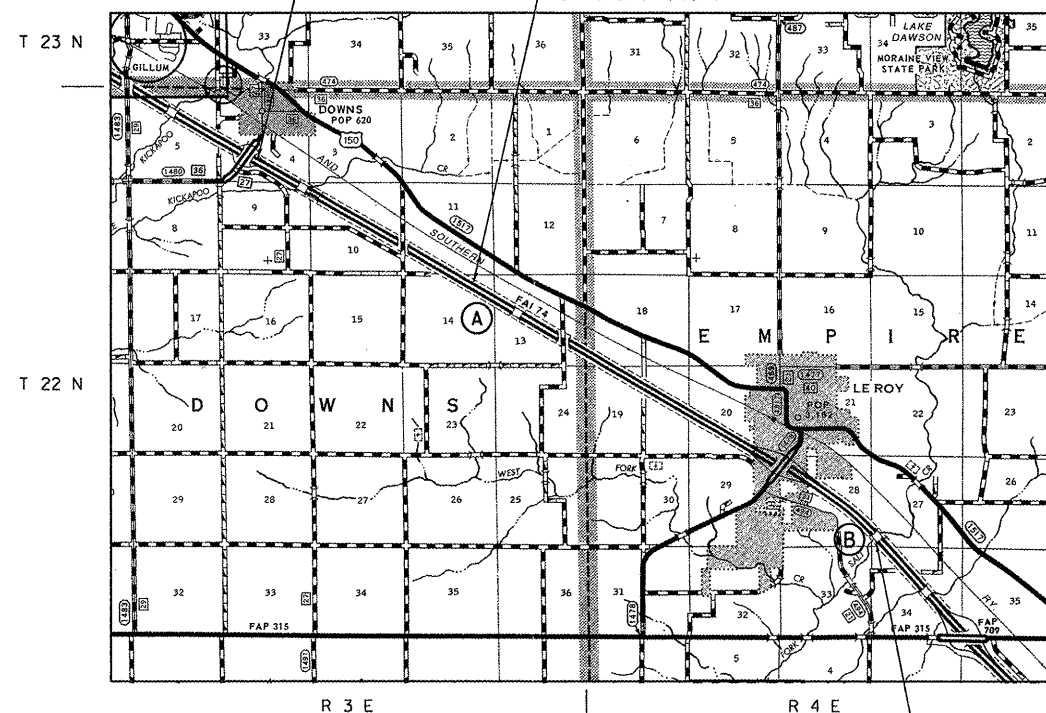

SECTION: (57-23,57-24)RS-1
 ENDS @ STA. 382+00.00

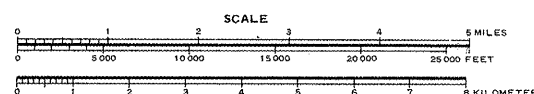

TOTAL LENGTH OF SECTION & PROJECT = 41,213.89 FT. = 7.806 MILES
 NET LENGTH OF SECTION & PROJECT = 40,407.11 FT. = 7.653 MILES
 (NOTE: LENGTHS ARE CALCULATED ALONG EASTBOUND LANE)



SEE SHEET 2 FOR
 STRUCTURE
 INFORMATION

STATE OF ILLINOIS
 DEPARTMENT OF TRANSPORTATION
 DIVISION OF HIGHWAYS

SUBMITTED 8/25 20 11
Jason M. Stults
 DEPUTY DIRECTOR OF HIGHWAYS, REGION ENGINEER

Oct 14 20 11
Scott E. Stitt P.E. | a
 acting ENGINEER OF DESIGN AND ENVIRONMENT

Oct 14 20 11
Christine M. Reed | a
 DIRECTOR OF HIGHWAYS, CHIEF ENGINEER

PRINTED BY THE AUTHORITY
OF THE STATE OF ILLINOIS