

SEC. 10, T. 22 N., R. 3 E., 3RD P.M.

EXIST. CURVE 107
 PI STA. = 1140+59.19
 $\Delta = 2^\circ 14' 16''$ (RT)
 $D = 0^\circ 15' 02''$
 $R = 22,866.95'$
 $T = 446.63'$
 $L = 893.15'$
 $E = 4.36'$
 $e = \text{N.C.}$
 $T.R. = \text{-----}$
 $S.E. \text{ RUN} = \text{-----}$
 P.C. STA. = 1136+12.55
 P.T. STA. = 1145+05.70

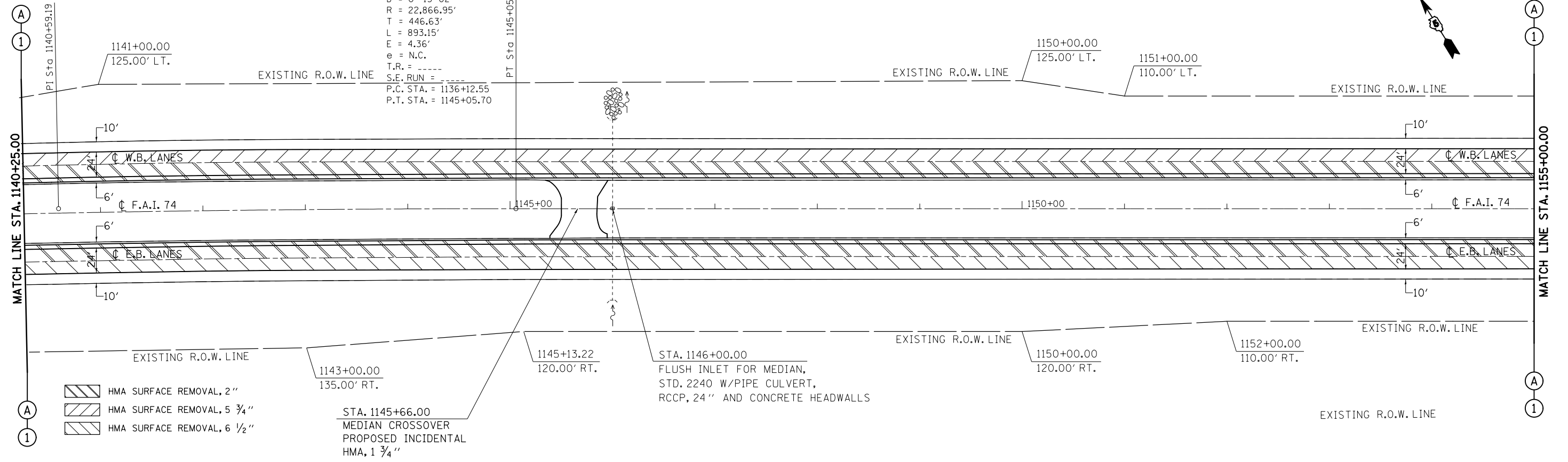

- HMA SURFACE REMOVAL, 2"
- HMA SURFACE REMOVAL, 5 3/4"
- HMA SURFACE REMOVAL, 6 1/2"

STA. 1145+66.00
 MEDIAN CROSSOVER
 PROPOSED INCIDENTAL
 HMA, 1 3/4"

STA. 1146+00.00
 FLUSH INLET FOR MEDIAN,
 STD. 2240 W/PIPE CULVERT,
 RCCP, 24" AND CONCRETE HEADWALLS

SEC. 10, T. 22 N., R. 3 E., 3RD P.M.

STA. 1160+50.00
 INLET BOX, ST. 2244 W/
 PIPE CULVERT, TYPE 1, RCCP, 24"
 AND CONCRETE HEADWALL

 PROPOSED DRAINAGE
 STRUCTURE IMPROVEMENT
 LOCATION #1
 (SEE DETAIL, SHEET 102)

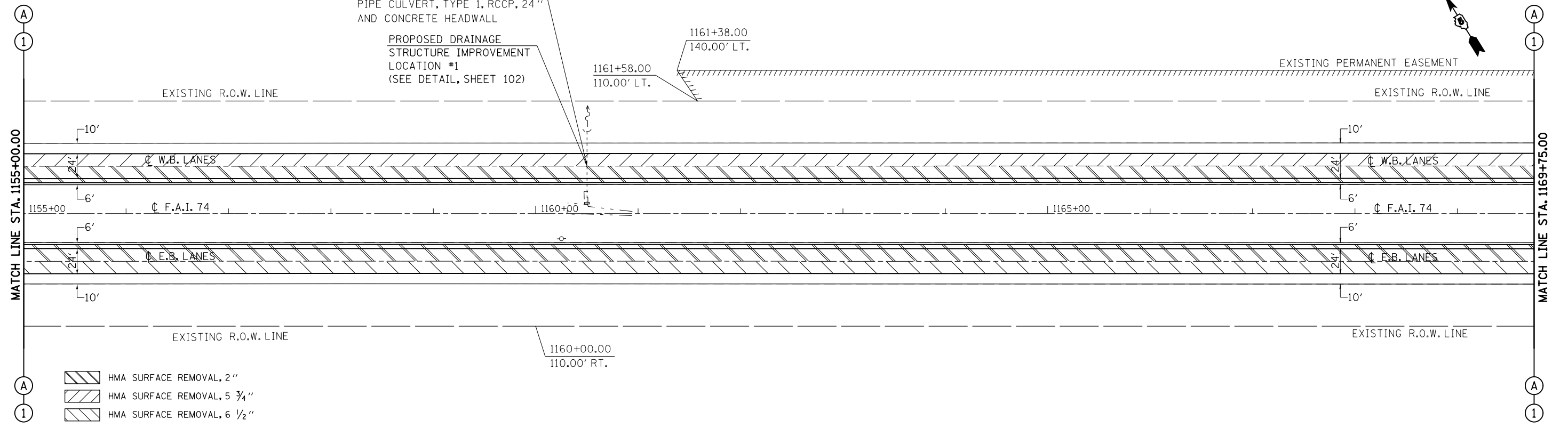

- HMA SURFACE REMOVAL, 2"
- HMA SURFACE REMOVAL, 5 3/4"
- HMA SURFACE REMOVAL, 6 1/2"

1160+00.00
 110.00' RT.

FILE NAME =	USER NAME = ppersonbr	DESIGNED - GAE	REVISED -	STATE OF ILLINOIS DEPARTMENT OF TRANSPORTATION	F.A.I. 74 (I-74) PLAN SHEETS	F.A.I. RTE. = 74	SECTION = (57-23,57-24)RS-1	COUNTY = MCLEAN	TOTAL SHEETS = 175	SHEET NO. = 41	
et:\pw\work\p\pidot\ppersonbr\d0184863\0570648-sh1-plan.dgn	PLOT SCALE = 100.0000' / in.	DRAWN - BBP	REVISED -			SCALE: 1" = 50'	SHEET NO. 3 OF 15 SHEETS	CONTRACT NO. 70648		ILLINOIS FED. AID PROJECT	
PLOT DATE = 8/25/2011	DATE = 08/26/10	CHECKED -	REVISED -								