

RAMP TRAFFIC CONTROL DETAIL

STAGE II
F.A.S. 1478
SOUTHBOUND LANE CLOSED
S.N. 057-0132

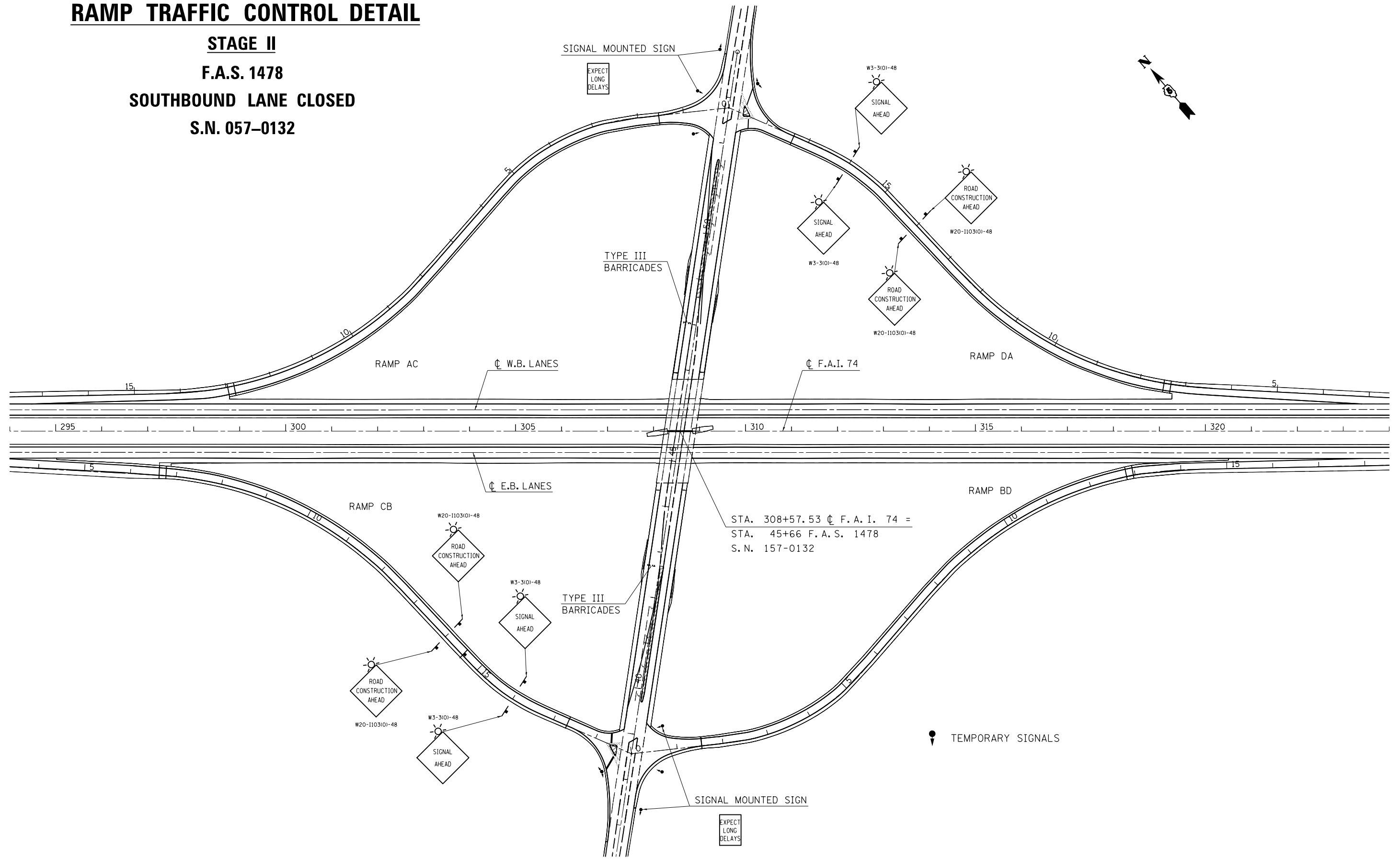

STA. 308+57.53 \dot{C} F. A. I. 74 =
 STA. 45+66 F. A. S. 1478
 S. N. 157-0132

FILE NAME =	USER NAME = ppersonbr	DESIGNED - GAE	REVISED -
et:\pw\work\p\dot\personbr\d0184863\0570648-sh-t-staging_FAS1478.dgn		DRAWN - BBP	REVISED -
	PLOT SCALE = 200.0000' / in.	CHECKED -	REVISED -
	PLOT DATE = 8/25/2011	DATE - 07/18/11	REVISED -

STATE OF ILLINOIS
DEPARTMENT OF TRANSPORTATION

RAMP TRAFFIC CONTROL DETAIL
STAGE II

SCALE: 1" = 100' SHEET NO. 3 OF 4 SHEETS STA. TO STA.

F.A.I. RTE.	SECTION	COUNTY	TOTAL SHEETS	SHEET NO.
74	(57-23,57-24)RS-1	MCLEAN	175	71
CONTRACT NO. 70648				
ILLINOIS FED. AID PROJECT				