

PAVEMENT MARKING LEGEND	
<i>(THERMOPLASTIC)</i>	
(A)	PAVEMENT MARKING - LINE - 5" WHITE (SOLID)
(B)	PAVEMENT MARKING - LINE - 5" YELLOW (SOLID)
(C)	PAVEMENT MARKING - LINE - 5" DOUBLE YELLOW (SOLID)
(D)	PAVEMENT MARKING - LINE - 8" WHITE (SOLID)
(E)	PAVEMENT MARKING - LINE - 12" YELLOW (SOLID)
(F)	PAVEMENT MARKING - LINE - 12" WHITE (SOLID)
(G)	PAVEMENT MARKING - LETTERS & SYMBOLS WHITE (SOLID)
<i>(PREFORMED PLASTIC, TYPE B - INLAID -)</i>	
(H)	PAVEMENT MARKING - LINE - 5" WHITE (SKIP-DASH - 10' DASH, 30' SKIP)
(I)	PAVEMENT MARKING - LINE - 6" WHITE (SOLID)
(J)	PAVEMENT MARKING - LINE - 6" WHITE (SHORT SKIP-DASH - 2' DASH, 6' SKIP)
(K)	PAVEMENT MARKING - LINE - 24" WHITE (SOLID)

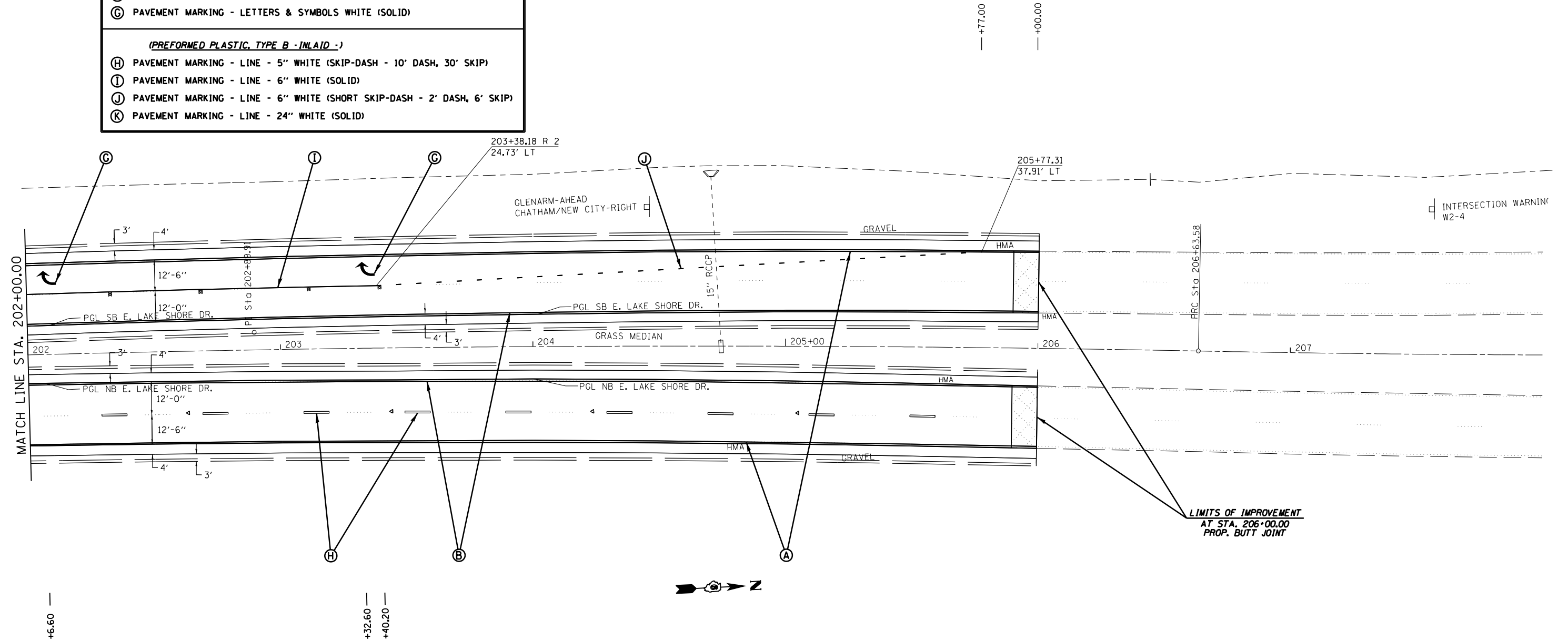

FILE NAME =	USER NAME = sparksgw	DESIGNED - JWC	REVISED -
c:\pwork\pwork\sparksgw\0221228\0672087-sht-pmk1.dgn		DRAWN - BSH	REVISED -
	PLOT SCALE = 40.0000' / in.	CHECKED - RSC	REVISED -
	PLOT DATE = Sep-01-2011 12:35:38PM	DATE -	REVISED -

**STATE OF ILLINOIS
DEPARTMENT OF TRANSPORTATION**

PAVEMENT MARKING DETAILS			
SCALE: 20	SHEET NO. 4 OF 4 SHEETS	STA. 202+00.00 TO STA. 206+00.00	

F.A.U. RTE.	SECTION	COUNTY	TOTAL SHEETS	SHEET NO.
7998	110TS,NL	SANGAMON	95	39
CONTRACT NO. 72C87			ILLINOIS FED. AID PROJECT	