

LEGEND

- PROPOSED COMBINATION LIGHTING UNIT, 250W HPS LUMINAIRE, M-C-III, ARM TYPE AND LENGTH AS NOTED 45' MOUNTING HEIGHT
- PROPOSED LIGHTING UNIT, 45' MM ALUMINUM POLE, 15' MAST ARM, 250W HPS LUMINAIRE, M-C-III
- PROPOSED LIGHTING CONTROLLER, PEDESTAL MOUNTED, 240V, 60A
- UNIT DUCT, 600V, 2-# NO. 10, 1/C NO. 10 GROUND (XLP-TYPE USE) 3/4" DIA. POLYETHYLENE
- CONDUIT PUSHED, 2" DIA. PVC

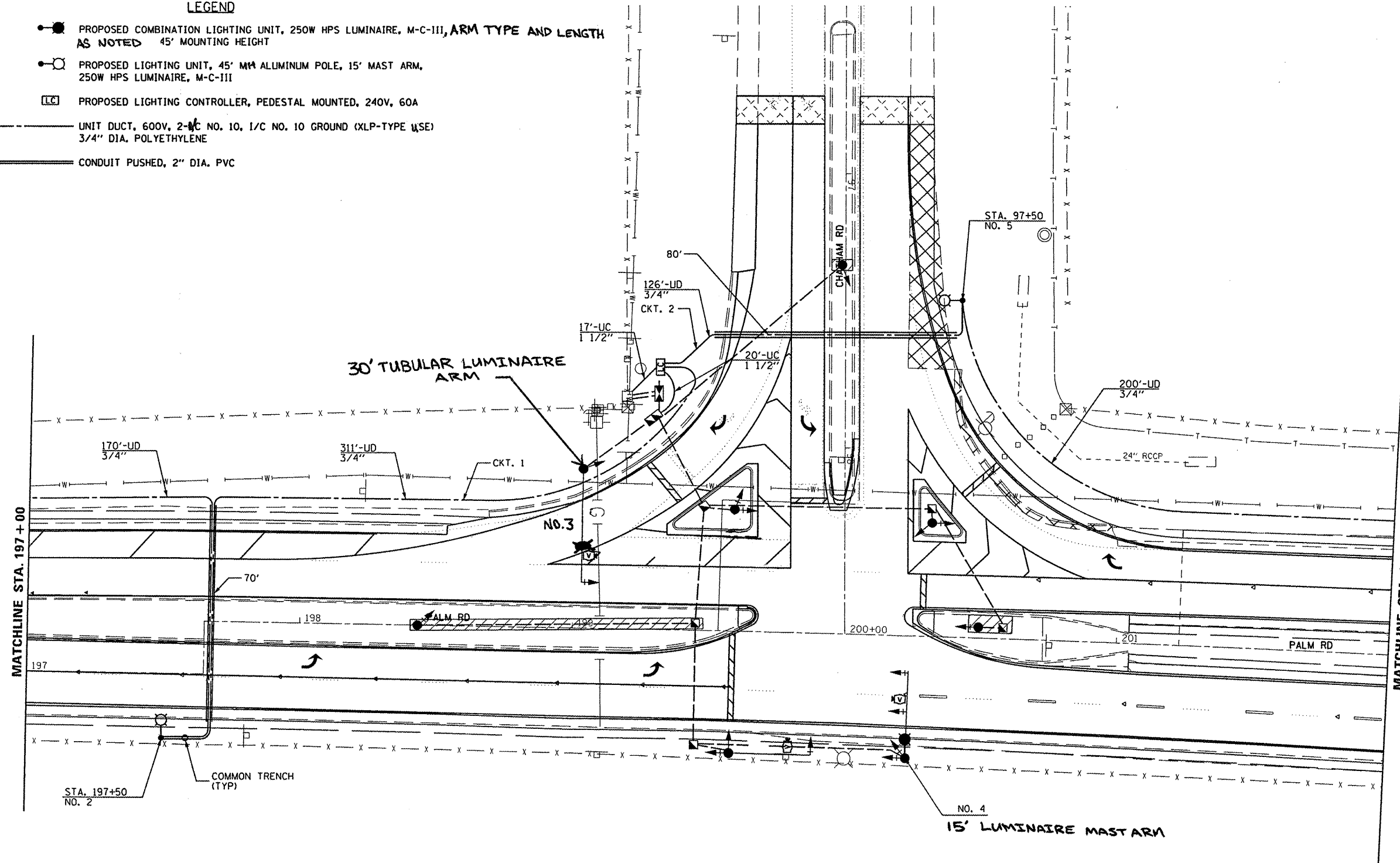

NOTES

1. PROPOSED LIGHT POLES TO BE INSTALLED AT A 12 FT SETBACK FROM THE EDGE OF TRAVELED PAVEMENT OR 4 FT BEHIND THE GUARDRAIL UNLESS NOTED OTHERWISE. NO POLE SHALL BE INSTALLED IN THE FLOWLINE OF DITCH. POLE SETBACK TO BE ADJUSTED IF NECESSARY AS DIRECTED BY THE ENGINEER.

FILE NAME =	USER NAME = sparksgw	DESIGNED -	REVISED -	STATE OF ILLINOIS DEPARTMENT OF TRANSPORTATION	PROPOSED LIGHTING PLAN			F.A.P. RTE.	SECTION	COUNTY	TOTAL SHEETS	SHEET NO.	
ci:\pw\work\p\rdot\sparksgw\d0278688\061	061\061\lighting_plan_01.dgn	DRAWN -	REVISED -		SCALE:	SHEET NO.	OF	SHEETS	STA.	TO STA.	7998	95	46
	PLOT SCALE = 40.0000' / 1" =	CHECKED -	REVISED -								SANGAMON	CONTRACT NO. 72C87	
	PLOT DATE = Sep-01-2011 12:36:05PM	DATE -	REVISED -								ILLINOIS FED. AID PROJECT		