

PROPOSED HMA SURFACE REMOVAL, 2"
 PROPOSED HMA SURFACE COURSE, MIX "D",
 N70 (2" DEPTH)

EXIST. CURVE #2
 P.I. STA= 930+46.67
 Δ = 10°30'02"
 D= 2°49'27"
 R= 2028.69'
 T= 186.42'
 L= 371.80'
 E= 8.55'
 S.E.=
 P.C. STA= 928+60.25
 P.T. STA= 932+32.05

NOTE:
 THE PROPOSED PAVEMENT STRIPING IS NOT SHOWN
 ON THIS PLAN SHEET. SEE PAVEMENT MARKING SHEETS
 AND SCHEDULES FOR PROPOSED STRIPING LOCATIONS.

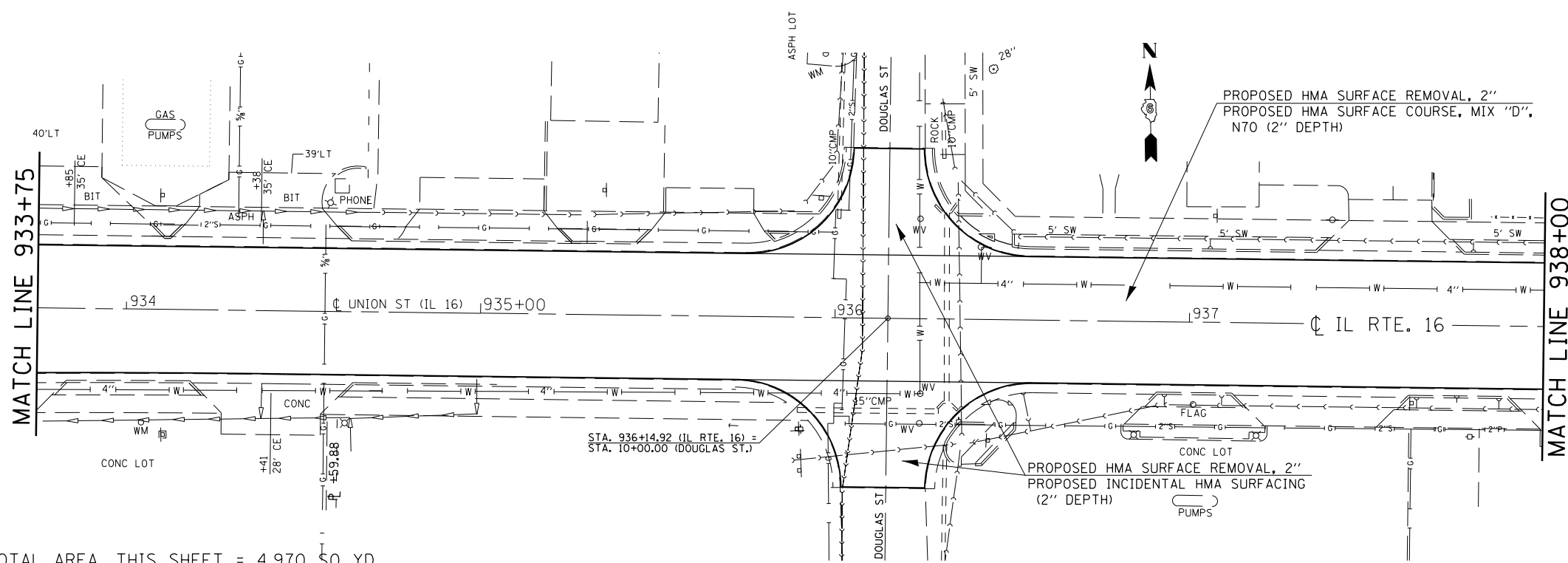

PROPOSED HMA SURFACE REMOVAL, 2"
 PROPOSED HMA SURFACE COURSE, MIX "D",
 N70 (2" DEPTH)

PROPOSED HMA SURFACE REMOVAL, 2"
 PROPOSED INCIDENTAL HMA SURFACING
 (2" DEPTH)

TOTAL AREA, THIS SHEET = 4,970 SQ YD

FILE NAME = c:\pwork\pwork\sparks\10222005\0672067-sht-plan.dgn	USER NAME = sparksq	DESIGNED - RTS	REVISED -	STATE OF ILLINOIS DEPARTMENT OF TRANSPORTATION	PLAN SHEET (LITCHFIELD)	F.A.P. RTE.	SECTION	COUNTY	TOTAL SHEETS	SHEET NO.
	PLOT SCALE = 40.0000' / in.	CHECKED -	REVISED -			•	•	MONTGOMERY	80	37
PLOT DATE = Aug-25-2011 10:16:01AM	DATE = 06-15-11	REVISED -	REVISED -	SCALE:	SHEET NO. 2 OF 5 SHEETS	STA.	TO STA.	CONTRACT NO. 72D67		
						FED. ROAD DIST. NO. ILLINOIS FED. AID PROJECT				

325, 42
 (15, 21)RS-7, 22RS-4, 24RS-8