

NOTES:
 THE PROPOSED PAVEMENT STRIPING IS NOT SHOWN ON THIS PLAN SHEET. SEE PAVEMENT MARKING SHEETS AND SCHEDULES FOR PROPOSED STRIPING LOCATIONS.

TOTAL PARKING LANE AREA ALONG THE SOUTH SIDE OF IL RTE. 16, BETWEEN STATE ST. AND MONROE ST. = 327 SQ. YD.

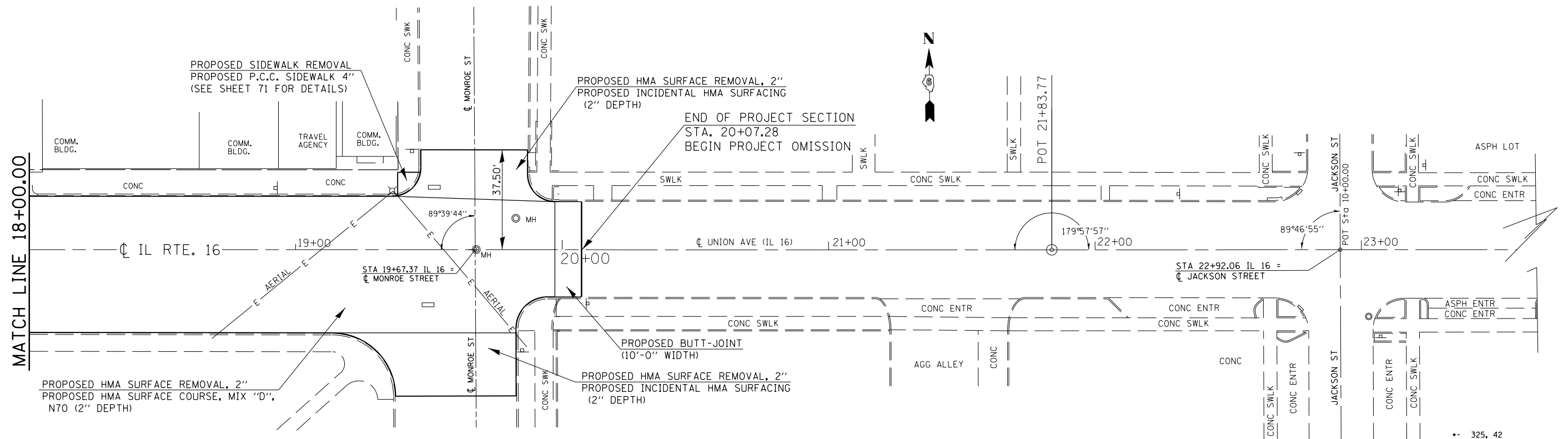

FILE NAME =	USER NAME = sparksgw	DESIGNED - RTS	REVISED -
et:\pw\work\p1dot\sparksgw\10222005\0672067-sht-plan.dgn		DRAWN - RTS	REVISED -
	PLOT SCALE = 40.0000' / in.	CHECKED -	REVISED -
	PLOT DATE = Aug-25-2011 10:16:02AM	DATE - 06-15-11	REVISED -

**STATE OF ILLINOIS
 DEPARTMENT OF TRANSPORTATION**

**PLAN SHEET
 (LITCHFIELD)**

SCALE: SHEET NO. 5 OF 5 SHEETS STA. TO STA.

F.A.P. RTE.	SECTION	COUNTY	TOTAL SHEETS	SHEET NO.
•	••	MONTGOMERY	80	40
FED. ROAD DIST. NO. ILLINOIS FED. AID PROJECT			CONTRACT NO. 72D67	

•• 325, 42
 •• (15, 21)RS-7, 22RS-4, 24RS-8