

PAVEMENT MARKING LEGEND

- ① PREFORMED PLASTIC PAVEMENT MARKING, TYPE B, INLAID - LINE 5"
- ② PREFORMED PLASTIC PAVEMENT MARKING, TYPE B, INLAID - LINE 6"
- ③ PREFORMED PLASTIC PAVEMENT MARKING, TYPE B, INLAID - LINE 6" (6' SKIP- 2' DASH)
- ④ PREFORMED PLASTIC PAVEMENT MARKING, TYPE B, INLAID - LINE 24"
- ⑤ THERMOPLASTIC PAVEMENT MARKING - LINE 5"
- ⑥ THERMOPLASTIC PAVEMENT MARKING - LINE 5" (DOUBLE YELLOW LINES @ 13" CENTERS)
- ⑦ THERMOPLASTIC PAVEMENT MARKING - LINE 6"
- ⑧ THERMOPLASTIC PAVEMENT MARKING - LINE 8"
- ⑨ THERMOPLASTIC PAVEMENT MARKING - LINE 12"
- ⑩ PAINT PAVEMENT MARKING - LINE 5"
- ↖ PREFORMED PLASTIC PAVEMENT MARKING, TYPE B, INLAID - LETTERS AND SYMBOLS (WHITE)
- ▶ RAISED REFLECTIVE PAVEMENT MARKER (ONE-WAY CRYSTAL)
- ▼ RAISED REFLECTIVE PAVEMENT MARKER (ONE -WAY AMBER)
- ◆ RAISED REFLECTIVE PAVEMENT MARKER (TWO -WAY AMBER)
- ⊗-W PAVEMENT MARKING, WHITE
- ⊗-Y PAVEMENT MARKING, YELLOW

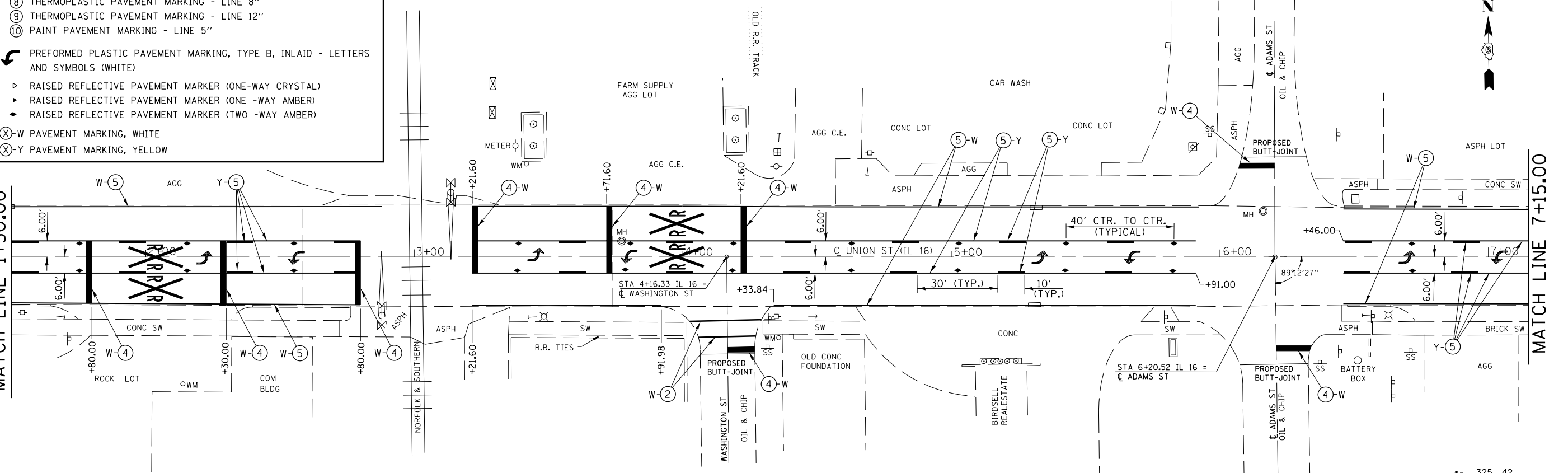

W10-2 (36"X36")
PLACE SIGN 100' IN
ADVANCE OF STOP BAR
ON CLINTON AVE.
ONE SIGN PANEL - 9 SO FT
ONE TELESCOPING SUPPORT - 12 FT

STATION EQUATION:
STA. 942+12.70 (BK) =
STA. 0+00.00 (AHD)

W10-2 (36"X36")
PLACE SIGN 100' IN
ADVANCE OF STOP BAR
ON CLINTON AVE.
ONE SIGN PANEL - 9 SO FT
ONE TELESCOPING SUPPORT - 12 FT

ALL RAILROAD CROSS-BUCK
FEATURES ARE TO BE PREFORMED
PLASTIC AND INLAID. (TYPICAL)

325, 42
15, 21RS-7, 22RS-4, 24RS-8

FILE NAME =	USER NAME = sparksgw	DESIGNED - RTS	REVISED -
ei:\pw\work\p\midot\sparksgw\10222005\0672067-sht-pmk.dgn		DRAWN - RTS	REVISED -
	PLOT SCALE = 40.0000' / in.	CHECKED - RTS	REVISED -
	PLOT DATE = Aug-25-2011 10:16:13AM	DATE - 06-16-11	REVISED -

**STATE OF ILLINOIS
DEPARTMENT OF TRANSPORTATION**

PAVEMENT MARKING LAYOUT (LITCHFIELD)	
SCALE:	SHEET NO. 3 OF 5 SHEETS
STA.	TO STA.

F.A.P. RTE.	SECTION	COUNTY	TOTAL SHEETS	SHEET NO.
.	..	MONTGOMERY	80	58
CONTRACT NO. 72D67			FED. ROAD DIST. NO. ILLINOIS FED. AID PROJECT	