

PAVEMENT MARKING LEGEND	
① PREFORMED PLASTIC PAVEMENT MARKING, TYPE B, INLAID - LINE 5"	↶ PREFORMED PLASTIC PAVEMENT MARKING, TYPE B, INLAID - LETTERS AND SYMBOLS (WHITE)
② PREFORMED PLASTIC PAVEMENT MARKING, TYPE B, INLAID - LINE 6"	▷ RAISED REFLECTIVE PAVEMENT MARKER (ONE-WAY CRYSTAL)
③ PREFORMED PLASTIC PAVEMENT MARKING, TYPE B, INLAID - LINE 6" (6' SKIP - 2' DASH)	▷ RAISED REFLECTIVE PAVEMENT MARKER (ONE-WAY AMBER)
④ PREFORMED PLASTIC PAVEMENT MARKING, TYPE B, INLAID - LINE 24"	◆ RAISED REFLECTIVE PAVEMENT MARKER (TWO-WAY AMBER)
⑤ THERMOPLASTIC PAVEMENT MARKING - LINE 5"	⊗-W PAVEMENT MARKING, WHITE
⑥ THERMOPLASTIC PAVEMENT MARKING - LINE 5" (DOUBLE YELLOW LINES @ 13" CENTERS)	⊗-Y PAVEMENT MARKING, YELLOW
⑦ THERMOPLASTIC PAVEMENT MARKING - LINE 6"	
⑧ THERMOPLASTIC PAVEMENT MARKING - LINE 8"	
⑨ THERMOPLASTIC PAVEMENT MARKING - LINE 12"	
⑩ PAINT PAVEMENT MARKING - LINE 5"	

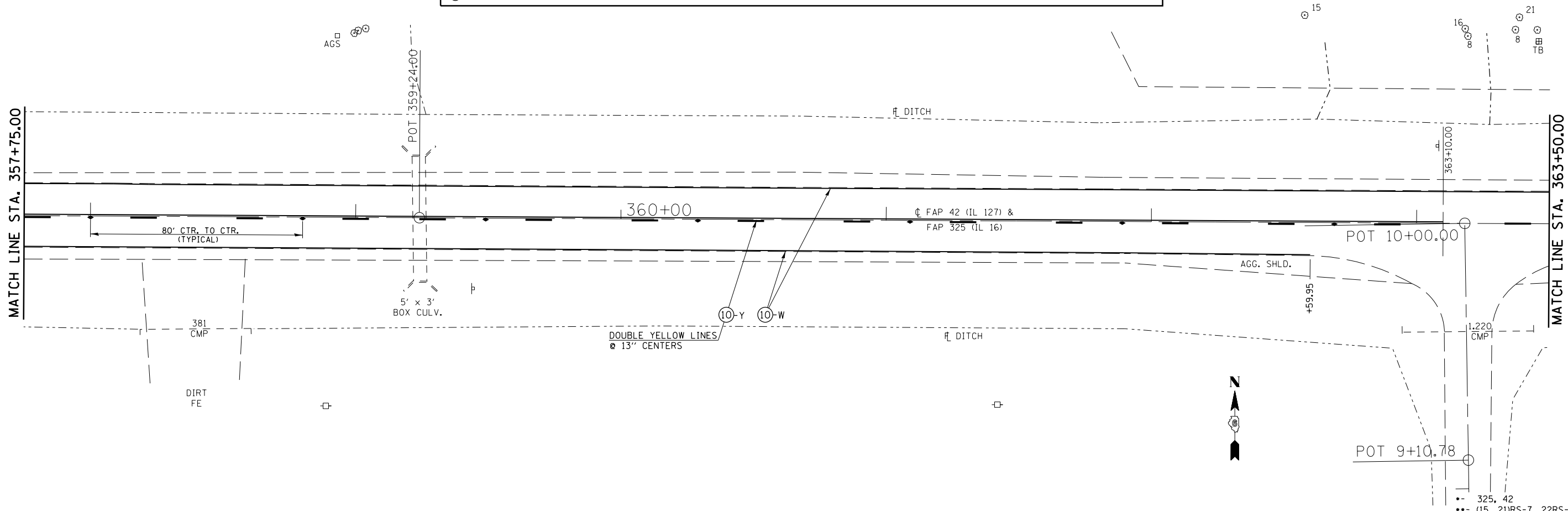

FILE NAME =	USER NAME = sparksgw	DESIGNED - RTS	REVISED -	<b>STATE OF ILLINOIS DEPARTMENT OF TRANSPORTATION</b>	<b>PAVEMENT MARKING LAYOUT (IL 16 /IL 127 INTERSECTION)</b>		F.A.P. RTE.	SECTION	COUNTY	TOTAL SHEETS	SHEET NO.	
et:\pw\work\p\idot\sparksgw\10222005\0672067-sht-pmk.dgn		DRAWN - RTS	REVISED -		SCALE:	SHEET NO. 3 OF 4 SHEETS	STA.	TO STA.	•	••	MONTGOMERY	80 63
	PLOT SCALE = 40.0000' / in.	CHECKED - RTS	REVISED -						••	••	CONTRACT NO. 72D67	
	PLOT DATE = Aug-25-2011 10:16:15AM	DATE - 06-16-11	REVISED -						FED. ROAD DIST. NO.	ILLINOIS FED. AID PROJECT		