

EXIST. CURVE 2202
 PI STA. = 376+48.19
 $\Delta = 35^\circ 37' 52''$ (RT)
 $D = 2^\circ 29' 59''$
 $R = 2,291.97'$
 $T = 736.56'$
 $L = 1,425.33'$
 $E = 115.44'$
 $e = 5.05\%$
 $T.R. = 39.96'$
 $S.E. RUN = 1,335.65'$
 $P.C. STA. = 369+11.63$
 $P.T. STA. = 383+36.96$

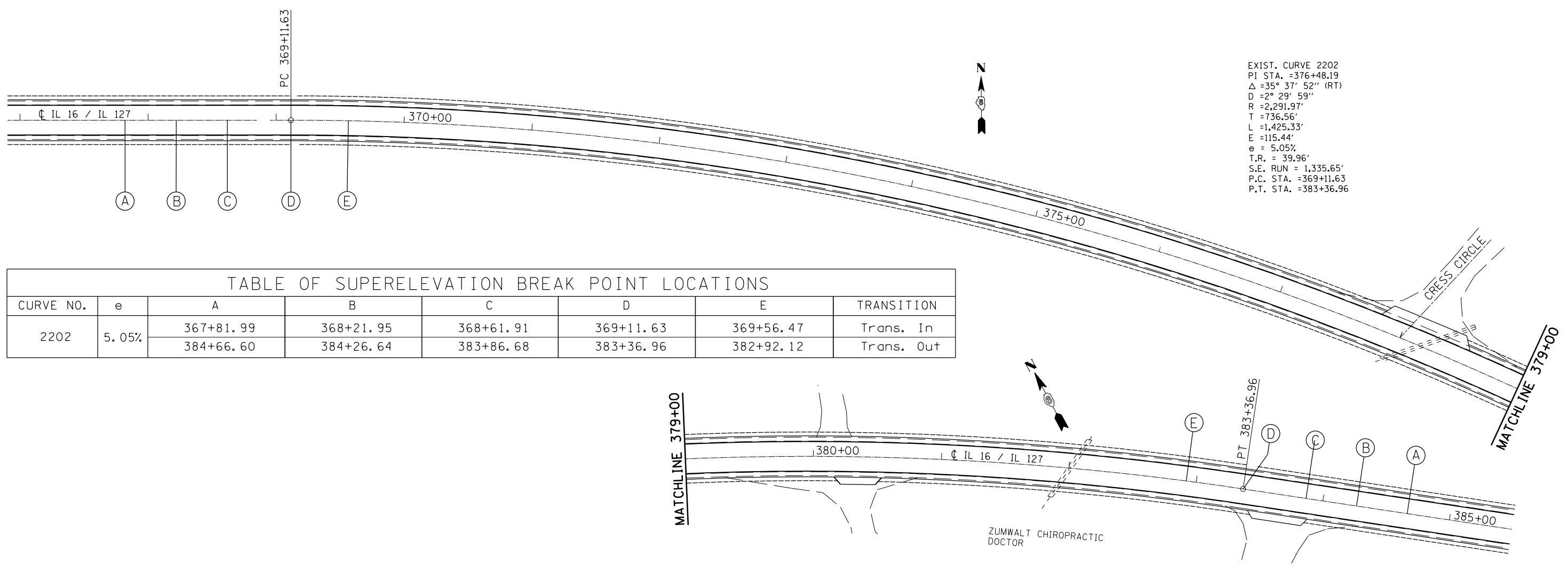

CURVE NO.	e	A	B	C	D	E	TRANSITION
2202	5.05%	367+81.99	368+21.95	368+61.91	369+11.63	369+56.47	Trans. In
		384+66.60	384+26.64	383+86.68	383+36.96	382+92.12	Trans. Out

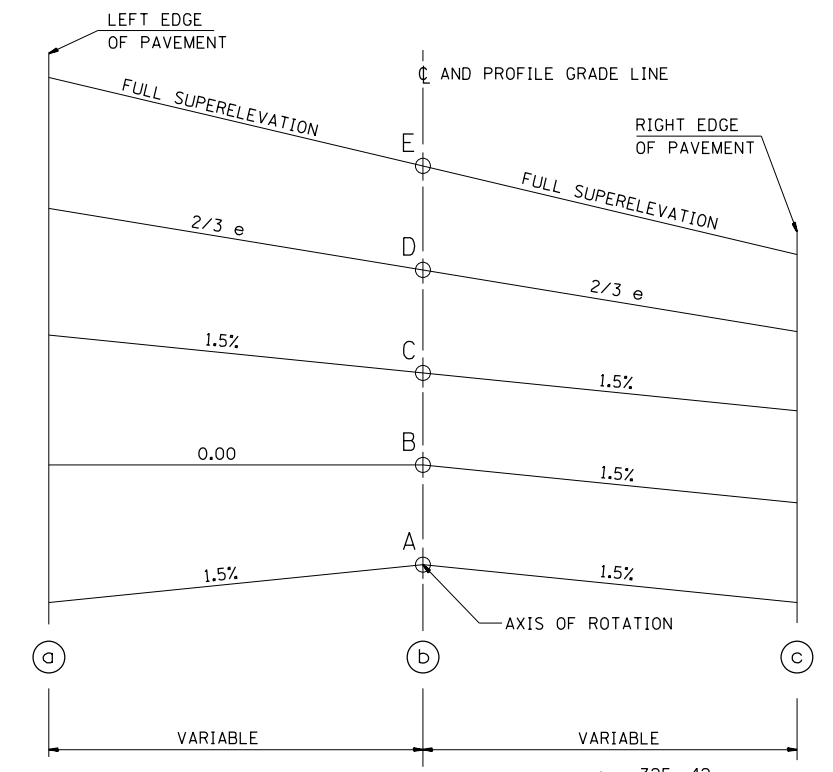
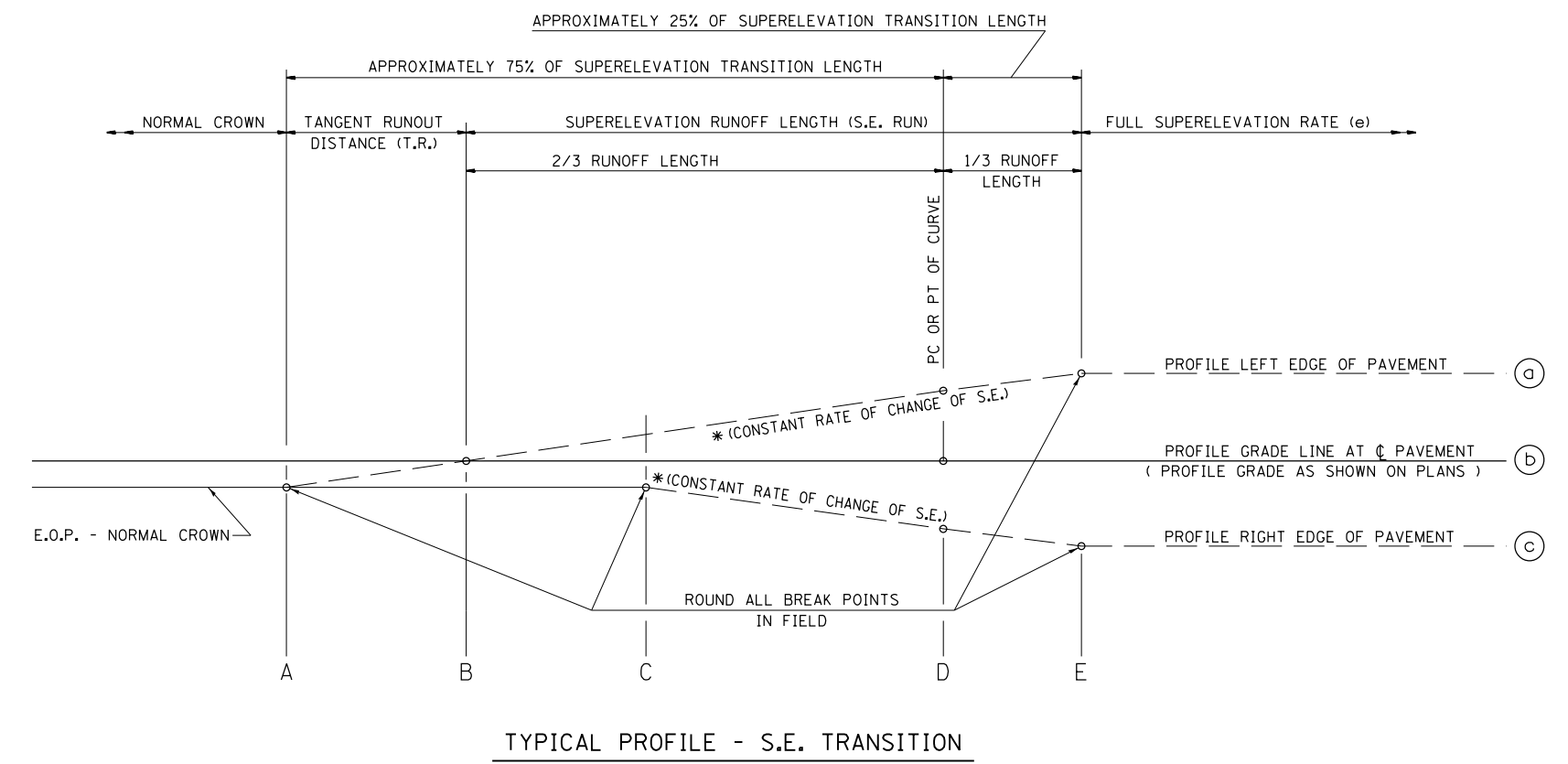

•- 325, 42
 ••- (15, 21)RS-7, 22RS-4, 24RS-8

FILE NAME =	USER NAME = sparksgw	DESIGNED - RTS	REVISED -
et:\pw\work\p\idot\sparksgw\10222005\0672067-sht-details.dgn		DRAWN - RTS	REVISED -
	PLOT SCALE = 200.0000' / in.	CHECKED -	REVISED -
	PLOT DATE = Aug-25-2011 10:16:21AM	DATE - 06-16-11	REVISED -

STATE OF ILLINOIS
 DEPARTMENT OF TRANSPORTATION

SUPERELEVATION DETAILS

SCALE: SHEET NO. 3 OF 3 SHEETS STA. TO STA.

F.A.P. RTE.	SECTION	COUNTY	TOTAL SHEETS	SHEET NO.
•	••	MONTGOMERY	80	69
CONTRACT NO.				
FED. ROAD DIST. NO. ILLINOIS FED. AID PROJECT				