

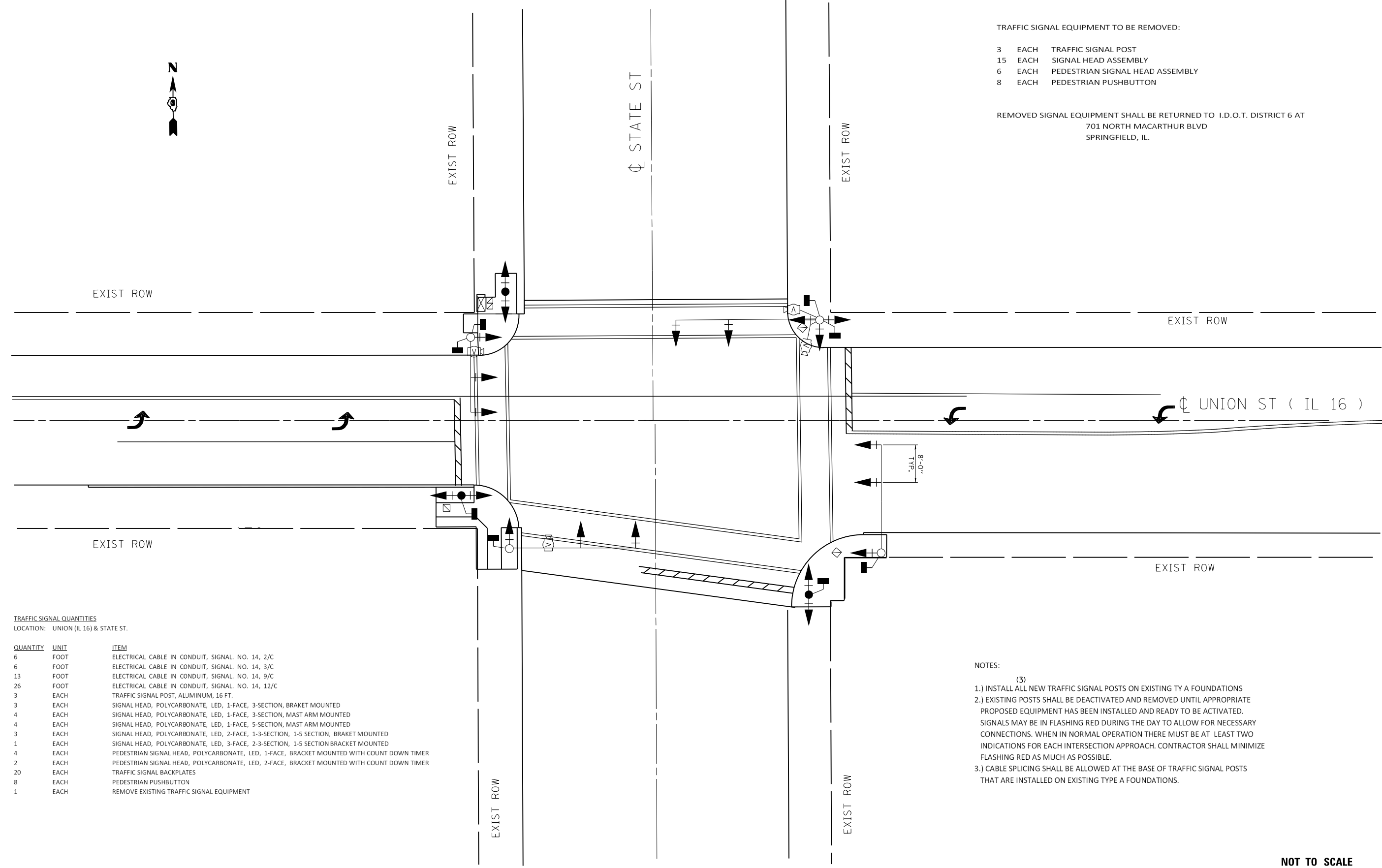

TRAFFIC SIGNAL EQUIPMENT TO BE REMOVED:

- 3 EACH TRAFFIC SIGNAL POST
- 15 EACH SIGNAL HEAD ASSEMBLY
- 6 EACH PEDESTRIAN SIGNAL HEAD ASSEMBLY
- 8 EACH PEDESTRIAN PUSHBUTTON

REMOVED SIGNAL EQUIPMENT SHALL BE RETURNED TO I.D.O.T. DISTRICT 6 AT
701 NORTH MACARTHUR BLVD
SPRINGFIELD, IL.



TRAFFIC SIGNAL QUANTITIES
LOCATION: UNION (IL 16) & STATE ST.

QUANTITY	UNIT	ITEM
6	FOOT	ELECTRICAL CABLE IN CONDUIT, SIGNAL NO. 14, 2/C
6	FOOT	ELECTRICAL CABLE IN CONDUIT, SIGNAL NO. 14, 3/C
13	FOOT	ELECTRICAL CABLE IN CONDUIT, SIGNAL NO. 14, 9/C
26	FOOT	ELECTRICAL CABLE IN CONDUIT, SIGNAL NO. 14, 12/C
3	EACH	TRAFFIC SIGNAL POST, ALUMINUM, 16 FT.
3	EACH	SIGNAL HEAD, POLYCARBONATE, LED, 1-FACE, 3-SECTION, BRACKET MOUNTED
4	EACH	SIGNAL HEAD, POLYCARBONATE, LED, 1-FACE, 3-SECTION, MAST ARM MOUNTED
4	EACH	SIGNAL HEAD, POLYCARBONATE, LED, 1-FACE, 5-SECTION, MAST ARM MOUNTED
3	EACH	SIGNAL HEAD, POLYCARBONATE, LED, 2-FACE, 1-3-SECTION, 1-5 SECTION, BRACKET MOUNTED
1	EACH	SIGNAL HEAD, POLYCARBONATE, LED, 3-FACE, 2-3-SECTION, 1-5 SECTION BRACKET MOUNTED
4	EACH	PEDESTRIAN SIGNAL HEAD, POLYCARBONATE, LED, 1-FACE, BRACKET MOUNTED WITH COUNT DOWN TIMER
2	EACH	PEDESTRIAN SIGNAL HEAD, POLYCARBONATE, LED, 2-FACE, BRACKET MOUNTED WITH COUNT DOWN TIMER
20	EACH	TRAFFIC SIGNAL BACKPLATES
8	EACH	PEDESTRIAN PUSHBUTTON
1	EACH	REMOVE EXISTING TRAFFIC SIGNAL EQUIPMENT

NOTES:

- (3)
- 1.) INSTALL ALL NEW TRAFFIC SIGNAL POSTS ON EXISTING TYPE A FOUNDATIONS
- 2.) EXISTING POSTS SHALL BE DEACTIVATED AND REMOVED UNTIL APPROPRIATE PROPOSED EQUIPMENT HAS BEEN INSTALLED AND READY TO BE ACTIVATED. SIGNALS MAY BE IN FLASHING RED DURING THE DAY TO ALLOW FOR NECESSARY CONNECTIONS. WHEN IN NORMAL OPERATION THERE MUST BE AT LEAST TWO INDICATIONS FOR EACH INTERSECTION APPROACH. CONTRACTOR SHALL MINIMIZE FLASHING RED AS MUCH AS POSSIBLE.
- 3.) CABLE SPLICING SHALL BE ALLOWED AT THE BASE OF TRAFFIC SIGNAL POSTS THAT ARE INSTALLED ON EXISTING TYPE A FOUNDATIONS.

NOT TO SCALE

- 325, 42
- (15, 21)RS-7, 22RS-4, 24RS-8

FILE NAME =	USER NAME = sparksgw	DESIGNED - SEC	REVISED -	STATE OF ILLINOIS DEPARTMENT OF TRANSPORTATION	PROPOSED TRAFFIC SIGNALS			F.A.P. RTE.	SECTION	COUNTY	TOTAL SHEETS	SHEET NO.
ei:\pw\work\p\dot\sparksgw\10222005\0672067-sh-t-ts.dgn		DRAWN - SEC	REVISED -		•	••	MONTGOMERY	80	77			
PLOT SCALE = 200.0000' / in.		CHECKED -	REVISED -		CONTRACT NO. 72D67							
PLOT DATE = Aug-25-2011 10:16:30AM		DATE - 07-19-11	REVISED -		SCALE:	SHEET NO. 4 OF 7 SHEETS	STA.	TO STA.	FED. ROAD DIST. NO.	ILLINOIS FED. AID PROJECT		