

PROP. CURVE XNB03
 PI STA. = 147+18.67
 $\Delta = 10^\circ 22' 02''$ (RT)
 D = 3° 07' 21"
 R = 1,835.00'
 T = 166.47'
 L = 332.03'
 E = 7.54'
 e = -----
 T.R. = -----
 S.E. RUN = -----
 P.C. STA. = 145+52.20
 P.T. STA. = 148+84.23

PROP. CURVE XNB04
 PI STA. = 152+51.23
 $\Delta = 10^\circ 22' 02''$ (LT)
 D = 3° 07' 21"
 R = 1,835.00'
 T = 166.47'
 L = 332.03'
 E = 7.54'
 e = -----
 T.R. = -----
 S.E. RUN = -----
 P.C. STA. = 150+84.76
 P.T. STA. = 154+16.79

PROP. CURVE XSB03
 PI STA. = 247+14.22
 $\Delta = 10^\circ 23' 13''$ (LT)
 D = 3° 07' 21"
 R = 1,835.00'
 T = 166.79'
 L = 332.66'
 E = 7.56'
 e = -----
 T.R. = -----
 S.E. RUN = -----
 P.C. STA. = 245+47.43
 P.T. STA. = 248+80.10

PROP. CURVE XSB04
 PI STA. = 252+45.77
 $\Delta = 10^\circ 23' 13''$ (RT)
 D = 3° 07' 21"
 R = 1,835.00'
 T = 166.79'
 L = 332.66'
 E = 7.56'
 e = -----
 T.R. = -----
 S.E. RUN = -----
 P.C. STA. = 250+78.98
 P.T. STA. = 254+11.64

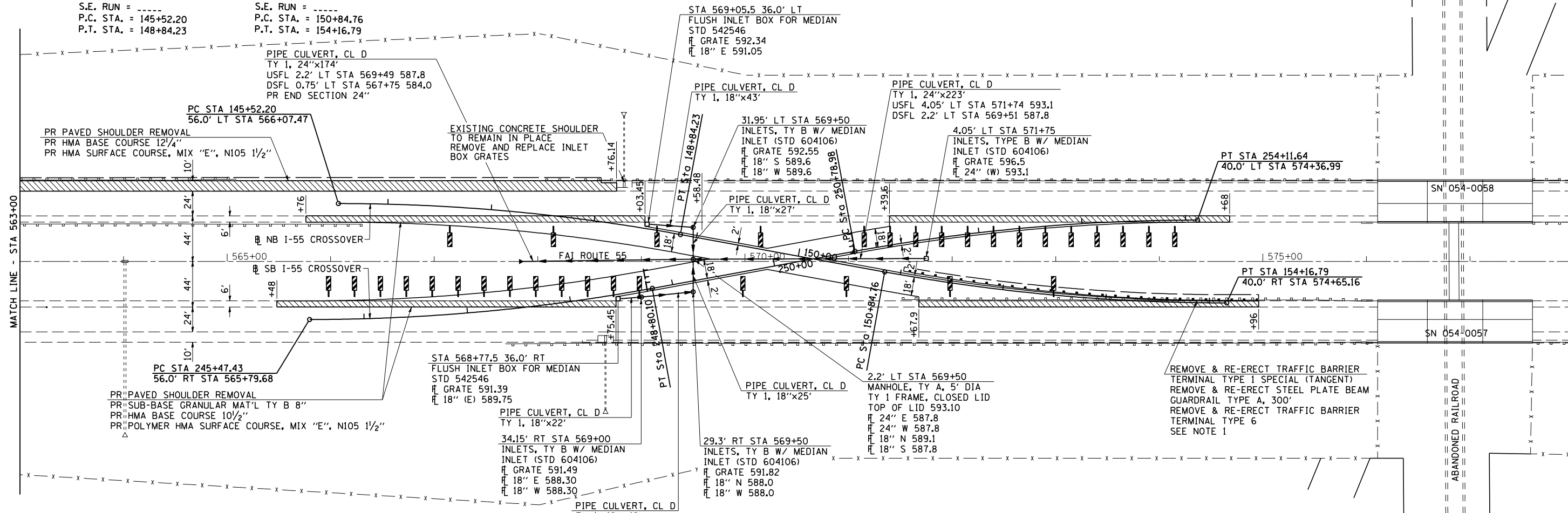

REMOVE & RE-ERECT TRAFFIC BARRIER
 TERMINAL TYPE 1 SPECIAL (TANGENT)
 REMOVE & RE-ERECT STEEL PLATE BEAM
 GUARDRAIL TYPE A, 300'
 REMOVE & RE-ERECT TRAFFIC BARRIER
 TERMINAL TYPE 6
 SEE NOTE 1

NOTE 1: ERECT GUARDRAIL AND TERMINALS
 WITH FACE OF RAIL 6'-0" FROM NB
 CROSSOVER



JOB = 2236.09	DESIGNED - NAK	REVISED -
FILE NAME = D672E10-shr-xoprestl.dgn	DRAWN - TJD	REVISED -
PLOT SCALE = 100.00000' / IN.	CHECKED - NAK	REVISED -
PLOT DATE = 9/8/2011	DATE - 8/12/2011	REVISED -

STATE OF ILLINOIS
 DEPARTMENT OF TRANSPORTATION

PRE-STAGE 1
 CROSSOVER PLAN

SCALE: SHEET NO. OF SHEETS STA. 563+00 TO STA. 578+00

F.A.I. RTE.	SECTION	COUNTY	TOTAL SHEETS	SHEET NO.
55	D6 LOGAN CO BR 2011	LOGAN	224	60
CONTRACT NO. 72E10				
FED. ROAD DIST. NO. ILLINOIS FED. AID PROJECT				