

NOTES:

TRAFFIC CONTROL DEVICES SHALL BE INSTALLED DURING PRE-STAGE 1 CONSTRUCTION AND SHALL REMAIN IN PLACE THROUGHOUT CONSTRUCTION OF THE PROJECT. TRAFFIC CONTROL DEVICES SHALL BE REMOVED AS REQUIRED TO OPEN THE STAGE 1 AND STAGE 2 CROSSOVER LANES.

TRAFFIC CONTROL DEVICES AT THE EAST CROSSOVER SHALL REMAIN IN PLACE AND BECOME THE PROPERTY OF THE DEPARTMENT UPON COMPLETION OF THE PROJECT.

NOTE: FOR INSTALLATION OF VERTICAL PANELS IN AREAS OF CROSSOVER PAVEMENT, 3" Ø HOLES WILL BE CORED THROUGH PAVEMENT FOR PLACEMENT. TELESCOPING STEEL POLES WILL BE PLACED 1" BELOW SURFACE AS SHOWN, AND WORK SHALL BE DONE TO THE SATISFACTION OF THE ENGINEER. WHEN OPENING CROSSOVER, PANELS WILL BE REMOVED AND HOLES WILL BE LEFT IN PLACE. COST OF PANELS, POSTS, SLEEVES, TYPE III BARRICADES, SIGNS, AND CORING SHALL BE INCLUDED IN MEDIAN CLOSURE.

BILL OF MATERIALS

LOCATION	VERTICAL PANELS	TELESCOPING STEEL POSTS & STEEL SLEEVES	TYPE III BARRICADES	SIGN PANEL TYPE 2
STA	STA	EACH	EACH	SQ FT
SB I-55				
524+20	TO 527+20	4	4	
258+20	TO 531+20	13	13	
528+08			2	10
567+15	TO 570+15	4	4	
571+15	TO 574+15	13	13	
571+03			2	10
NB I-55				
523+00	TO 526+00	13	13	
527+00	TO 530+00	4	4	
525+93			2	10
565+98	TO 568+98	13	13	
569+98	TO 572+98	4	4	
569+06			2	10
TOTAL		68	68	40

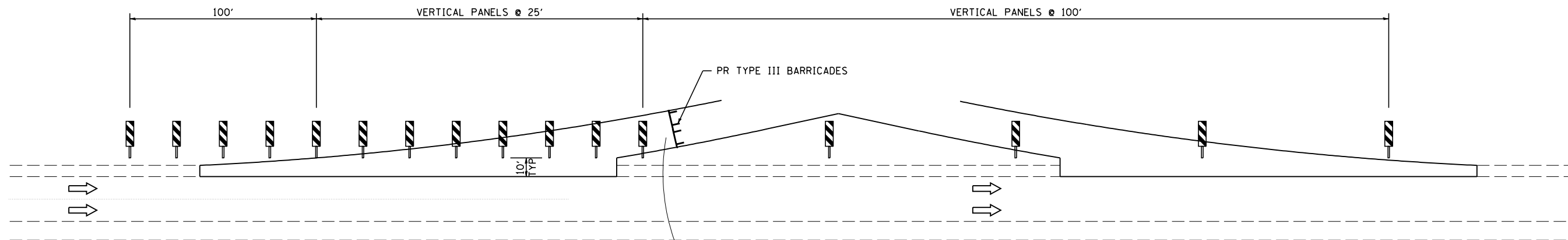

LEGEND

- ← TRAFFIC FLOW ARROW
- ⊥ TYPE III BARRICADE
- ▬ IMPACT ATTENUATOR
- BARREL W/STEADY BURNING LIGHT
- ⊥ POST MOUNTED SIGN
- ◇ BARRIER WALL MARKER
- ▬ TEMPORARY CONCRETE BARRIER
- ⊥ VERTICAL SIGN PANEL

CROSSOVER CLOSURE-TYPICAL
4 LOCATIONS

NOT TO SCALE



JOB = 2236.9	DESIGNED - NAK	REVISED -
FILE NAME = d672E10-sht-details.dgn	DRAWN - TJD	REVISED -
PLOT SCALE = 2.0000' / IN.	CHECKED - NAK	REVISED -
PLOT DATE = 9/8/2011	DATE - 8/12/2011	REVISED -

STATE OF ILLINOIS
DEPARTMENT OF TRANSPORTATION

MAINTENANCE OF TRAFFIC PLAN
CROSSOVER CLOSURE DETAIL

SCALE: SHEET NO. OF SHEETS STA. TO STA.

F.A.I. RTE.	SECTION	COUNTY	TOTAL SHEETS	SHEET NO.
55	D6 LOGAN CO BR 2011	LOGAN	224	90
FED. ROAD DIST. NO.			ILLINOIS FED. AID PROJECT	

CONTRACT NO. 72E10