

EXISTING TYPICAL CROSS SECTION THRU DECK
(Looking North)

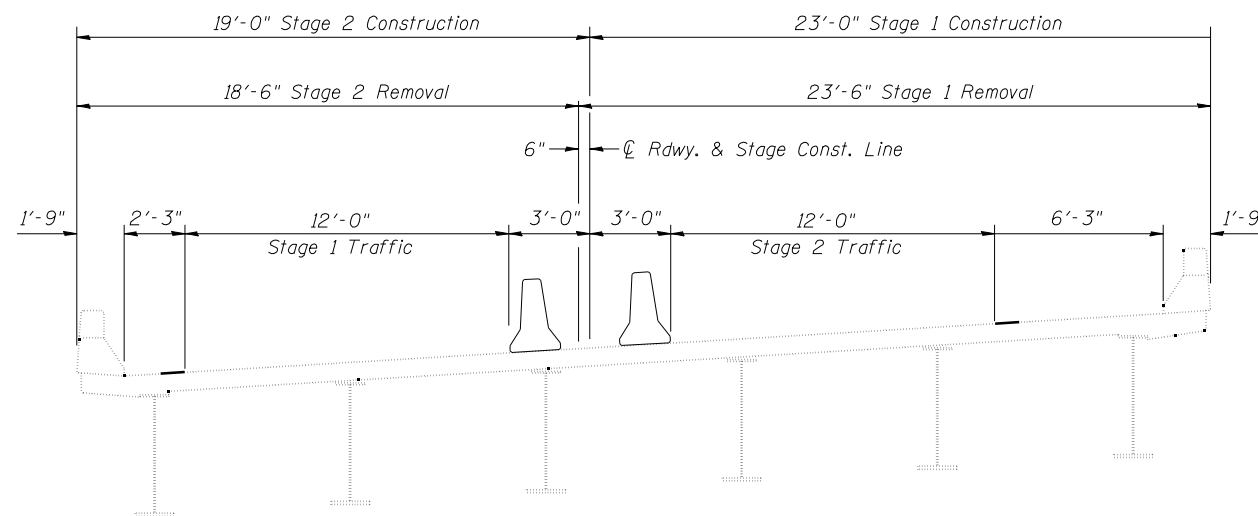

STAGE 1 & STAGE 2 CONSTRUCTION
(Looking North)

Note:
All dimensions are radial.

GENERAL NOTES

Reinforcement bars shall conform to the requirements of ASTM A 706 Gr 60.

Reinforcement bars designated (E) shall be epoxy coated.

Plan dimensions and details relative to existing plans are subject to nominal construction variations. The Contractor shall field verify existing dimensions and details affecting new construction and make necessary approved adjustments prior to construction or ordering of materials. Such variations shall not be cause for additional compensation for a change in scope of the work, however, the Contractor will be paid for the quantity actually furnished at the unit price bid for the work.

TOTAL BILL OF MATERIAL

ITEM	UNIT	TOTAL
Concrete Removal	Cu. Yd.	14.6
Concrete Superstructure	Cu. Yd.	14.3
Reinforcement Bars, Epoxy Coated	Pound	3510
Protective Coat	Sq. Yd.	56
Bar Splicers	Each	36
Floor Drain Extensions	Each	3
Polymer Concrete	Cu. Ft.	7.7
Preformed Joint Strip Seal	Foot	106