

Notes:  
See sheet 22 of 39 for Sections C-C & D-D and View E-E.  
a<sub>4</sub>(E) and a<sub>5</sub>(E) bar spacings measured along  $\phi$  Rdwy.

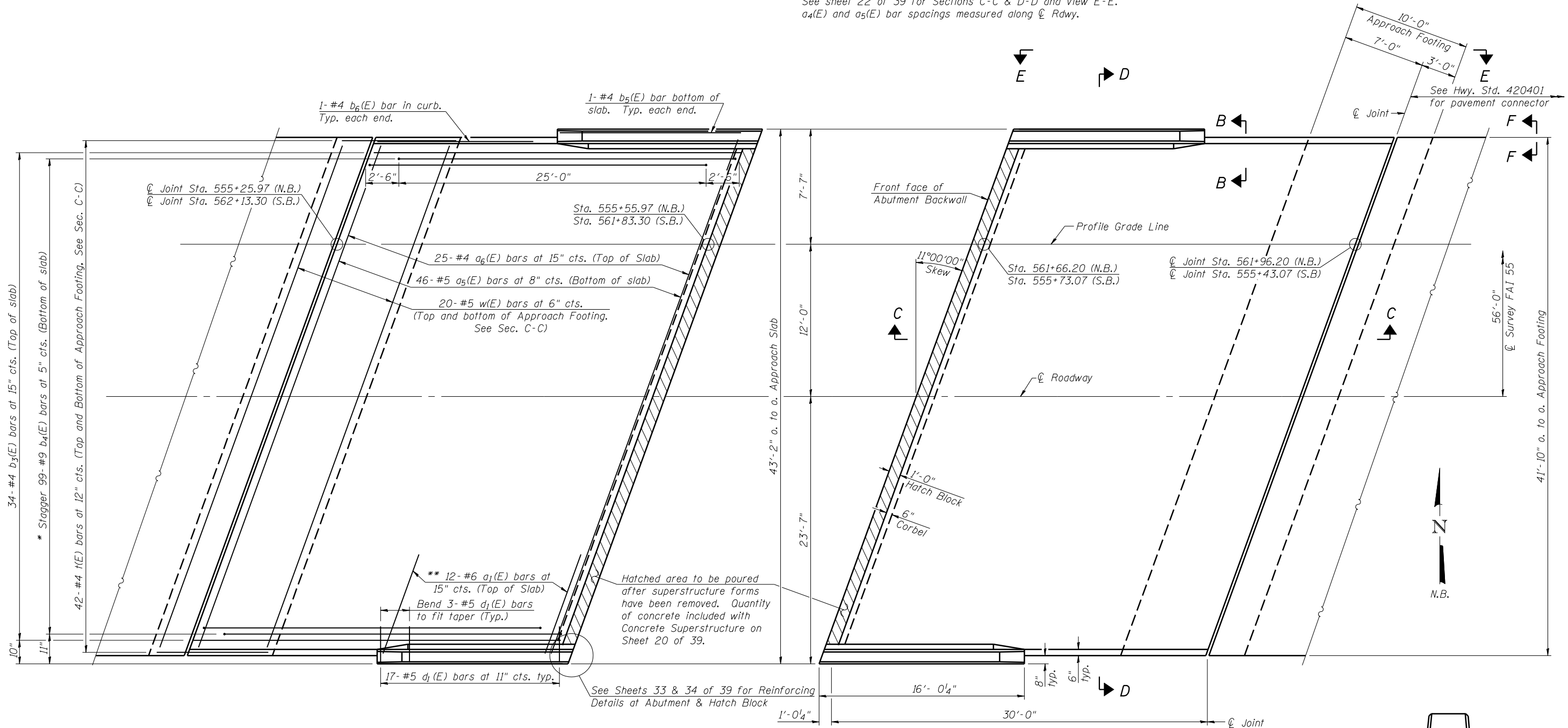

**WEST APPROACH PLAN**

**SHOWING REINFORCEMENT**

(S.N. 054-0055 shown - S.N. 054-0056 similar by rotation of 180°)

- \* Tilt #9 b<sub>4</sub>(E) bars as required to maintain clearance.
- \*\* Space between a<sub>4</sub>(E) bars, typ. each parapet.
- \*\*\*\* Prior to Grinding, Max 1/4"

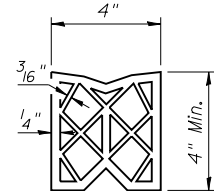

**PREFORMED JOINT SEAL**

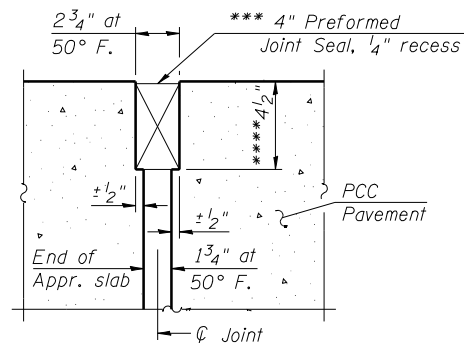

**DETAIL A**

\*\*\* Cost included with Concrete Superstructure.

**EAST APPROACH PLAN**

**SHOWING DIMENSIONS**

(S.N. 054-0055 shown - S.N. 054-0056 similar by rotation of 180°)

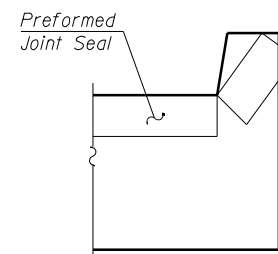

**VIEW F-F**

Angle Preformed Joint Seal at 45° at curbs when req'd for drainage.

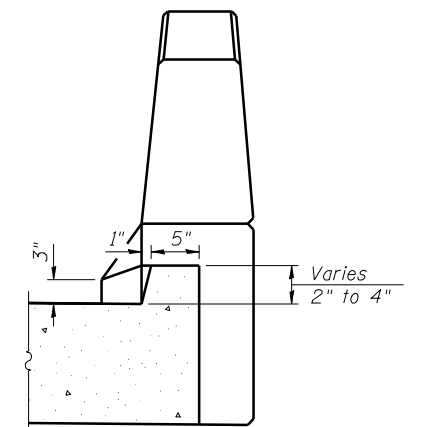

**VIEW B-B**

(Sheet 1 of 2)