

**EXISTING BEARING SEAT ELEVATIONS
S.N. 054-0055 (NB)**

	G	H	I	J	K	L
West Abutment	568.95	569.09	569.20	569.14	569.02	568.88
East Abutment	569.34	569.47	569.57	569.50	569.37	569.21

**PROPOSED BEARING SEAT ELEVATIONS
S.N. 054-0055 (NB)**

	G	H	I	J	K	L
West Abutment	570.41	570.55	570.67	570.61	570.49	570.35
East Abutment	570.81	570.93	571.04	570.96	570.84	570.68

**EXISTING BEARING SEAT ELEVATIONS
S.N. 054-0056 (SB)**

	A	B	C	D	E	F
West Abutment	568.87	569.03	569.14	569.20	569.09	568.95
East Abutment	569.43	569.57	569.68	569.73	569.61	569.46

**PROPOSED BEARING SEAT ELEVATIONS
S.N. 054-0056 (SB)**

	A	B	C	D	E	F
West Abutment	570.26	570.41	570.53	570.60	570.49	570.36
East Abutment	571.18	571.32	571.42	571.47	571.34	571.19

**BEARING SEAT HEIGHTS
S.N. 054-0055 (NB)**

	Beam G	Beam H	Beam I	Beam J	Beam K	Beam L
West Abut.	1'-5 1/2"	1'-5 5/8"	1'-5 5/8"	1'-5 5/8"	1'-5 5/8"	1'-5 5/8"
East Abut.	1'-5 5/8"	1'-5 5/8"	1'-5 5/8"	1'-5 5/8"	1'-5 5/8"	1'-5 5/8"

**BEARING SEAT HEIGHTS
S.N. 054-0056 (SB)**

	Beam A	Beam B	Beam C	Beam D	Beam E	Beam F
West Abut.	1'-4 5/8"	1'-4 1/2"	1'-4 5/8"	1'-4 3/4"	1'-4 3/4"	1'-4 7/8"
East Abut.	1'-9"	1'-9 1/8"	1'-8 7/8"	1'-8 1/8"	1'-8 3/4"	1'-8 3/4"

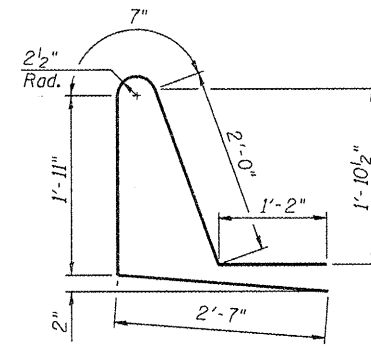

BAR d1(E)

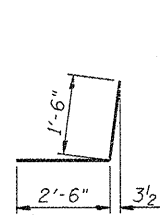

BAR h2(E)

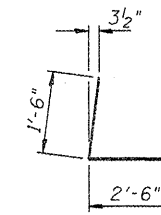

BAR h3(E)

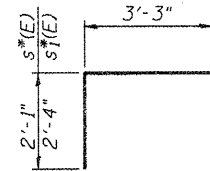

BAR s*(E) & s†(E)

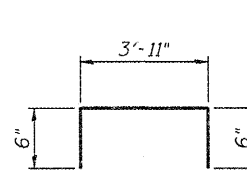

BAR s2(E)

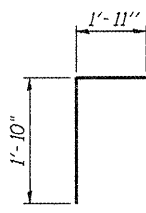

BAR v(E)

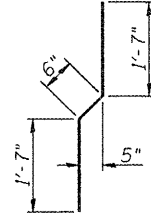

BAR v1(E)

**FOUR (4) ABUTMENTS
BILL OF MATERIAL**

Bar	No.	Size	Length	Shape
d1(E)	16	#5	8'-3"	L
h(E)	24	#5	40'-3"	—
h1(E)	20	#6	43'-7"	—
h2(E)	16	#5	4'-0"	J
h3(E)	16	#5	4'-0"	L
h4(E)	24	#5	42'-1"	—
h5(E)	16	#5	7'-0"	—
h6(E)	32	#5	11'-8"	—
s*(E)	258	#5	5'-4"	Γ
s†(E)	86	#5	5'-7"	Γ
s2(E)	32	#5	4'-11"	Γ
v(E)	164	#5	3'-9"	Γ
v1(E)	164	#4	3'-8"	Γ
v2(E)	164	#4	3'-2"	—
v3(E)	164	#4	4'-10"	—
Concrete Structures		Cu. Yd.	50.0	
Reinforcement Bars, Epoxy Coated		Pound	8,170	
Concrete Sealer		Sq. Ft.	1,183	

Notes:

Reinforcement Bars designated (E) shall be epoxy coated.
s*(E) & s†(E) shall be grouted into drilled holes in accordance with Section 584 of the Standard Specifications. Minimum embedment = 9".

All edges of proposed concrete shall have standard 3/4" chamfers unless noted otherwise.

Concrete Sealer shall be applied to the exposed faces of the backwall and top and sides of the new concrete pedestals.

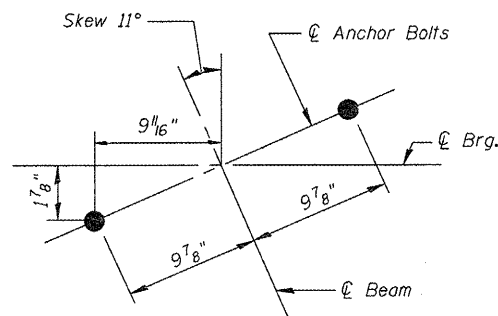

**ANCHOR BOLT LAYOUT
AT ABUTMENTS**

NOTE

Plan elevations relative to the existing structure have been taken from existing plans and reduced by 0.38 feet to match benchmark datum.