

RETAINING WALL TYPICAL SECTION

Notes:

The timber lagging shall conform to Articles 507 and 1007.03 of the Standard Specifications.

The treated timber lagging shall be structural square cut dense Southern Pine or dense Douglas Fir.

The drain shall be placed behind the lagging with the pervious side toward the soil according to Section 591 of the Standard Specifications and shall be centered between the piles. The drain shall be installed in stages as the excavation proceeds downward making sure that drain splices as well as the top side edges are covered as required to protect the drain.

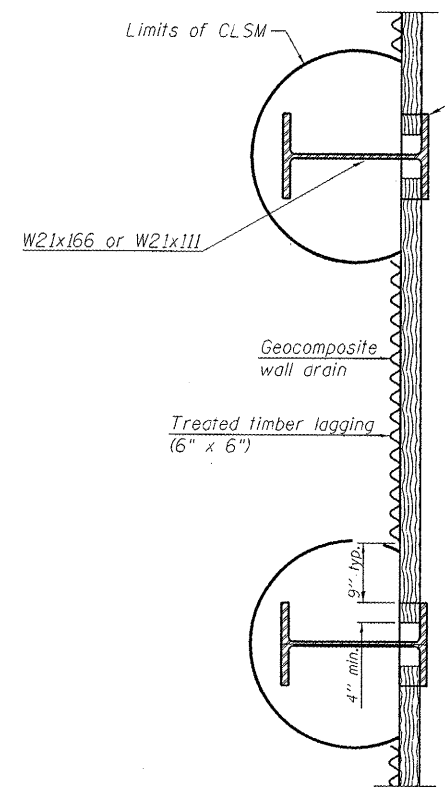

SECTION A-A

**Included in the cost of Furnishing Soldier Piles (W Section).

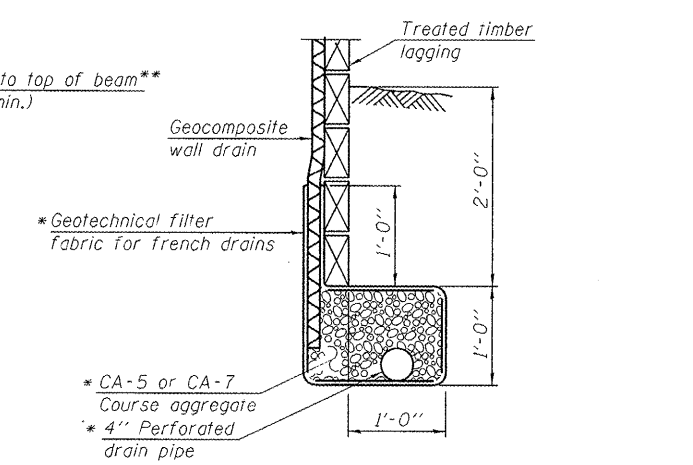

UNDERDRAIN DETAIL BETWEEN SOLDIER PILES

* Included in the cost of Pipe Underdrains for Structures.

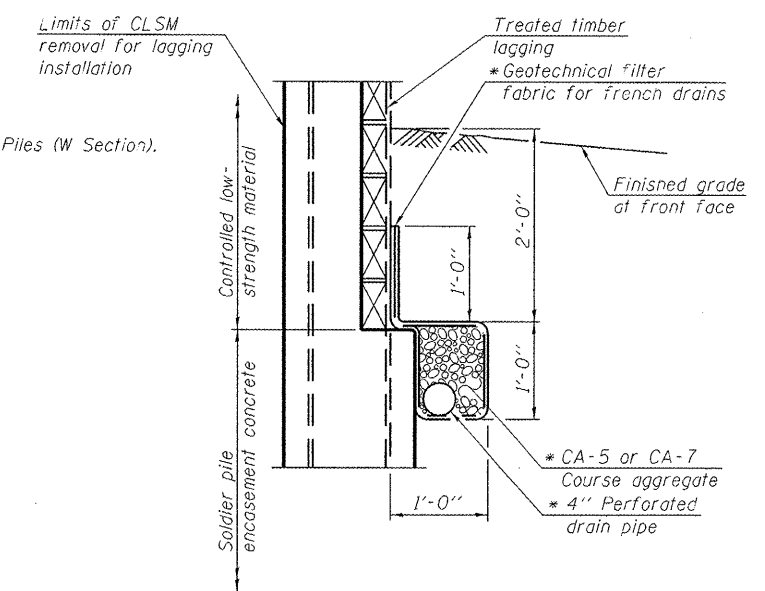

UNDERDRAIN DETAIL AT SOLDIER PILES

* Included in the cost of Pipe Underdrains for Structures.

DESIGNED <i>Greg Heckel, Jay Edwards</i>	EXAMINED _____	DATE - _____
CHECKED <i>Steve V. Beran</i>	ENGINEER OF BRIDGE DESIGN	
DRAWN <i>Jay D. Edwards</i>	PASSED _____	REVISED _____
CHECKED <i>SVB, GBH, JDE</i>	ENGINEER OF BRIDGES AND STRUCTURES	REVISED _____

**STATE OF ILLINOIS
DEPARTMENT OF TRANSPORTATION**

**TYPICAL WALL SECTION
S.N. 085-7900**

SHEET NO. 3 OF 5 SHEETS

F.A.S. R.T.E. 2582	SECTION (45)I-2	COUNTY SCHUYLER	TOTAL SHEETS 18	SHEET NO. 8
CONTRACT NO. 72E37			ILLINOIS FED. AID PROJECT	