

GENERAL NOTES:

1. DURING INSTALLATION OF UNINTERRUPTIBLE POWER SUPPLIES, POWER TO THE TRAFFIC SIGNAL CONTROLLER MAY NEED TO BE SHUT OFF. DURING ANY INTERRUPTION OF POWER, PEDESTAL-MOUNTED STOP SIGNS SHALL BE ERECTED ON EACH APPROACH TO AN INTERSECTION. A MINIMUM OF TWO STOP SIGNS SHALL BE USED ON MULTI-LANE APPROACHES OR AS DIRECTED BY THE ENGINEER.
2. TRAFFIC SIGNALS ALONG IL 4/VETERANS PARKWAY SHALL NOT BE SHUT DOWN BETWEEN THE HOURS OF 6:30 AM TO 8:30 AM, OR 3:30 PM TO 6:30 PM.
3. DURING THE REBUILDING OF TRAFFIC SIGNAL FACES, AT LEAST TWO FACES PER APPROACH SHALL BE OPERATIONAL AND VISIBLE TO TRAFFIC UNLESS FLAGGERS ARE UTILIZED TO CONTROL TRAFFIC.

COMMITMENTS:

1. THE FIELD/RESIDENT ENGINEER SHALL CONTACT STUDIES AND PLANS COVERING ANY MAJOR CHANGES TO MAKE SURE NO PREVIOUS COMMITMENTS (NOT LISTED) WERE MADE AFFECTING THE DESIGN, AND TO ALLOW IMPROVED DESIGN FOR THE FUTURE.

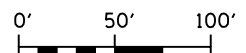
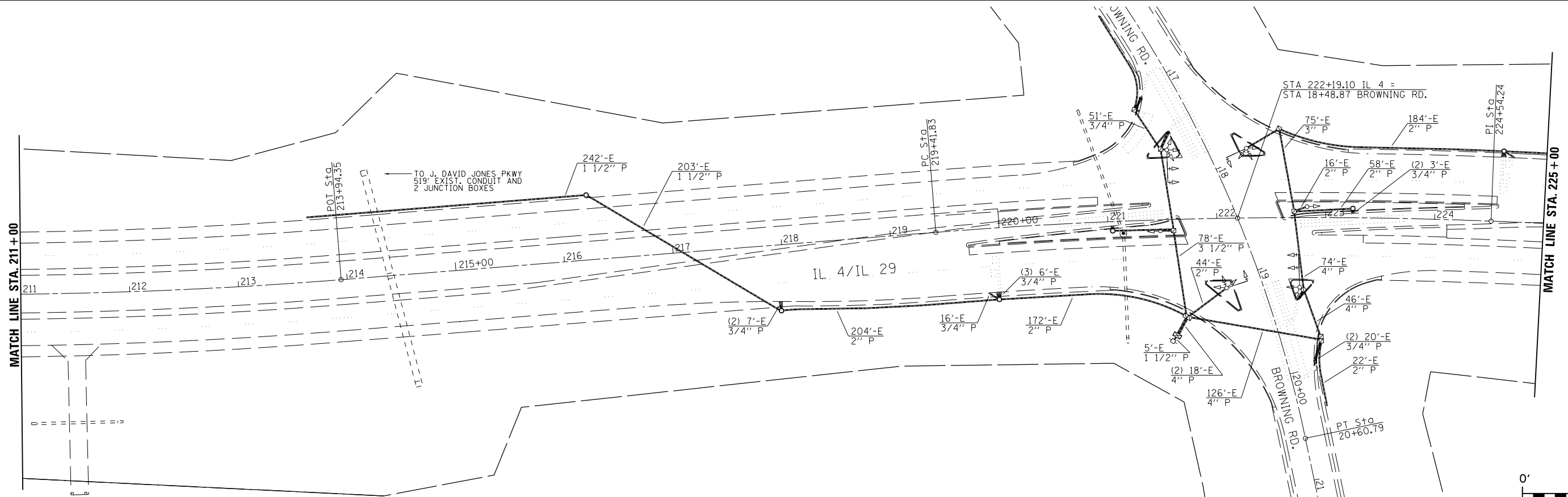

| | | | | | | | | | | | | |
|------------------------------------|----------------|-----------|---|--|-----------|-----------|-----------|---------|-----------------------------|--------------------|-----------|---|
| USER NAME = sparksgw | DESIGNED - | REVISED - | STATE OF ILLINOIS DEPARTMENT OF TRANSPORTATION | INTERCONNECT PLAN VETERANS PKWY. FROM BROWNING RD. TO 8TH ST. | | | F.A. RTE. | SECTION | COUNTY | TOTAL SHEETS | SHEET NO. | |
| PLOT SCALE = 100.0000' / in. | DRAWN - BDM | REVISED - | | SCALE: | SHEET NO. | OF SHEETS | STA. | TO STA. | * | SANGAMON | 42 | 5 |
| PLOT DATE = Aug-25-2011 02:55:35PM | CHECKED - JSA | REVISED - | | | | | | | * D6 TRAF SIGNAL MOD 2011-1 | CONTRACT NO. 72E38 | | |
| | DATE - 7/15/09 | REVISED - | | | | | | | ILLINOIS FED. AID PROJECT | | | |

FILE NAME = c:\pwork\pwork\sparksgw\0278783\0672E38 sht 05.dgn