

VETERANS PARKWAY  
MONROE TO WABASH INTERCONNECT QUANTITIES

QUANTITY	UNIT	ITEM
4245	FOOT	UNDERGROUND CONDUIT, PVC, 1 1/2" DIA.
2	EACH	MODIFY EXISTING CONTROLLER CABINET
10	EACH	GULFBOX JUNCTION, COMPOSITE CONCRETE
4665	FOOT	FIBER OPTIC CABLE IN CONDUIT, NO. 62.5/125, MM12F SM12F
2	EACH	DRILL EXISTING HANDHOLE
10	SQ FT	CONCRETE MEDIAN SURFACE REMOVAL
10	SQ FT	CONCRETE MEDIAN SURFACE 4-INCH

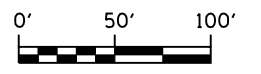
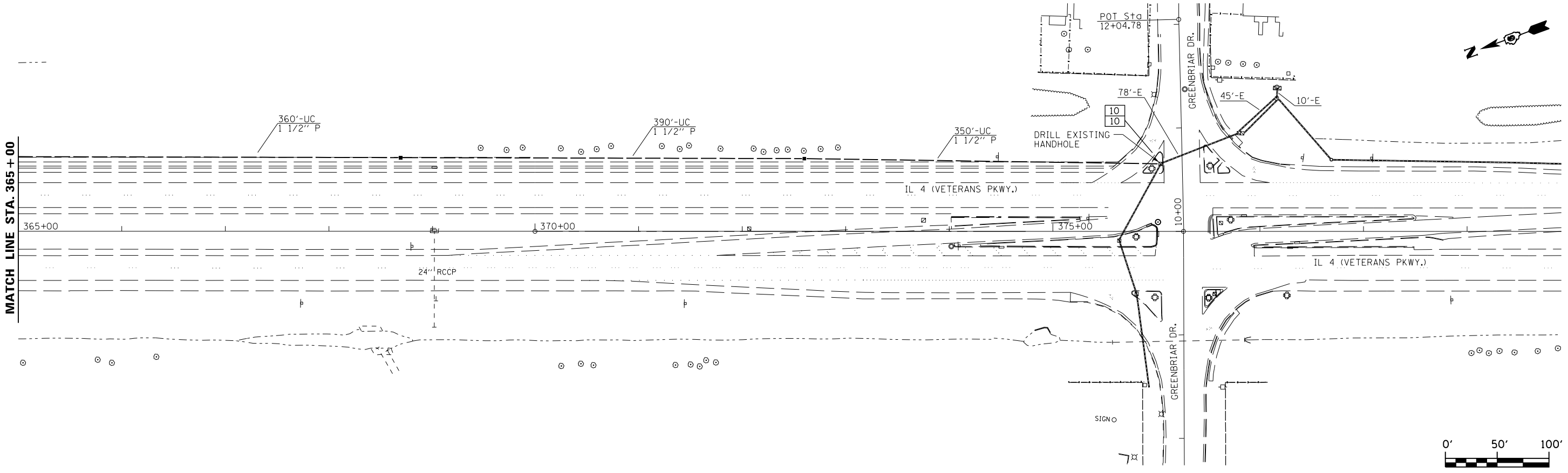

USER NAME = sparksgw	DESIGNED -	REVISED -	<b>STATE OF ILLINOIS DEPARTMENT OF TRANSPORTATION</b>	<b>INTERCONNECT PLAN VETERANS PKWY. FROM MONROE ST/ OLD JACKSONVILLE RD. TO WABASH AVE.</b>			F.A. RTE.	SECTION	COUNTY	TOTAL SHEETS	SHEET NO.	
PLOT SCALE = 100.0000' / in.	DRAWN - BDM	REVISED -		SCALE:	SHEET NO.	OF SHEETS	STA.	TO STA.	*	SANGAMON	42	13
PLOT DATE = Aug-25-2011 09:06:31AM	CHECKED - JSA	REVISED -							* D6 TRAF SIGNAL MOD 2011-1	CONTRACT NO. 72E38		
	DATE - 7/15/09	REVISED -							ILLINOIS FED. AID PROJECT			

FILE NAME = c:\pw\work\p1dot\sparksgw\1d0278783\0672E38 sht 13.dgn