

SIGNAL CONSTRUCTION NOTES

1. NEW MAST ARMS SHALL BE INSTALLED AND SIGNALS PLACED INTO OPERATION PRIOR TO REMOVAL OF EXISTING MAST ARMS.
2. ONLY TWO EXISTING MAST ARMS ON OPPOSITE (DIAGONAL) CORNERS SHALL BE TAKEN OUT OF OPERATION AT ONE TIME WHILE NEW TYPE A FOUNDATION AND TRAFFIC SIGNAL POST AND SIGNAL HEADS ARE INSTALLED AND PLACED INTO OPERATION.
3. CABLES TO EXISTING MAST ARMS TO BE PULLED AND STORED IN NEAREST HANDHOLE DURING FOUNDATION REMOVAL AND INSTALLATION. CABLES TO BE INSTALLED TO BASE OF NEW POSTS AND SPLICED TO NEW CABLES RUNNING UP THE POST.

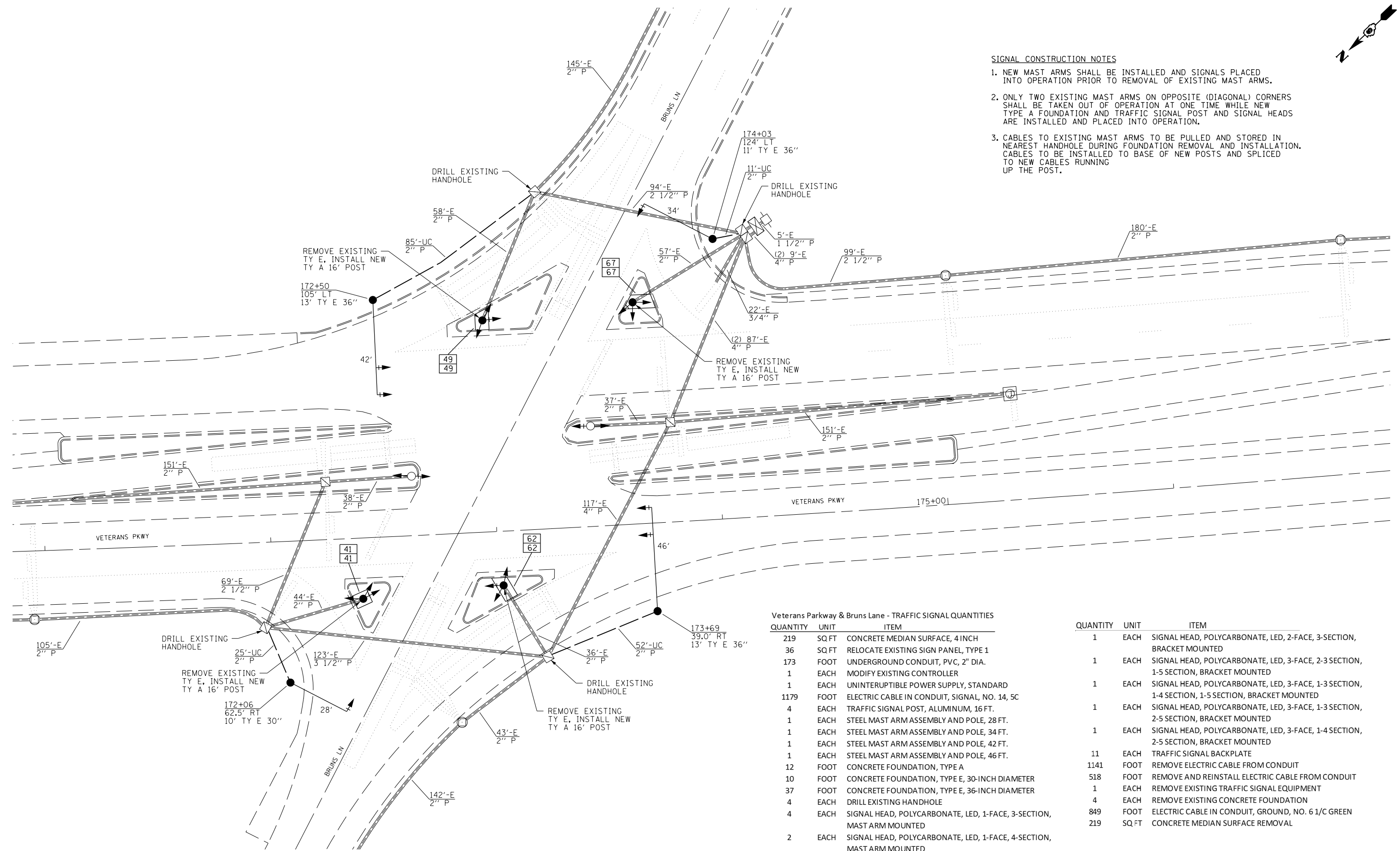

Veterans Parkway & Bruns Lane - TRAFFIC SIGNAL QUANTITIES

| QUANTITY | UNIT | ITEM | QUANTITY | UNIT | ITEM |
|----------|-------|--|----------|-------|---|
| 219 | SQ FT | CONCRETE MEDIAN SURFACE, 4 INCH | 1 | EACH | SIGNAL HEAD, POLYCARBONATE, LED, 2-FACE, 3-SECTION, BRACKET MOUNTED |
| 36 | SQ FT | RELOCATE EXISTING SIGN PANEL, TYPE 1 | 1 | EACH | SIGNAL HEAD, POLYCARBONATE, LED, 3-FACE, 2-3 SECTION, 1-5 SECTION, BRACKET MOUNTED |
| 173 | FOOT | UNDERGROUND CONDUIT, PVC, 2" DIA. | 1 | EACH | SIGNAL HEAD, POLYCARBONATE, LED, 3-FACE, 1-3 SECTION, 1-4 SECTION, 1-5 SECTION, BRACKET MOUNTED |
| 1 | EACH | MODIFY EXISTING CONTROLLER | 1 | EACH | SIGNAL HEAD, POLYCARBONATE, LED, 3-FACE, 1-3 SECTION, 1-4 SECTION, 1-5 SECTION, BRACKET MOUNTED |
| 1 | EACH | UNINTERRUPTIBLE POWER SUPPLY, STANDARD | 11 | EACH | TRAFFIC SIGNAL BACKPLATE |
| 1179 | FOOT | ELECTRIC CABLE IN CONDUIT, SIGNAL, NO. 14, 5C | 1141 | FOOT | REMOVE ELECTRIC CABLE FROM CONDUIT |
| 4 | EACH | TRAFFIC SIGNAL POST, ALUMINUM, 16 FT. | 518 | FOOT | REMOVE AND REINSTALL ELECTRIC CABLE FROM CONDUIT |
| 1 | EACH | STEEL MAST ARM ASSEMBLY AND POLE, 28 FT. | 1 | EACH | REMOVE EXISTING TRAFFIC SIGNAL EQUIPMENT |
| 1 | EACH | STEEL MAST ARM ASSEMBLY AND POLE, 34 FT. | 4 | EACH | REMOVE EXISTING CONCRETE FOUNDATION |
| 1 | EACH | STEEL MAST ARM ASSEMBLY AND POLE, 42 FT. | 4 | EACH | SIGNAL HEAD, POLYCARBONATE, LED, 1-FACE, 3-SECTION, MAST ARM MOUNTED |
| 1 | EACH | STEEL MAST ARM ASSEMBLY AND POLE, 46 FT. | 219 | SQ FT | CONCRETE MEDIAN SURFACE REMOVAL |
| 12 | FOOT | CONCRETE FOUNDATION, TYPE A | | | |
| 10 | FOOT | CONCRETE FOUNDATION, TYPE E, 30-INCH DIAMETER | | | |
| 37 | FOOT | CONCRETE FOUNDATION, TYPE E, 36-INCH DIAMETER | | | |
| 4 | EACH | DRILL EXISTING HANDHOLE | | | |
| 4 | EACH | SIGNAL HEAD, POLYCARBONATE, LED, 1-FACE, 3-SECTION, MAST ARM MOUNTED | | | |
| 2 | EACH | SIGNAL HEAD, POLYCARBONATE, LED, 1-FACE, 4-SECTION, MAST ARM MOUNTED | | | |



| | | | | | | | |
|---|--|--|---|---|---|--|---------------------------------|
| USER NAME = sparksgw PLOT SCALE = 40.0000' / in. PLOT DATE = Aug-25-2011 09:06:53AM | DESIGNED - DRAWN - BDM CHECKED - JSA DATE - 7/15/09 | REVISED - REVISED - REVISED - REVISED - | STATE OF ILLINOIS DEPARTMENT OF TRANSPORTATION | PROPOSED TRAFFIC SIGNAL PLAN VETERANS PKWY. & BRUNS LANE | F.A. RTE. VAR. * D6 TRAF SIGNAL MOD 2011-1 ILLINOIS FED. AID PROJECT | SECTION * COUNTY SANGAMON CONTRACT NO. 72E38 | TOTAL SHEETS 42 SHEET NO. 18 |
| SCALE: SHEET NO. OF SHEETS STA. TO STA. | | | | | | | |

FILE NAME = c:\pwork\pwork\sparksgw\0278783\0672E38 sht 18.dgn