

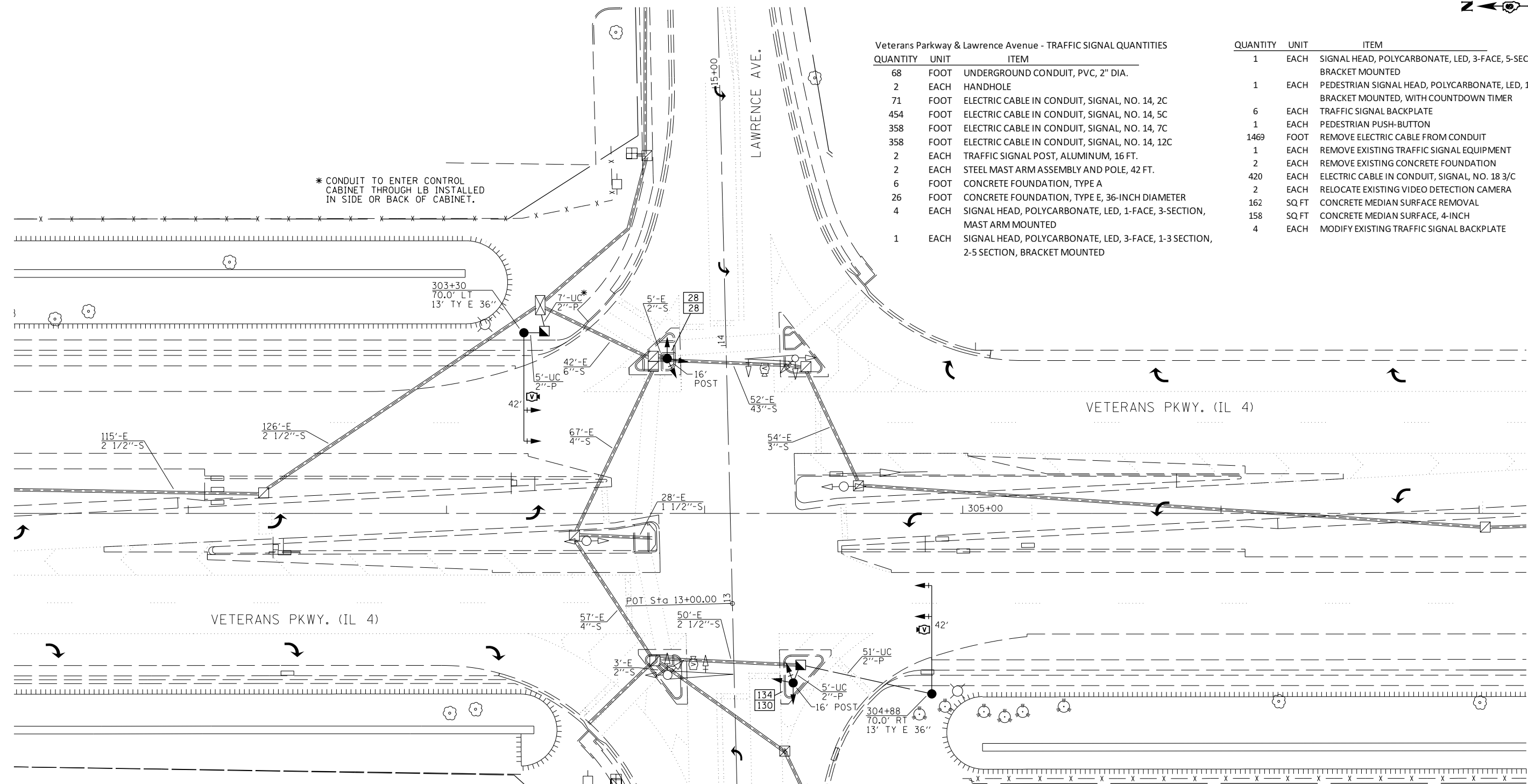

Veterans Parkway & Lawrence Avenue - TRAFFIC SIGNAL QUANTITIES

QUANTITY	UNIT	ITEM
68	FOOT	UNDERGROUND CONDUIT, PVC, 2" DIA.
2	EACH	HANDHOLE
71	FOOT	ELECTRIC CABLE IN CONDUIT, SIGNAL, NO. 14, 2C
454	FOOT	ELECTRIC CABLE IN CONDUIT, SIGNAL, NO. 14, 5C
358	FOOT	ELECTRIC CABLE IN CONDUIT, SIGNAL, NO. 14, 7C
358	FOOT	ELECTRIC CABLE IN CONDUIT, SIGNAL, NO. 14, 12C
2	EACH	TRAFFIC SIGNAL POST, ALUMINUM, 16 FT.
2	EACH	STEEL MAST ARM ASSEMBLY AND POLE, 42 FT.
6	FOOT	CONCRETE FOUNDATION, TYPE A
26	FOOT	CONCRETE FOUNDATION, TYPE E, 36-INCH DIAMETER
4	EACH	SIGNAL HEAD, POLYCARBONATE, LED, 1-FACE, 3-SECTION, MAST ARM MOUNTED
1	EACH	SIGNAL HEAD, POLYCARBONATE, LED, 3-FACE, 1-3 SECTION, 2-5 SECTION, BRACKET MOUNTED

QUANTITY	UNIT	ITEM
1	EACH	SIGNAL HEAD, POLYCARBONATE, LED, 3-FACE, 5-SECTION, BRACKET MOUNTED
1	EACH	PEDESTRIAN SIGNAL HEAD, POLYCARBONATE, LED, 1-FACE, BRACKET MOUNTED, WITH COUNTDOWN TIMER
6	EACH	TRAFFIC SIGNAL BACKPLATE
1	EACH	PEDESTRIAN PUSH-BUTTON
1469	FOOT	REMOVE ELECTRIC CABLE FROM CONDUIT
1	EACH	REMOVE EXISTING TRAFFIC SIGNAL EQUIPMENT
2	EACH	REMOVE EXISTING CONCRETE FOUNDATION
420	EACH	ELECTRIC CABLE IN CONDUIT, SIGNAL, NO. 18 3/C
2	EACH	RELOCATE EXISTING VIDEO DETECTION CAMERA
162	SQ FT	CONCRETE MEDIAN SURFACE REMOVAL
158	SQ FT	CONCRETE MEDIAN SURFACE, 4-INCH
4	EACH	MODIFY EXISTING TRAFFIC SIGNAL BACKPLATE



TRAFFIC SIGNAL CONSTRUCTION NOTES AND STAGING:

- ONLY ONE OF TWO EXISTING MAST ARMS TO BE REPLACED MAY BE TAKEN OUT OF SERVICE AT ONE TIME.
- WHEN NEW NE & SE MAST ARMS ARE READY TO BE PLACED INTO OPERATION, THE EXISTING VIDEO DETECTION CAMERA AND BRACKET SHALL BE RELOCATED TO NEW MAST ARM.
- AFTER NEW MAST ARM IN NE CORNER IS IN OPERATION, EXISTING MAST ARM, POLE, AND SIGNAL HEADS TO BE REMOVED. EXISTING TYPE E FOUNDATION TO BE REMOVED AND A TYPE A FOUNDATION CONSTRUCTED AT SAME LOCATION. NEW POST SIGNAL AND PEDESTRIAN PUSH-BUTTON INSTALLED.
- AFTER NEW MAST ARM IN SW CORNER IS IN OPERATION, EXISTING MAST ARM, POLE, AND SIGNAL HEADS TO BE REMOVED. EXISTING TYPE E FOUNDATION TO BE REMOVED AND A HANDHOLE INSTALLED AT SAME LOCATION. NEW TYPE A FOUNDATION SHALL BE CONSTRUCTED IN ISLAND AS SHOWN.
- EXISTING MAST ARM POLES AND SIGNAL HEADS REMOVED SHALL BE DELIVERED TO CITY OF SPRINGFIELD, CWLP TRAFFIC AND METER SHOP, 1600 GROTH ST.

MODIFY EXISTING TRAFFIC SIGNAL BACKPLATES AT FOLLOWING LOCATIONS:

- EB OVERHEAD - 5 SECTION
- SE MAST ARM POLE - 3 SECTION
- WB OVERHEAD - 5 SECTION
- NW MAST ARM POLE - 3 SECTION

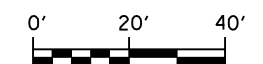

USER NAME = sparksqw	DESIGNED -	REVISED -	<b>STATE OF ILLINOIS DEPARTMENT OF TRANSPORTATION</b>	<b>PROPOSED TRAFFIC SIGNAL PLAN VETERANS PKWY. &amp; LAWRENCE AVE.</b>			F.A. RTE.	SECTION	COUNTY	TOTAL SHEETS	SHEET NO.
PLOT SCALE = 40.0001' / in.	DRAWN - BDM	REVISED -					VAR.	*	SANGAMON	42	22
PLOT DATE = Aug-25-2011 09:07:12AM	CHECKED - JSA	REVISED -		SCALE: SHEET NO. OF SHEETS STA. TO STA.			* D6 TRAF SIGNAL MOD 2011-1 CONTRACT NO. 72E38		ILLINOIS FED. AID PROJECT		
FILE NAME = c:\pw\work\p\dot\sparksqw\d0278783\0672E38 sht 22.dgn	DATE - 7/15/09	REVISED -									