

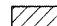

NOTE: STATIONING RUNS BACKWARDS IN THIS AREA

-  PAVEMENT REMOVAL
-  STRUCTURE REMOVAL

FAS 2704 (OLD US RTE 50)
SECTION 12B-1(1) & 12B-1(2)
CLAY COUNTY
ENDS STATION 339+10

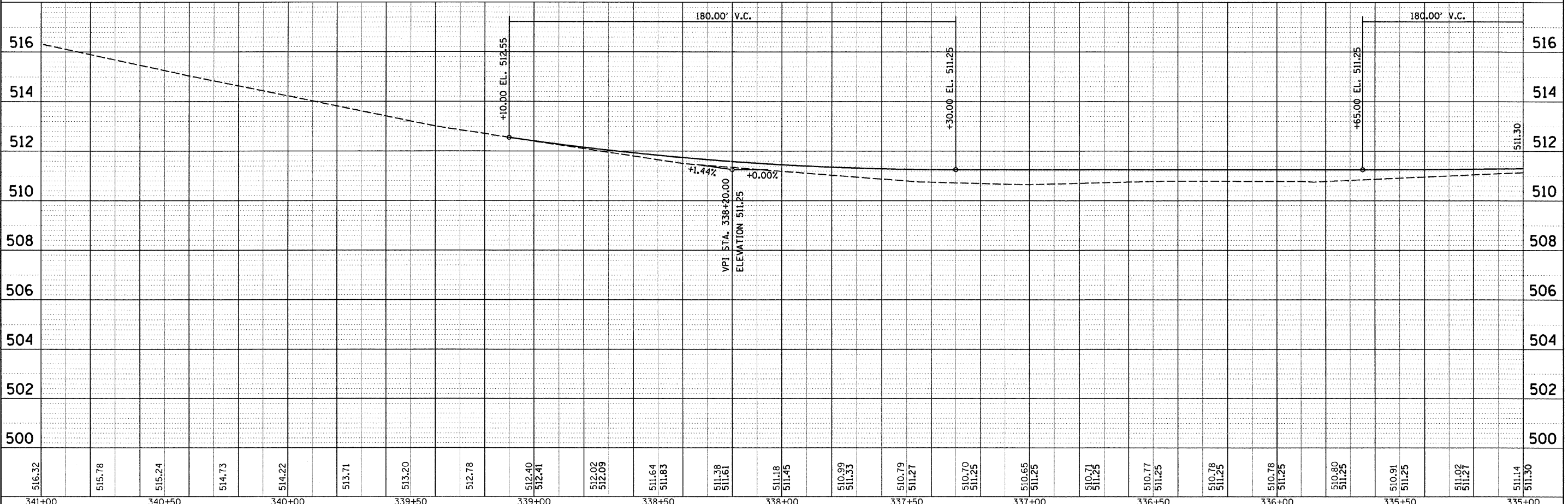
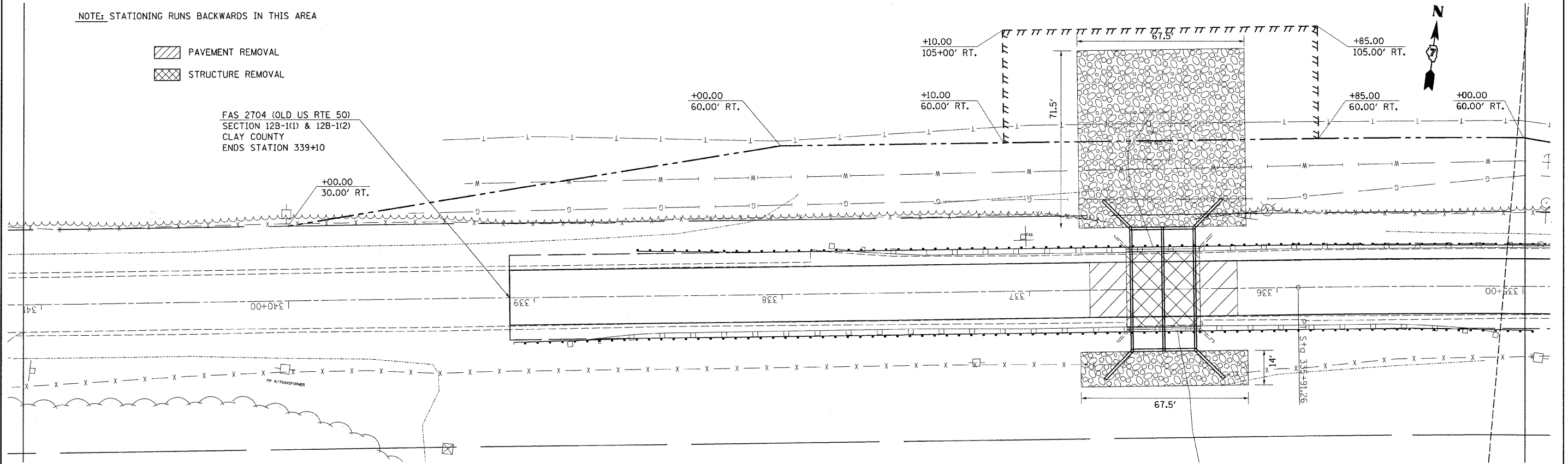

PLAN	SURVEYED	DATE
	PLOTTED	BY
	CHECKED	
	BY	
	NO. OF PAGES	
	FILE NAME	

PROFILE	SURVEYED	DATE
	PLOTTED	BY
	CHECKED	
	BY	
	NO. OF PAGES	
	FILE NAME	

FILE NAME =	USER NAME = swartzw	DESIGNED -	REVISED -	STATE OF ILLINOIS DEPARTMENT OF TRANSPORTATION	PLAN PROFILE S.N. 013-2013 BRUSH CREEK	F.A.S. RTE.	SECTION	COUNTY	TOTAL SHEETS	SHEET NO.
c:\pw_work\pwidot\swartzw\0121944\d7741\sh-1-planprof.dgn	PLOT SCALE = 20.0000' / IN.	DRAWN -	REVISED -			2704	12B-1(1) & 12B-1(2)	CLAY	39	14
PLOT DATE = 2/3/2011	DATE -	CHECKED -	REVISED -			CONTRACT NO. 74116				
		DATE -	REVISED -			ILLINOIS FED. AID PROJECT				
					SCALE: 20	SHEET NO. 1 OF 2 SHEETS		STA. 335+00 TO STA. 341+00		