

F.A.P. RTE.	SECTION	COUNTY	TOTAL SHEETS	SHEET NO.
741	(11,12)T	ILLINOIS	85	1
CONTRACT NO. 74422				

• MACON & PIATT

D-97-001-10

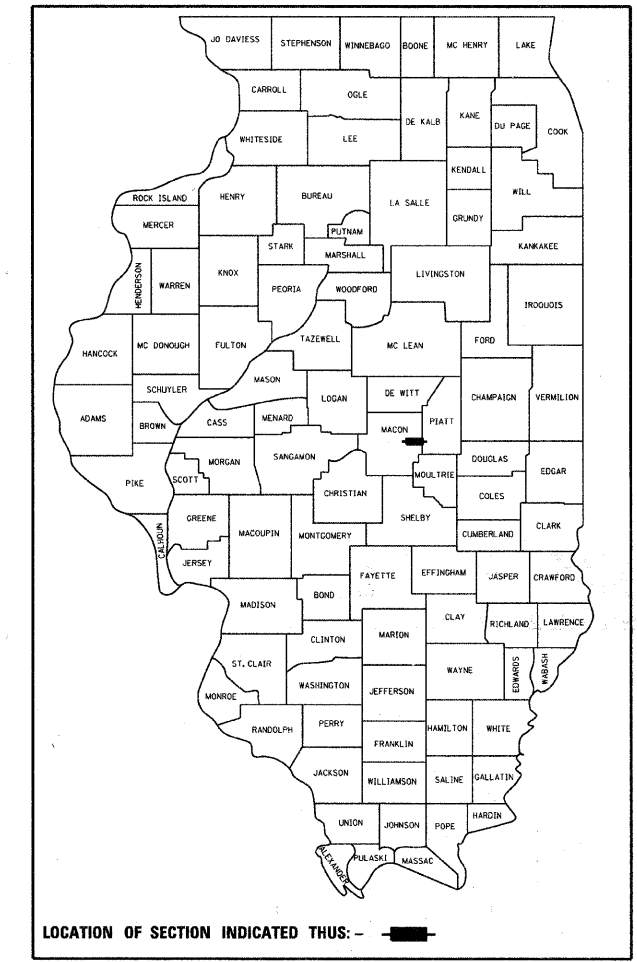

LOCATION OF SECTION INDICATED THUS: - [rectangle symbol]

STATE OF ILLINOIS  
DEPARTMENT OF TRANSPORTATION  
DIVISION OF HIGHWAYS

**PROPOSED  
HIGHWAY PLANS**

F.A.P. ROUTE 741 (IL. RTE. 105)  
SECTION (11,12)T  
PROJECT ACHSIP-0741(108)  
SAFETY IMPROVEMENTS  
MACON & PIATT COUNTIES  
C-97-004-10



FOR INDEX OF SHEETS, SEE SHEET NO. 2

**STATION EQUATION:**  
STA. 339 + 01.36 (BK) = STA. 339 + 00.00 (AH)

**BRIDGE OMISSION:**  
STA. 349 + 13.88 TO STA. 349 + 46.13

ADT = 3,450 (2009)

FAP ROUTE 741 (IL 105)  
SECTION (11,12)T  
BEGINS STATION 163 + 53  
MACON COUNTY

FAP ROUTE 741 (IL 105)  
SECTION (11,12)T  
ENDS STATION 530 + 60  
PIATT COUNTY

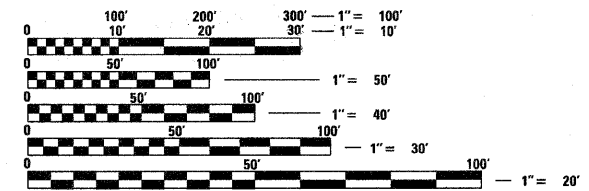

FULL SIZE PLANS HAVE BEEN PREPARED USING STANDARD ENGINEERING SCALES. REDUCED SIZED PLANS WILL NOT CONFORM TO STANDARD SCALES. IN MAKING MEASUREMENTS ON REDUCED PLANS, THE ABOVE SCALES MAY BE USED.

J.U.L.I.E.  
JOINT UTILITY LOCATION INFORMATION FOR EXCAVATION  
1-800-892-0123  
OR 811

PROJECT ENGINEER: TOM RONAN  
PROJECT MANAGER: JENNIFER WENTHE

CONTRACT NO. 74422

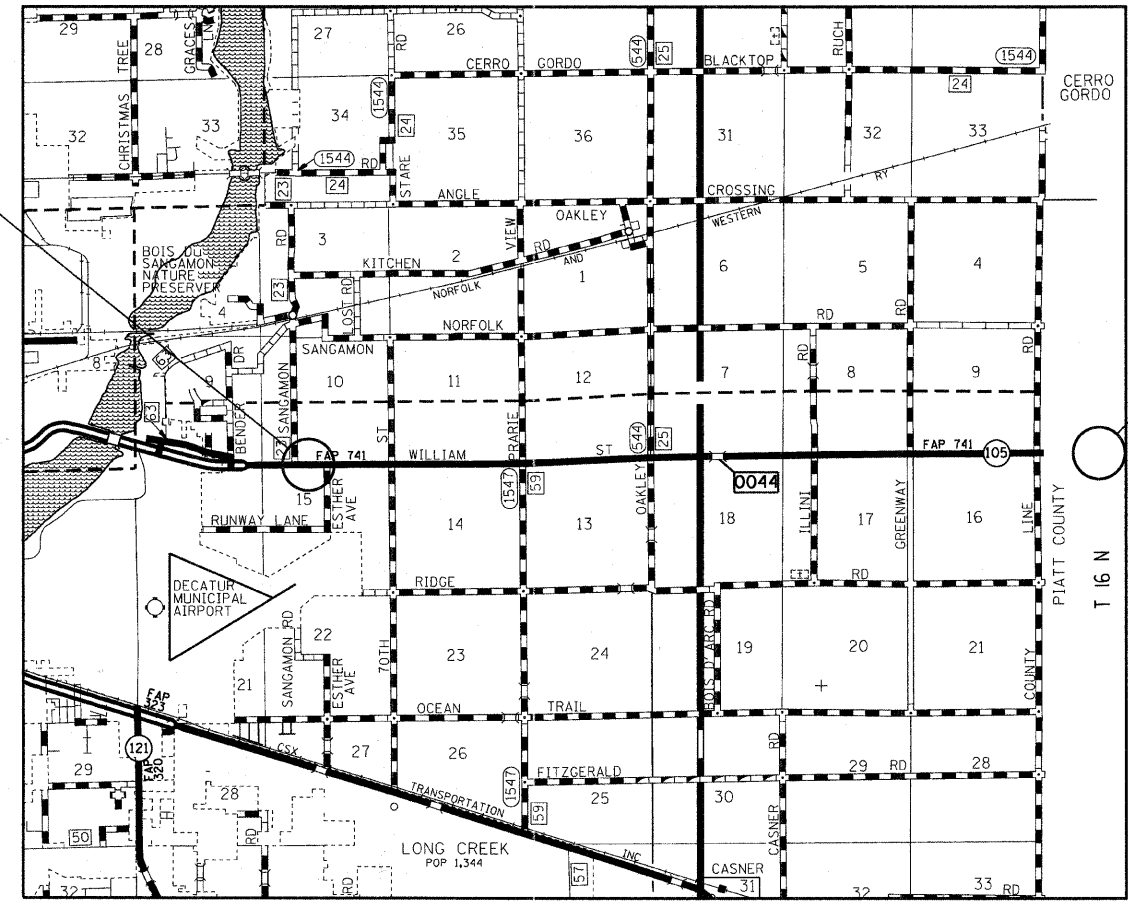

GROSS LENGTH = 36,708.36 FT. = 6.95 MILES  
NET LENGTH = 36,676.10 FT. = 6.95 MILES

STATE OF ILLINOIS  
DEPARTMENT OF TRANSPORTATION  
DIVISION OF HIGHWAYS

SUBMITTED 08/17 20 11  
Roger L. D... [Signature]  
DEPUTY DIRECTOR OF HIGHWAYS, REGION ENGINEER

October 14 20 11  
Scott E. Stott P.E. [Signature]  
acting ENGINEER OF DESIGN AND ENVIRONMENT

October 14 20 11  
Christine M. Reed [Signature]  
DIRECTOR OF HIGHWAYS, CHIEF ENGINEER

PRINTED BY THE AUTHORITY  
OF THE STATE OF ILLINOIS