

ST. CLAIR AVENUE BASELINE

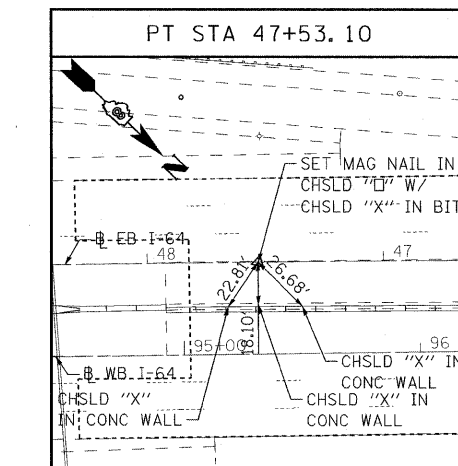
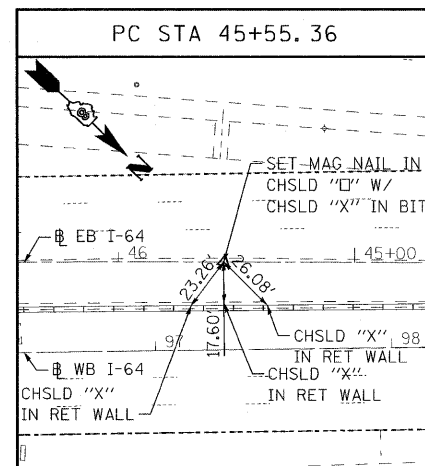
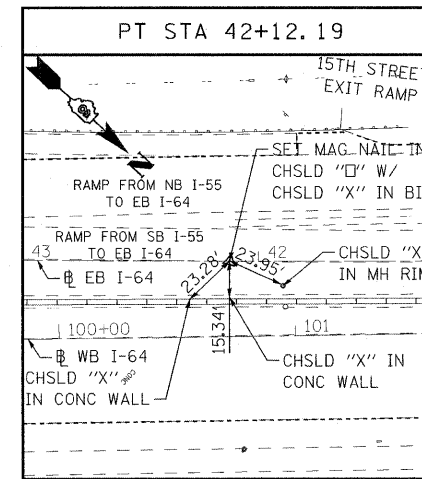
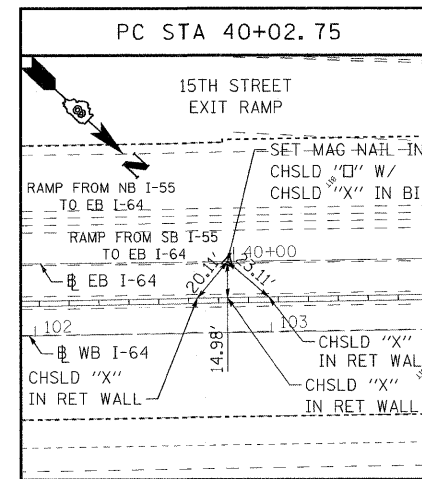
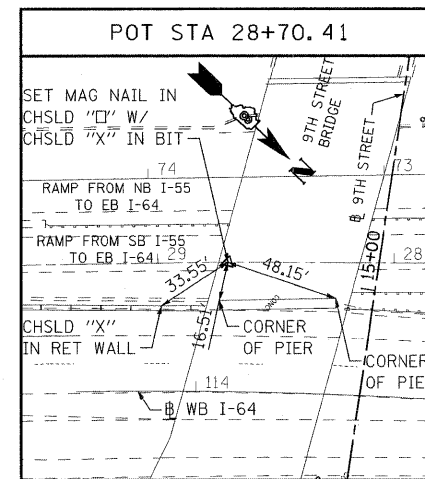
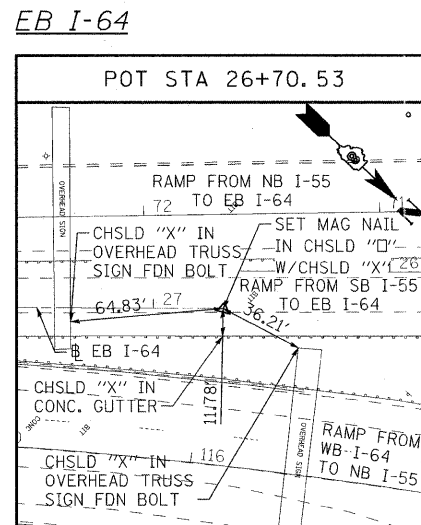
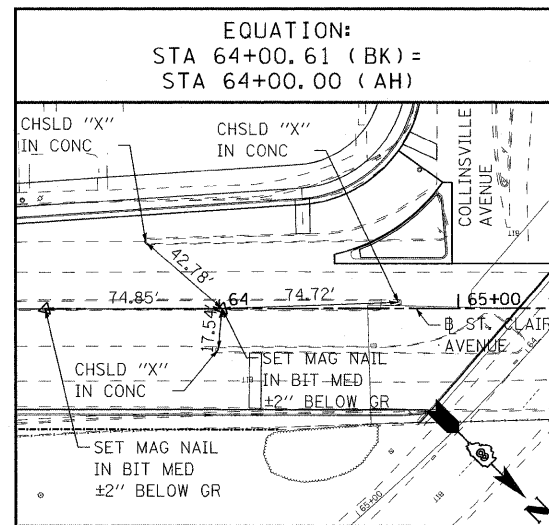
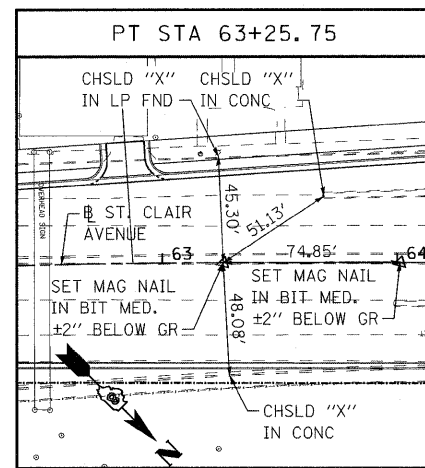
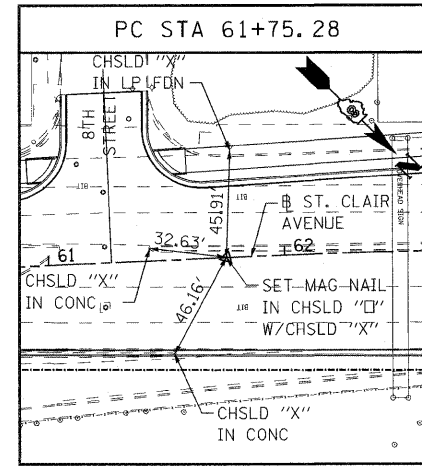
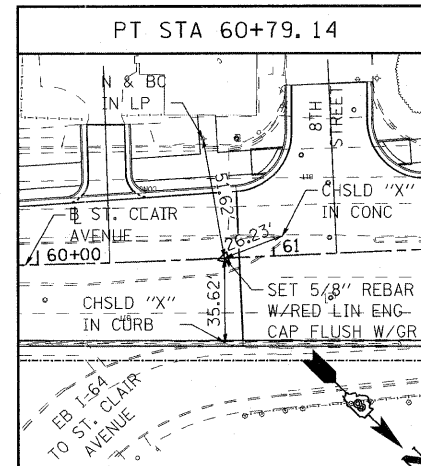
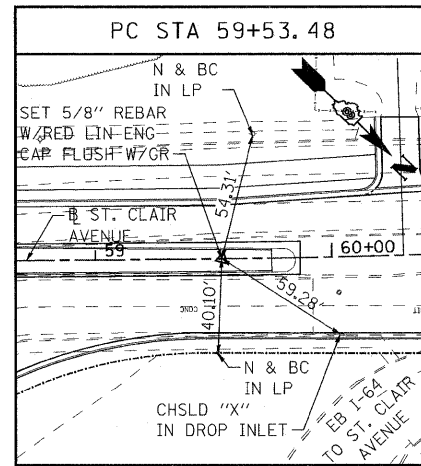
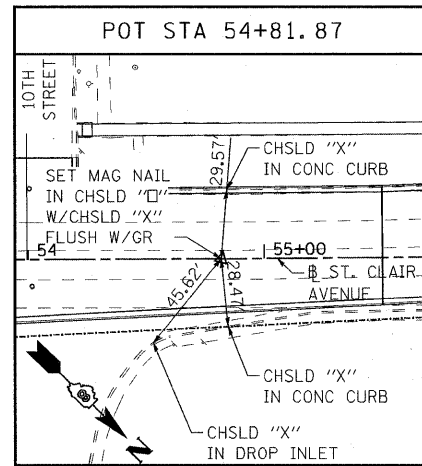
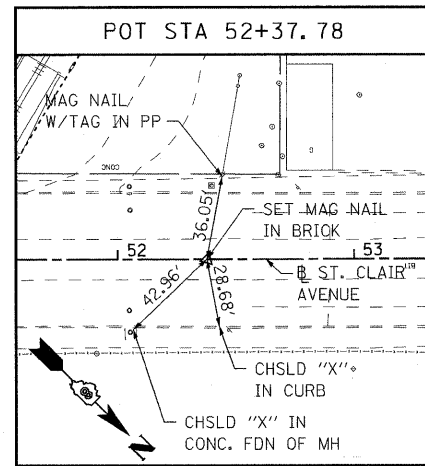

EB I-64

STATE OF ILLINOIS
DEPARTMENT OF TRANSPORTATION

ALIGNMENT, TIES, AND BENCHMARKS

F.A.U. RTE.	SECTION	COUNTY	TOTAL SHEETS	SHEET NO.
82-1-3HB, 82-2N, 82-1-12RS	ST. CLAIR	352	29	
FAI 64/9166/9180	CONTRACT NO.	76C51		
FED. ROAD DIST. NO.	ILLINOIS FED. AID PROJECT			

SCALE: NONE

SHEET NO. 4 OF 4 SHEETS

STA. ----- TO STA. -----

6/9/2011 10:05:50 AM

FILE NAME = DBTRI-76C51-sht-aligntiebm-01-04.dgn

USER NAME = j1s
MODEL NAME = DBTRI-76C51-sht-aligntiebm-04
PLOT SCALE = 1:40
PLOT DATE = 6/9/2011

DESIGNED - LUC
DRAWN - JF
CHECKED - GB
DATE - 03/31/11

REVISED -
REVISED -
REVISED -
REVISED -

P:\208-0030 CTE TRILEVEL\900 CAD\901 DRAWINGS\08 CONTRACT\SHEET\CIVIL\GENERAL\DBTRI-76C51-SHT-ALIGN\TIEBM-01-04.DGN