

SHEET	STATION	TO STATION	TEMPORARY PAVEMENT MARKING - LINE 4" FOOT	WORK ZONE PAVEMENT MARKING REMOVAL SQ FT	RELOCATE TEMPORARY CONCRETE BARRIER FOOT	IMPACT ATTENUATORS, RELOCATE FULLY REDIRECTIVE, TEST LEVEL 3 EACH
I-55 NB / 55N64E						
81	BEGIN	TO 59+00.00	1,455	720	-	-
82	59+00.00	TO 69+00/24+00	1,714	697	250	2
I-64 WB / I-64 EB						
83	69+00/24+00	TO 38+00.00	-	-	-	-
84	38+00.00	TO 52+50.00	-	-	-	-
85	52+50.00	TO END	-	-	-	-

TOTALS	3,169	1,417	250	2
---------------	--------------	--------------	------------	----------

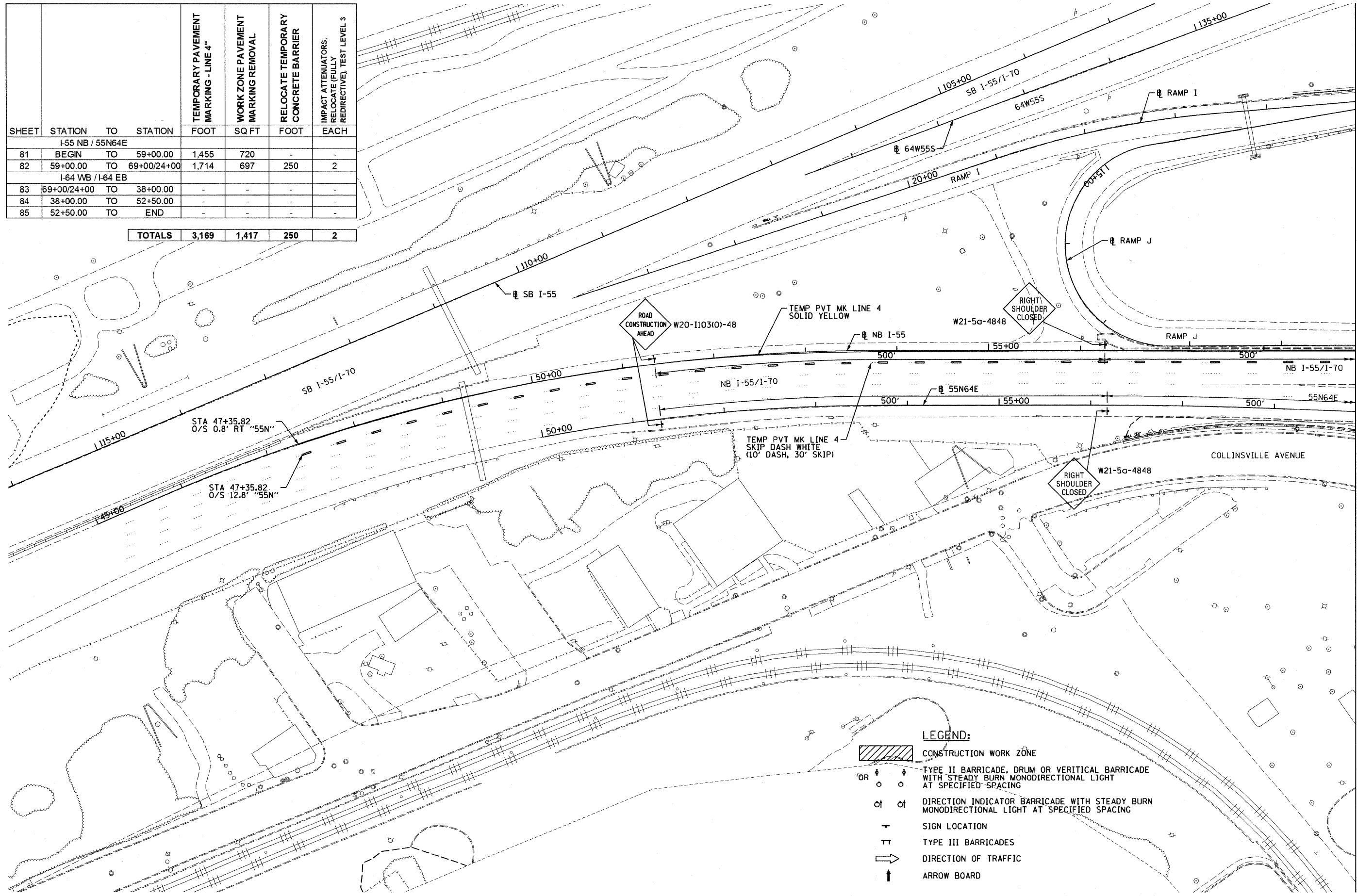

MATCHLINE STA 59+00 @ 55N



- LEGEND:**
- CONSTRUCTION WORK ZONE
 - TYPE II BARRICADE, DRUM OR VERTICAL BARRICADE WITH STEADY BURN MONODIRECTIONAL LIGHT AT SPECIFIED SPACING
 - DIRECTION INDICATOR BARRICADE WITH STEADY BURN MONODIRECTIONAL LIGHT AT SPECIFIED SPACING
 - SIGN LOCATION
 - TYPE III BARRICADES
 - DIRECTION OF TRAFFIC
 - ARROW BOARD

FILE NAME = DBTRI-76C51-sht-Mainline MOT3 Staging 01.dgn	USER NAME = maronik	DESIGNED KM	REVISED -
PLOT SCALE = 100.0000' / in.	CHECKED OP	DRAWN KM	REVISED -
PLOT DATE = MAR. 31, 2011	DATE 03/31/2011	CHECKED OP	REVISED -

**STATE OF ILLINOIS
DEPARTMENT OF TRANSPORTATION**

**MAINLINE - SUGGESTED STAGES OF CONSTRUCTION
AND TRAFFIC CONTROL - STAGE 3**

SCALE: 1"=50' SHEET NO. 1 OF 5 SHEETS STA. TO STA.

F.A. RTE.	SECTION	COUNTY	TOTAL SHEETS	SHEET NO.
• 82-1-3NB, 82-2N, 82-1-12RS		ST. CLAIR	352	81
• 9166/9180/9213/9214				CONTRACT NO. 76C51
FED. ROAD DIST. NO.	ILLINOIS FED. AID PROJECT			