

NOTES:

JOINTS SHALL BE CUT AS SOON AS POSSIBLE AFTER PLACEMENT OF CONCRETE. THE AREA OF CONCRETE DISTURBED BY THE CUTTING OPERATION SHALL BE RESPRAYED WITH CURING COMPOUND IMMEDIATELY AFTER REMOVING CUTTING EQUIPMENT FROM PAVEMENT.

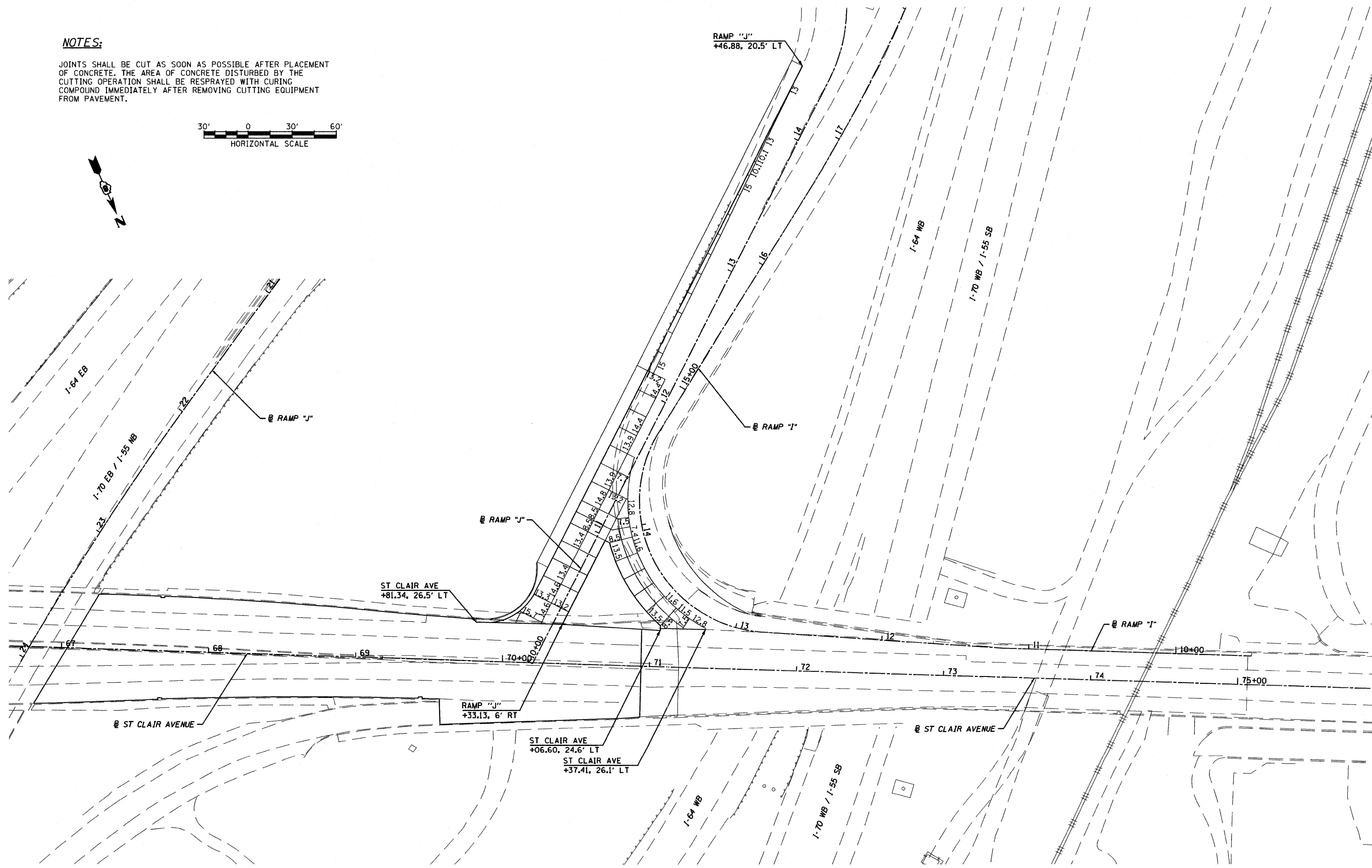

FILE NAME = DBTRI-76C51-sht-joint-01-06.dgn USER NAME = jlt MODEL NAME = DBTRI-76C51-sht-jointing-05 PLOT SCALE = 1:60 PLOT DATE = 6/8/2011	DESIGNED - LDT	REVISED -	STATE OF ILLINOIS DEPARTMENT OF TRANSPORTATION	JOINT PLAN		F.A.U. RTE.	SECTION	COUNTY	TOTAL SHEETS	SHEET NO.
	DRAWN - MBB	REVISED -		82-1-3HB, 82-2N, 82-1-12RS	ST. CLAIR	352	138			
	CHECKED - GEB	REVISED -		FAI 64/9166/9180	CONTRACT NO. 76C51					
	DATE - 03/31/11	REVISED -		FED. ROAD DIST. NO. [ILLINOIS] FED. AID PROJECT						
SCALE: 1"=30' SHEET NO. 5 OF 6 SHEETS STA. ----- TO STA. -----										

P:\08-0030 CTE TRILEVEL\9800_CAD\901_DRAWINGS\08_CONTRACT\SHEET\CIVIL\ROADWAY_PLANS\DBTRI-76C51-SHT-JOINT-01-06.DGN