

NOTES
 1. SEE STANDARD 720006 FOR SIGN ERECTION DETAILS.
 2. SIGN LOCATIONS MAY BE ADJUSTED BY THE ENGINEER TO MEET FIELD CONDITIONS.

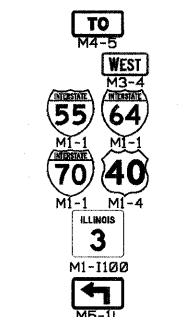

LOCATE SIGN
 ALONG COLLINSVILLE AVE
 260' PRIOR TO RI-1

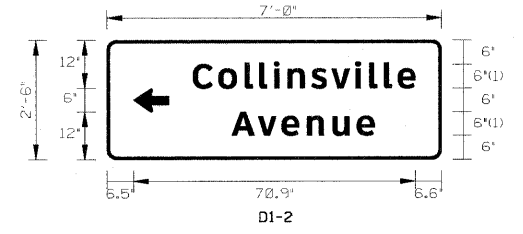
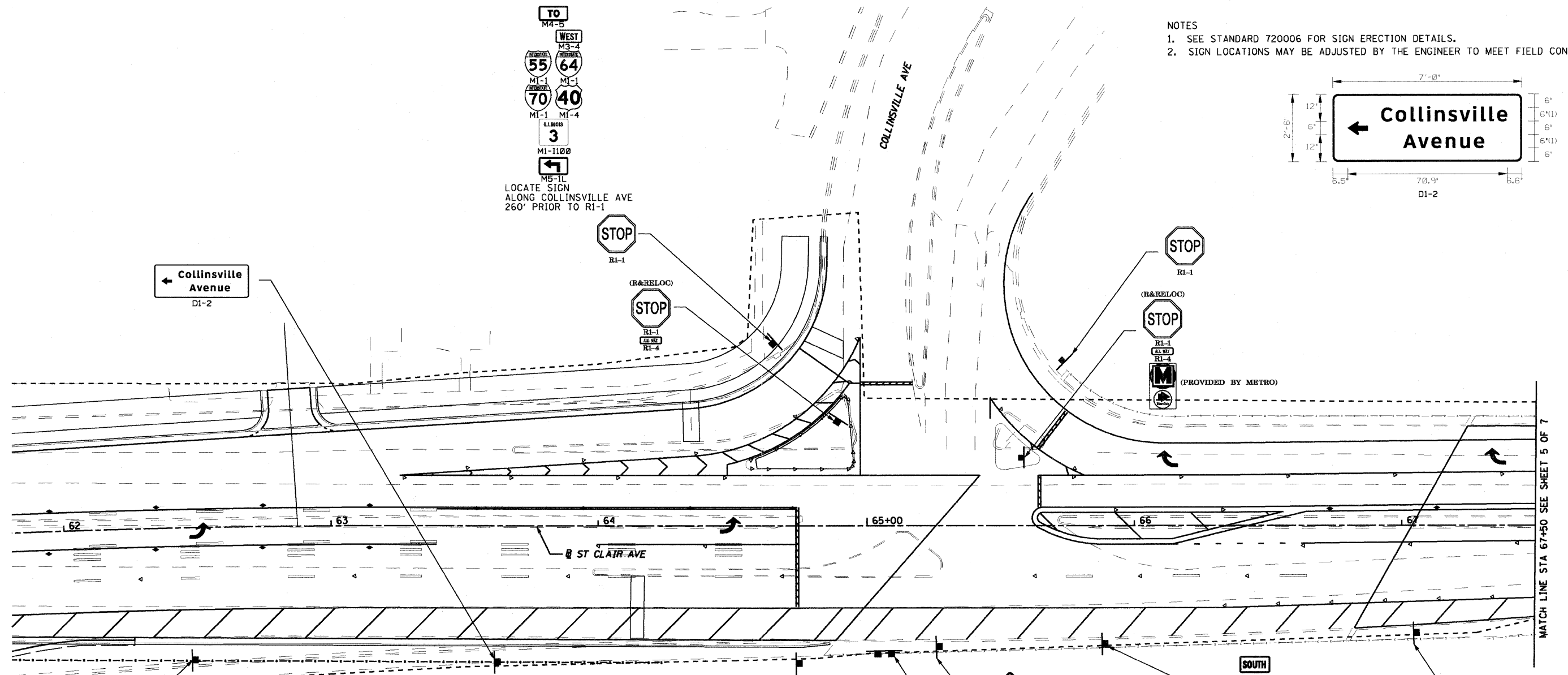

SIGN LEGEND

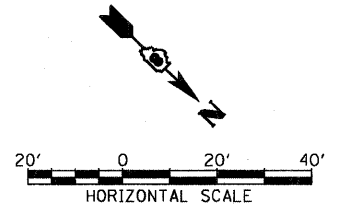
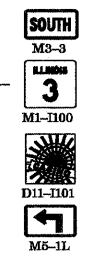
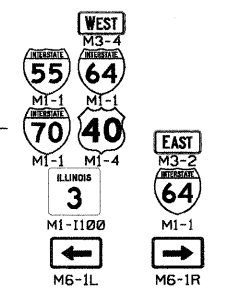
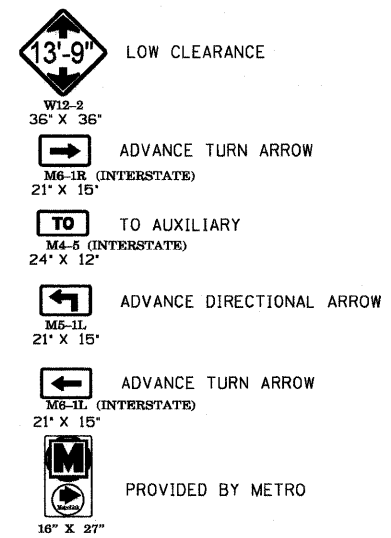
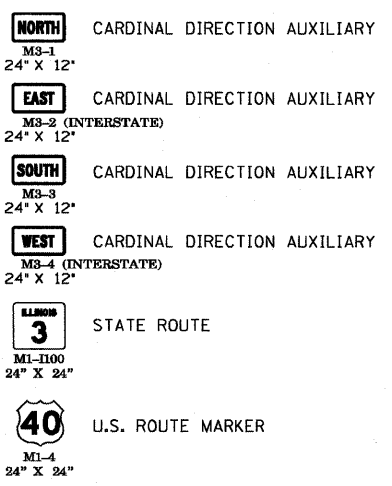
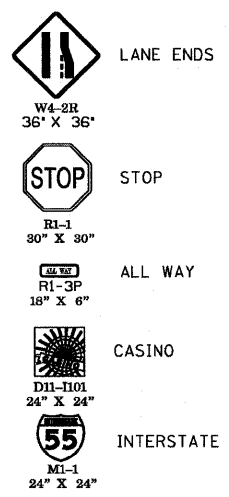

FILE NAME =	USER NAME = generaluse	DESIGNED - LDT	REVISED - 10/05/11	STATE OF ILLINOIS DEPARTMENT OF TRANSPORTATION	SIGNING PLAN AND DETAILS	F.A.U. RTE.	SECTION	COUNTY	TOTAL SHEETS	SHEET NO.
	MODEL NAME = #MODELNAME#	DRAWN - MBB	REVISED -			82-1-3HB, 82-2N, 82-1-12RS	ST. CLAIR	352	162	
	PLOT SCALE = 40.0000' / IN.	CHECKED - GEB	REVISED -			FAI 64/9166/9180	CONTRACT NO. 76C51			
	PLOT DATE = 10/5/2011	DATE - 03/31/11	REVISED -			FED. ROAD DIST. NO. ILLINOIS FED. AID PROJECT				

10/5/2011 3:55:03 PM

P:\PROJECTS\876500\CAD\06\0811-76C51-SHT-SIGN-01-06.DGN