

STATE OF ILLINOIS
DEPARTMENT OF TRANSPORTATION

LEGEND

- Deck Slab Repair (Partial)
- Remove and replace concrete for traffic rail posts. See sheets S6, S7, and S8.
- Remove existing concrete island

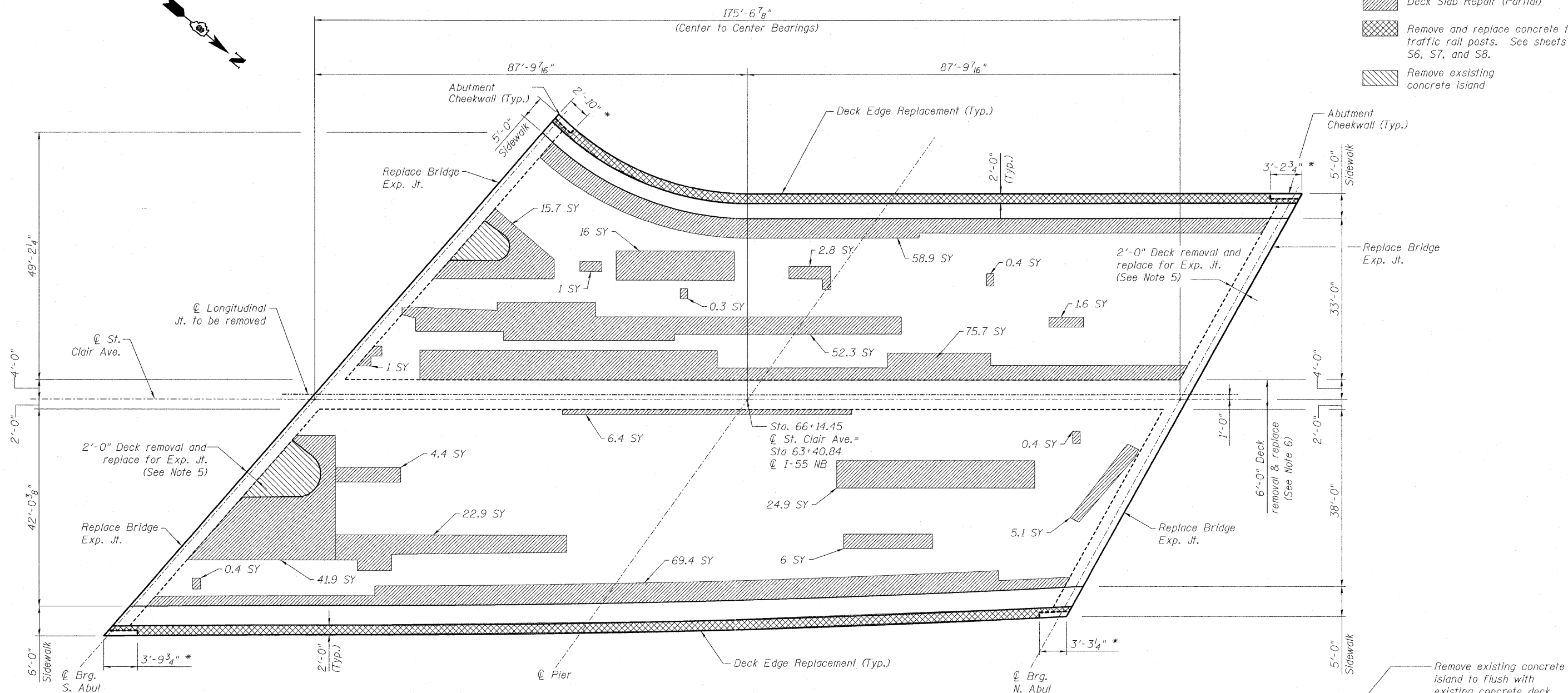

DECK PLAN

NOTES:

1. A minimum curing period of 7 days is required for all deck repairs.
2. For bridge expansion joint replacement at Abutments see Sheets S11, S12, & S13.
3. Estimated deck slab repairs are based on an infrared thermographic survey performed by AECOM that located areas of delamination and existing concrete patches.
4. The quantities shown for deck repair are for bidding purposes only. The actual areas to be repaired will be determined by the Engineer in the field.
5. For additional deck removal details and quantities for Expansion Joint replacement and Longitudinal Joint replacement see sheets S5 and S11 thru S13.
6. For pedestrian fence, traffic rail, and deck edge replacement see sheet S8. Work with this sheet.
7. At each of the four corners of the deck, there are blockouts for the abutment wingwall. Continue removal of deck around the blockouts.
8. Existing concrete islands shall also be removed from south approach areas. Island removal is part of Stage I Removal, see sheet S3.

* Dimensions determined from existing plans. Includes 1" open joint. Verify in field.

EXISTING ISLAND REMOVAL SECTION

BILL OF MATERIAL

Item	Unit	Quantity
Deck Slab Repair (Partial)	Sq. Yd.	408
Concrete Removal	Cu. Yd.	59

DESIGNED - DEV
CHECKED - EJO
DRAWN - MRK
CHECKED - EJO

**DECK REPAIR PLAN
STRUCTURE NO. 082-0099**

SHEET NO.	F.A.I. RTE.	SECTION	COUNTY	TOTAL SHEETS	SHEET NO.
S4	64	82-1-3HB, 82-2N, 82-1-12RS	ST. CLAIR	352	242
S20 SHEETS	F.A.U. 9166 / F.A.U. 9180		CONTRACT NO. 76C51		
FED. ROAD DIST. NO.		ILLINOIS FED. AID PROJECT			