

FOR INFORMATION ONLY

Table for SPAN 1 showing ELEV. LINE, BEAM NO., STATION, OFFSET, THEO. TOP OF ROAD, and THEO. ADJ. FOR D.L. for various bridge bents (A, B, C, D, E, F).

Table for SPAN 2 showing ELEV. LINE, BEAM NO., STATION, OFFSET, THEO. TOP OF ROAD, and THEO. ADJ. FOR D.L. for various bridge bents (G, H, J, K).

Table for SPAN 3 showing ELEV. LINE, BEAM NO., STATION, OFFSET, THEO. TOP OF ROAD, and THEO. ADJ. FOR D.L. for various bridge bents (L, M, N, O).

Summary table with columns: ROUTE NO., SECTION, COUNTY, TOTAL SHEETS, SHEET NO.

Table for SPAN 4 showing ELEV. LINE, BEAM NO., STATION, OFFSET, THEO. TOP OF ROAD, and THEO. ADJ. FOR D.L. for various bridge bents (P, Q, R, S, T, U).

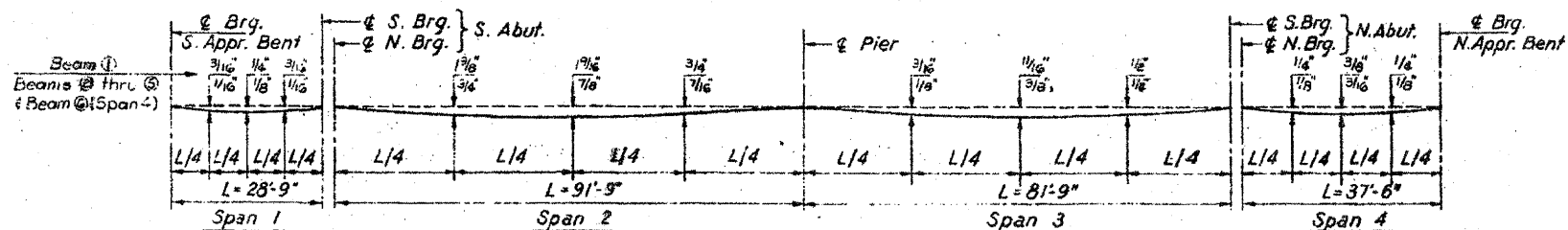

DEAD LOAD DEFLECTION DIAGRAM (Includes weight of concrete only)

Note: The above deflections are not to be used in the field if the Engineer is working from the grade elevations adjusted for dead load deflections shown on this sheet.

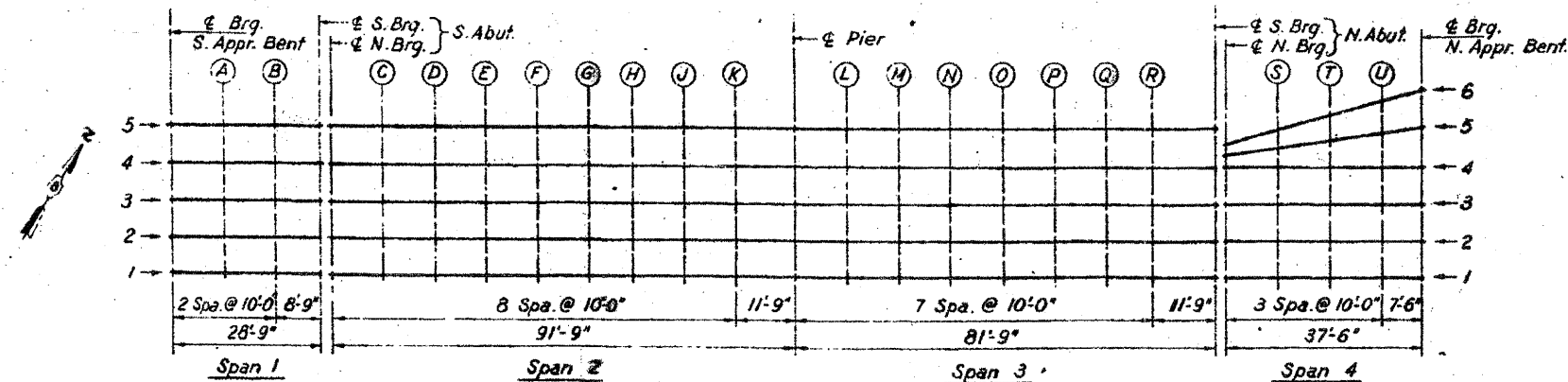

PLAN

FILLET HEIGHTS-APPR. SPANS

To determine 't': After all precast prestressed beams have been erected, elevations of the top flanges of the beams shall be taken at intervals shown. These elevations subtracted algebraically from the 'Theoretical Grade Elevations Adjusted for Dead Load Deflections' shown minus slab thickness equals the fillet heights 't'. A positive value of 't' equals the fillet height above the top of the beam. A negative value of 't' not to exceed '1/2" equals the embedment of the beam above the theoretical bottom of slab elevation.

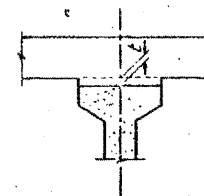

FILLET HEIGHTS-GIRDER SPANS

To determine 't': After all structural steel has been erected elevations of the top flanges of the girders shall be taken at intervals shown on this sheet. These elevations subtracted from the 'Theoretical Grade Elevations Adjusted for Dead Load Deflections' shown on this sheet, minus slab thickness equals the fillet heights 't' above top of girders.

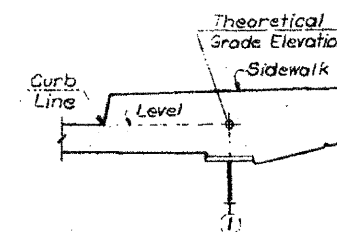
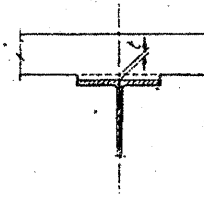

LOCATION OF THEO. GRADE ELEVATION - BEAM ①

STATE OF ILLINOIS DIVISION OF HIGHWAYS TABLES OF ELEVATIONS F. A. ROUTE 12 (10TH STREET) OVER F.A.I. ROUTE 64 STATION 58+17.87

Table with columns: F.A. RT. 64, SECTION, COUNTY, STATION, SHEET NO.