

FOR INFORMATION ONLY

PROJECT NO.	SEC.	COUNTY	TOTAL SHEETS	SHEET NO.
082-0099	352	ST. CLAIR	352	301B

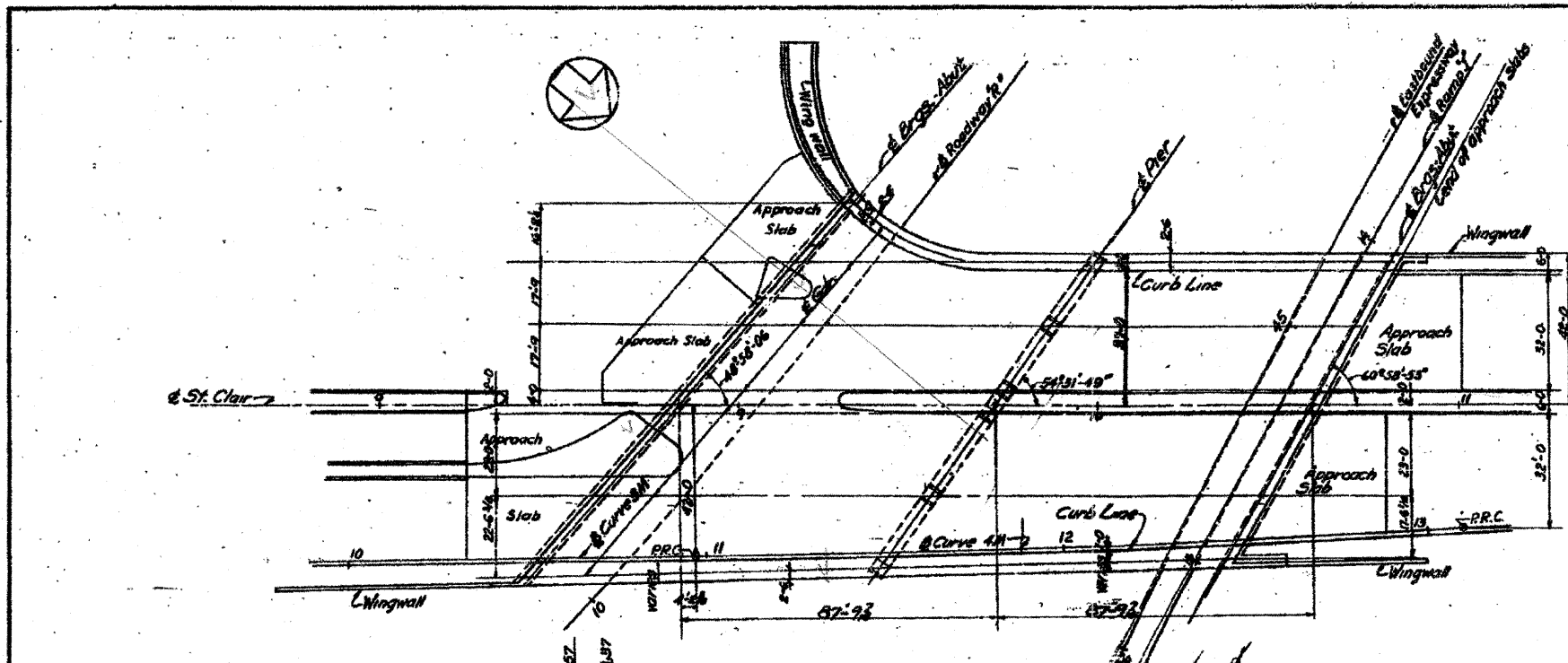

CURVE DATA

Curve #	Curve #	Curve #
ROADWAY 'R'	EASTBOUND EXPWY	RAMP 'J'
PI=Sta 13+00.33 Δ = 53°12'54" Dc = 8°00'00" Ls = 500.00' R = 712.30' Ts = 511.16' Es = 90.64' Lc = 365.19' Os = 18°00'00"	PI = Sta 44+62.41 Δ = 10°01'26" Dc = 2°00'00" Ls = 200.00' R = 2864.73' Ts = 391.29' Es = 11.53' Lc = 301.19' Os = 2°00'00"	PI = Sta 13+63.50 Δ = 3°06'31" Dc = 2°35'47" Lc = 550.89' R = 2206.79' T = 175.32' E = 6.99'
Curve #3 - North Edge RELOCATED COLLINSVILLE PI = Sta 6+12.70 Δ = 122°38'55" Dc = 35°29'45" L = 188.44' R = 60.00' T = 109.70' E = 65.04'	Curve #3 RAMP 'M' PI = Sta 6+72.32 Δ = 1°30'00" Dc = 6°45'10" R = 2554.73' L = 441.96' E = 6.58' T = 224.24'	Curve #4 RAMP 'M' PI = Sta 12+03.76 Δ = 2°00'00" Dc = 4°16'58" R = 2554.73' L = 214.15' E = 2.00' T = 107.12'

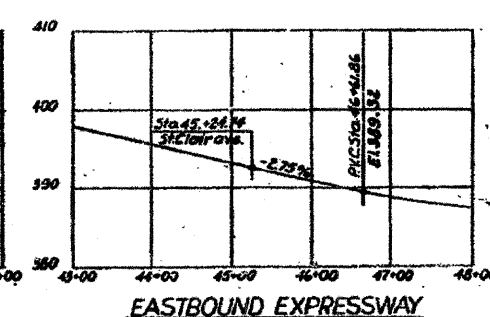
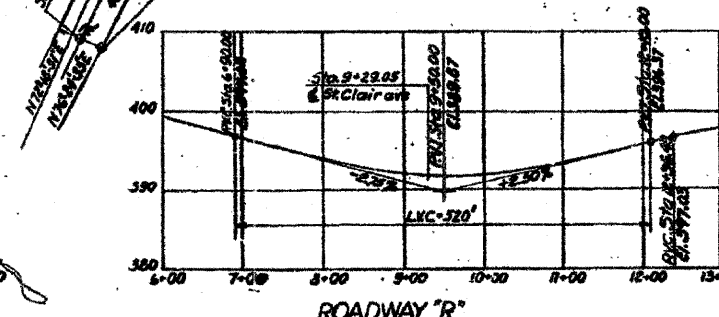
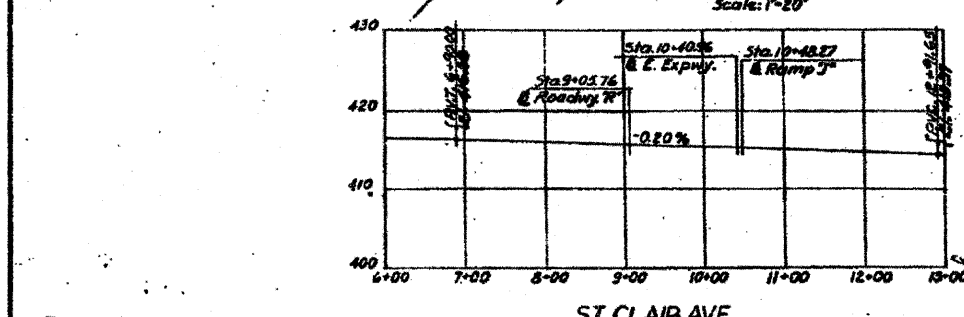
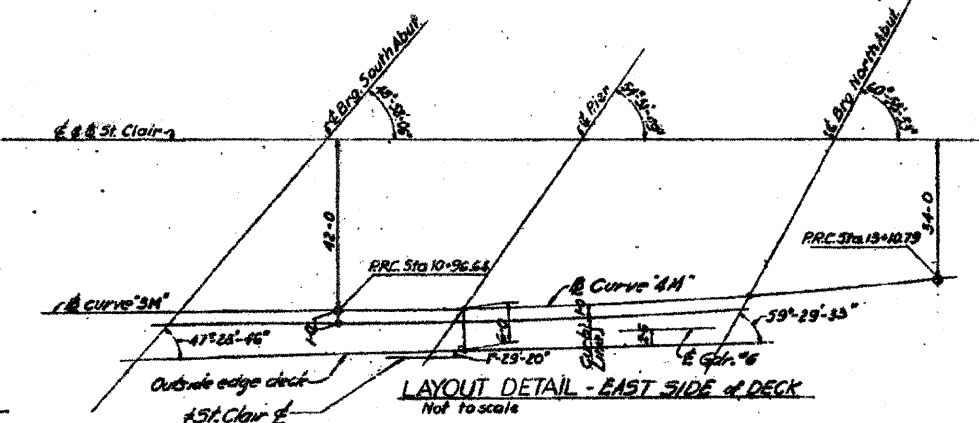
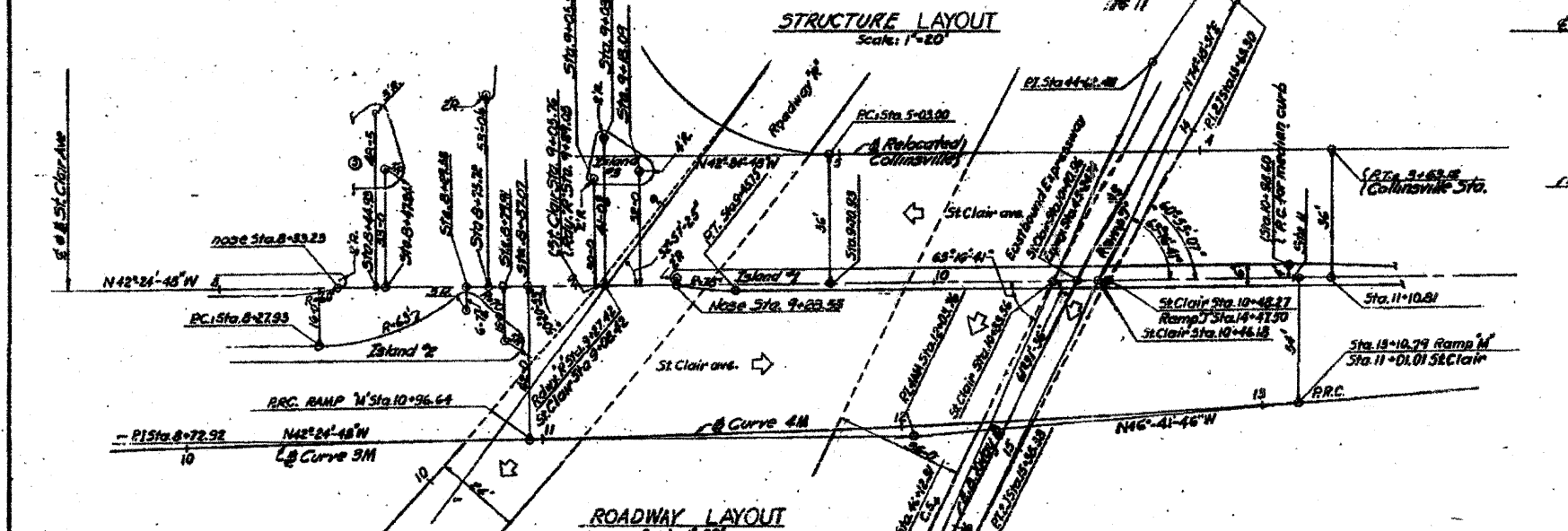

STATE OF ILLINOIS
 DEPARTMENT OF PUBLIC WORKS & BLDGS
 DIVISION OF HIGHWAYS
 &
 CITY OF EAST ST. LOUIS
EAST ST. LOUIS EXPRESSWAY
 ST. CLAIR AVE OVER EAST BOUND EXPRESSWAY
 AND ROADWAY 'R'

GENERAL GEOMETRIC LAYOUT
 N.W. LOCHNER, INC.
 ENGINEERS

DATE: MAY 2008 CHICAGO ILLINOIS SHEET NO. 2

Drawn By J.C.
 Checked By D.L.

FILE NAME = D8T1-082-0099-sht-pln02.dgn	USER NAME = patelp2	DESIGNED	REVISED -	STATE OF ILLINOIS DEPARTMENT OF TRANSPORTATION	EXISTING BRIDGE PLAN - ST. CLAIR AVENUE S.N. 082-0099	F.A. RTE.	SECTION	COUNTY	TOTAL SHEETS	SHEET NO.
		DRAWN PP	REVISED -			82-1-3HB, 82-2N, 82-1-12RS	ST. CLAIR	352	301B	
		CHECKED AB	REVISED -			9166/9180/9213/9214	CONTRACT NO. 76C51			
		DATE 03/31/2011	REVISED -			FED. ROAD DIST. NO. [ILLINOIS] FED. AID PROJECT				