

FOR INFORMATION ONLY

FILE NO. 082-0099
 COUNTY ST. CLAIR
 SHEET NO. 36

ELEV.	NO. 81	NO. 82	NO. 83
425	Ground Surface	Ground Surface	Ground Surface
420			
415	Elev. 416.6 brown sand & cinder fill 10	Elev. 417.1 br. med. to coarse sand & cinder fill 4	Elev. 417.9 brown fine sand & cinder fill 6
410	note "A" 5 note "B" 5	br. course sand - small gravel trace silt & wood 10 note "D" 7	soft clay & cinder fill 4 note "C" 7
405	medium brown clay w/silt & sand seams 5	brown & grey silty clay some fine sand 5	alt. layers stiff grey silty clay small gravel & fine sand 13 note "E" 10
400	brown fine silty sand 6	brown med. to coarse sand - trace silt 8	grey clayey silt & very fine sand 5
395	note "C" 3 brown very fine br. sand & silt 5	grey silt & very fine sand - trace clay 3	
390	brown very fine sand 17	brown fine sand 17	grey fine sand 24
385	some silt 16	trace silt & clay 22	some silt 24
380	20	grey fine sand 28	
375	25 brown & grey fine to med.	trace silt 28	grey fine to med. sand trace silt & small gravel 30
370	27 sand - trace silt &	Boring stopped by client	
365	30 - small gravel	Boring stopped by client	
ELEV. ± 0	Boring stopped by client		
	boring caved @ 9'-4" used 50'-0" of 2 1/2" casing date: 7/2-3/57.	water level 3'-9" below ground surface 24 hrs. after completion. used 43'-6" of 2 1/2" casing date: 7/1-2/57	boring caved @ 6'-0" used 43'-6" of 2 1/2" casing date: 7/3/57

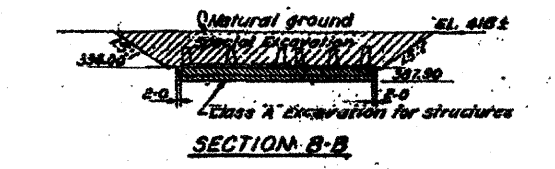
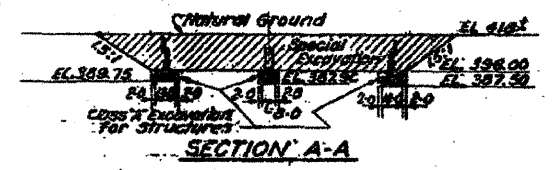
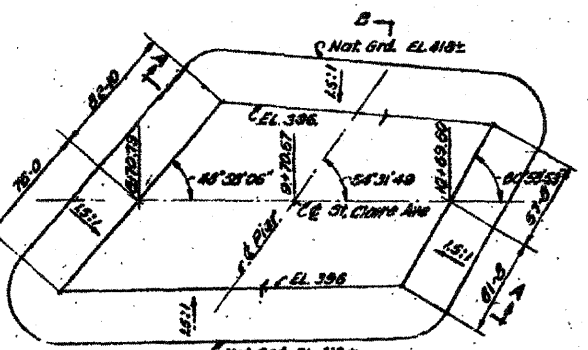
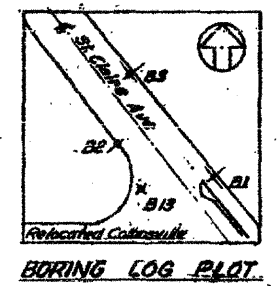

KEY
 WL Water Level
 * Indicates circulating lost in strata

GENERAL NOTES
 Classifications are made by visual inspection. Water levels indicated are those observed when borings were made, or as noted. Porosity of the soil strata, variations of rainfall, site topography, etc. may cause changes in these levels. Figures in right hand column indicate number of blows required to drive 2" O.D. sampling pipe one foot, using 140 lb. weight falling 30 inches.

Note "A"
 med. blue grey clay-trace fine sand & org. matter

Note "C"
 grey & brown med. silty clay w/some fine sand

Note "B"
 brown silt & very fine sand trace clay

Note "D"
 dark grey org. clayey silt trace wood & fine sand

Note "E"
 brown & grey fine to med. sand trace silt & small gravel

Boring stopped by client EL. 327
 Grey coarse sand with small gravel 12 to 25 blows per ft.
 Water level 40'-6" below ground surface 1 1/2 hrs. after completion. used 66'-6" of 2 1/2" casing. Date 3/14/58.

Drawn By F.L.
 Checked By J.C.S.

STATE OF ILLINOIS
 DEPARTMENT OF PUBLIC WORKS & BLDGS.
 DIVISION OF HIGHWAYS
 CITY OF EAST ST. LOUIS
 EAST ST. LOUIS EXPRESSWAY
 ST. CLAIR AVE. OVER EAST BOUND EXPRESSWAY AND ROADWAY R
 BORING LOGS
 H. W. LOCHNER, INC.
 ENGINEERS
 DATE: MAY 1957 CHICAGO, ILLINOIS SHEET NO. 3