

**OUTSIDE ELEVATION OF PARAPET**

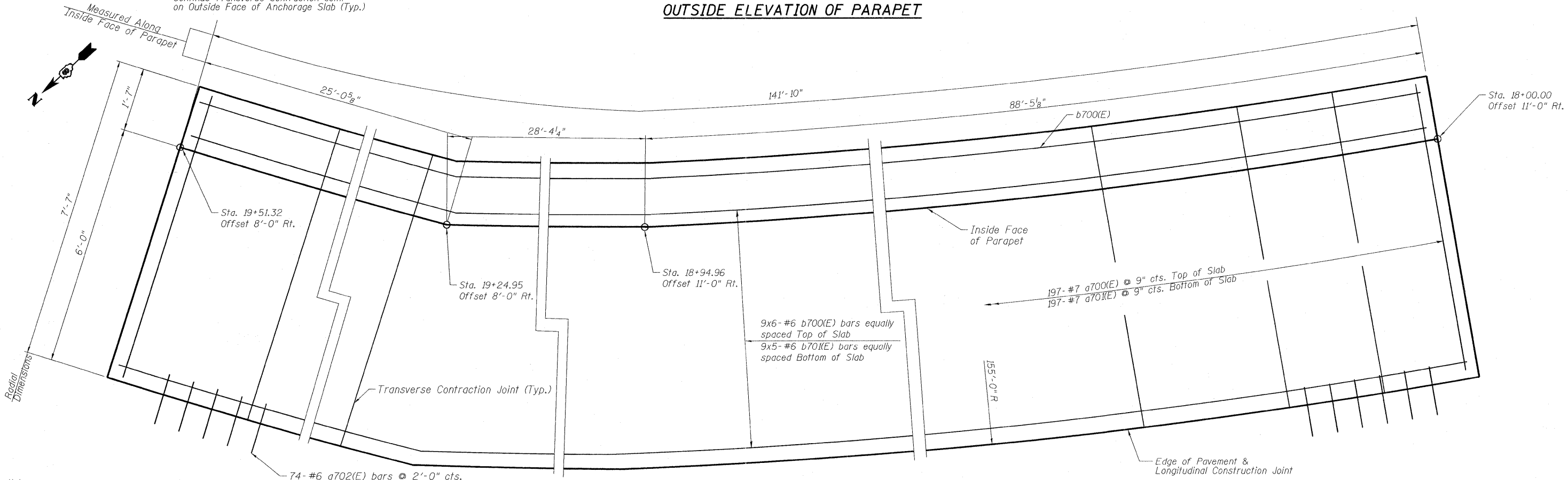

**PLAN - PARAPET AND ANCHORAGE SLAB**

(Offsets from  $\square$  Ramp P)

- Notes:
1. For Section A-A, see Sheet S-2.
  2. Optional full depth construction joints with  $\frac{1}{2}$ " chamfers may be provided in anchorages slab and parapet at 120' intervals and placed at a contraction joint location.
  3. Bars indicated thus 5x10-#6 etc. indicates 5 lines with 10 lengths per line.
  4. Bend bars in the field to fit.
  5. For drainage structure location, size and type see drainage sheets.

**MIN. BAR LAPS**

- #4 bars = 2'-0"
- #6 bars = 3'-0"
- #8 bars = 5'-2"

FILE NAME = D81r1-76C75-sht-MomentSlab-01.dgn	USER NAME = BhattA	DESIGNED DEV DRAWN JHR	REVISED - REVISED -	<b>STATE OF ILLINOIS DEPARTMENT OF TRANSPORTATION</b>	<b>PARAPET &amp; ANCHORAGE SLAB</b>	F.A. RTE. SECTION • 82-1-3HB, 82-2N, 82-1-12RS	COUNTY ST. CLAIR	TOTAL SHEETS 328	SHEET NO. 303A	
	PLOT SCALE = 20.0000' / 1"	CHECKED ATB	REVISED - REVISED -			SHEET NO. S-1 OF S-2 SHEETS	STA. 18+00.00 TO STA. 19+51.32	• 9166/9180/9213/9214	CONTRACT NO. 76C51	
	PLOT DATE = MAR. 31, 2011	DATE 3-31-11	REVISED -			FED. ROAD DIST. NO. ILLINOIS FED. AID PROJECT				