

|               |    |      |
|---------------|----|------|
| FINAL SURVEY  | BY | DATE |
| SURVEYED      |    |      |
| PLOTTED       |    |      |
| NOTE BOOK     |    |      |
| AREAS         |    |      |
| AREAS CHECKED |    |      |
| NO.           |    |      |

|                 |    |      |
|-----------------|----|------|
| ORIGINAL SURVEY | BY | DATE |
| SURVEYED        |    |      |
| PLOTTED         |    |      |
| NOTE BOOK       |    |      |
| AREAS           |    |      |
| AREAS CHECKED   |    |      |
| NO.             |    |      |

THOUGH EXISTING SEWERS ARE SHOWN, NO OTHER EXISTING UTILITIES ARE PROVIDED ON THE CROSS SECTIONS. PROPOSED SEWERS ARE BASED ON THE PROPOSED DRAINAGE DESIGN SHOWN WITHIN THESE PLANS. THE CONTRACTOR IS RESPONSIBLE FOR IDENTIFYING ALL EXISTING UTILITIES PRIOR TO CONSTRUCTION. THE CONTRACTOR SHALL REFER TO SIDE PLANS FOR EXISTING UTILITY INFORMATION.

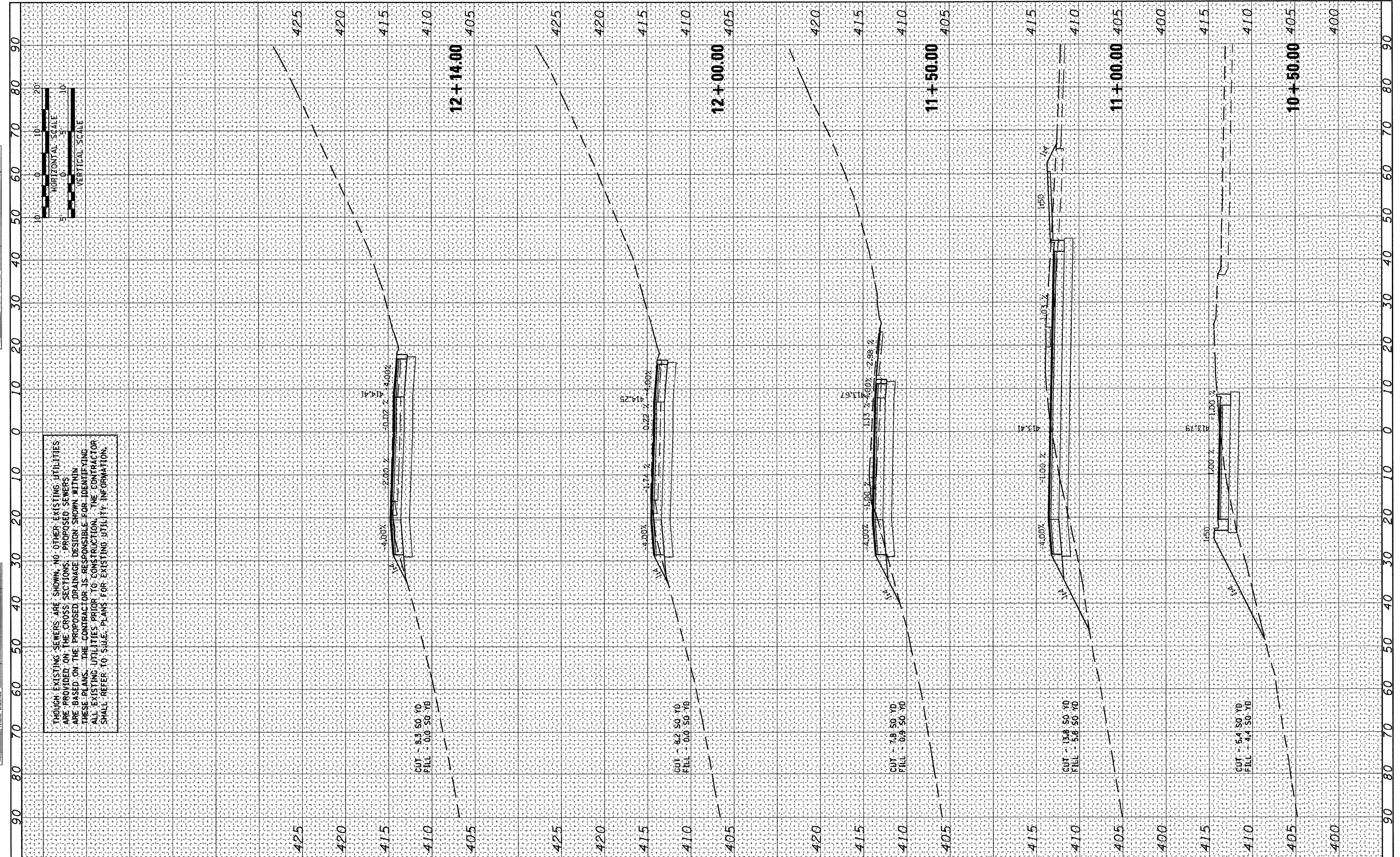

6/8/2011 11:37:13 AM  
 FILE NAME = D8TRI-76C51-sht-xs-23-26.dgn

|                                      |                 |           |
|--------------------------------------|-----------------|-----------|
| USER NAME = jlt                      | DESIGNED - LDC  | REVISED - |
| MODEL NAME = RampJ-RampI-xs.sheet-01 | DRAWN - JDF     | REVISED - |
| PLOT SCALE = 1:20                    | CHECKED - GEB   | REVISED - |
| PLOT DATE = 6/8/2011                 | DATE - 03/31/11 | REVISED - |

STATE OF ILLINOIS  
 DEPARTMENT OF TRANSPORTATION

RAMP "I" AND RAMP "J" CROSS SECTIONS

SCALE: 1"=10' SHEET NO. 23 OF 27 SHEETS STA. 10+50.00 TO STA. 12+14.00

|                     |                            |                    |              |           |
|---------------------|----------------------------|--------------------|--------------|-----------|
| F.A.J. RTE.         | SECTION                    | COUNTY             | TOTAL SHEETS | SHEET NO. |
| • FAI 64/9166/9180  | 82-1-3HB, 82-2N, 82-1-12RS | ST. CLAIR          | 352          | 325       |
| FED. ROAD DIST. NO. | ILLINOIS FED. AID PROJECT  | CONTRACT NO. 76C51 |              |           |