

DATE	
BY	
FINAL SURVEY	
SURVEYED	
PLOTTED	
NOTE BOOK	
TEMP. AREAS CHECKED	
NO.	

DATE	
BY	
ORIGINAL SURVEY	
SURVEYED	
PLOTTED	
NOTE BOOK	
TEMP. AREAS CHECKED	
NO.	

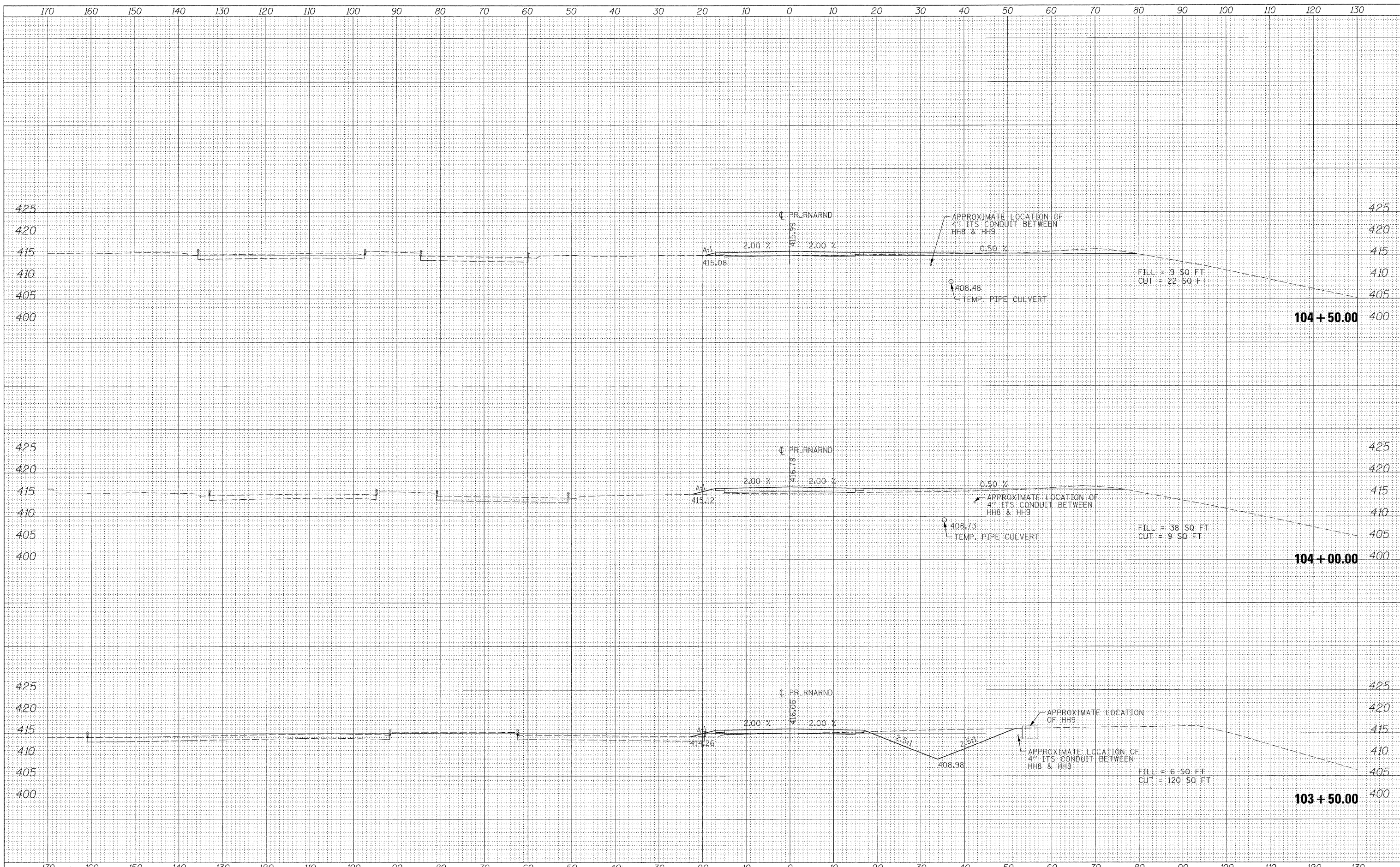

FILE NAME = D:\TRI-76C52-XS-SHT-RNARND.dgn

USER NAME = marcsk
 DESIGNED - KM
 DRAWN - KM
 CHECKED - DBM
 DATE - 08/18/2011

REVISED -
 REVISED -
 REVISED -
 REVISED -

**STATE OF ILLINOIS
 DEPARTMENT OF TRANSPORTATION**

RUNAROUND CROSS SECTIONS

SCALE: 1"=10' SHEET NO. 27A OF 27 SHEETS STA. 103+50.00 TO STA. 104+50.00

F.A. RTE.	SECTION	COUNTY	TOTAL SHEETS	SHEET NO.
	82-1-3HB, 82-2N, 82-1-12RS	ST. CLAIR	352	329A
	9166/9180/9213/9214.			CONTRACT NO. 76C51
ILLINOIS FED. AID PROJECT				