

FINAL SURVEY	BY	DATE
SURVEYED		
PLOTTED		
NOTE BOOK		
AREAS		
CHECKED		
NO.		

ORIGINAL SURVEY	BY	DATE
SURVEYED		
PLOTTED		
NOTE BOOK		
AREAS		
CHECKED		
NO.		

ALTHOUGH EXISTING SEWERS ARE SHOWN, NO OTHER EXISTING UTILITIES ARE PROVIDED ON THE CROSS SECTIONS. PROPOSED SEWERS ARE BASED ON THE PROPOSED DRAINAGE DESIGN SHOWN WITHIN THESE PLANS. THE CONTRACTOR IS RESPONSIBLE FOR IDENTIFYING ALL EXISTING UTILITIES PRIOR TO CONSTRUCTION. THE CONTRACTOR SHALL REFER TO SOU. PLANS FOR EXISTING UTILITY INFORMATION.

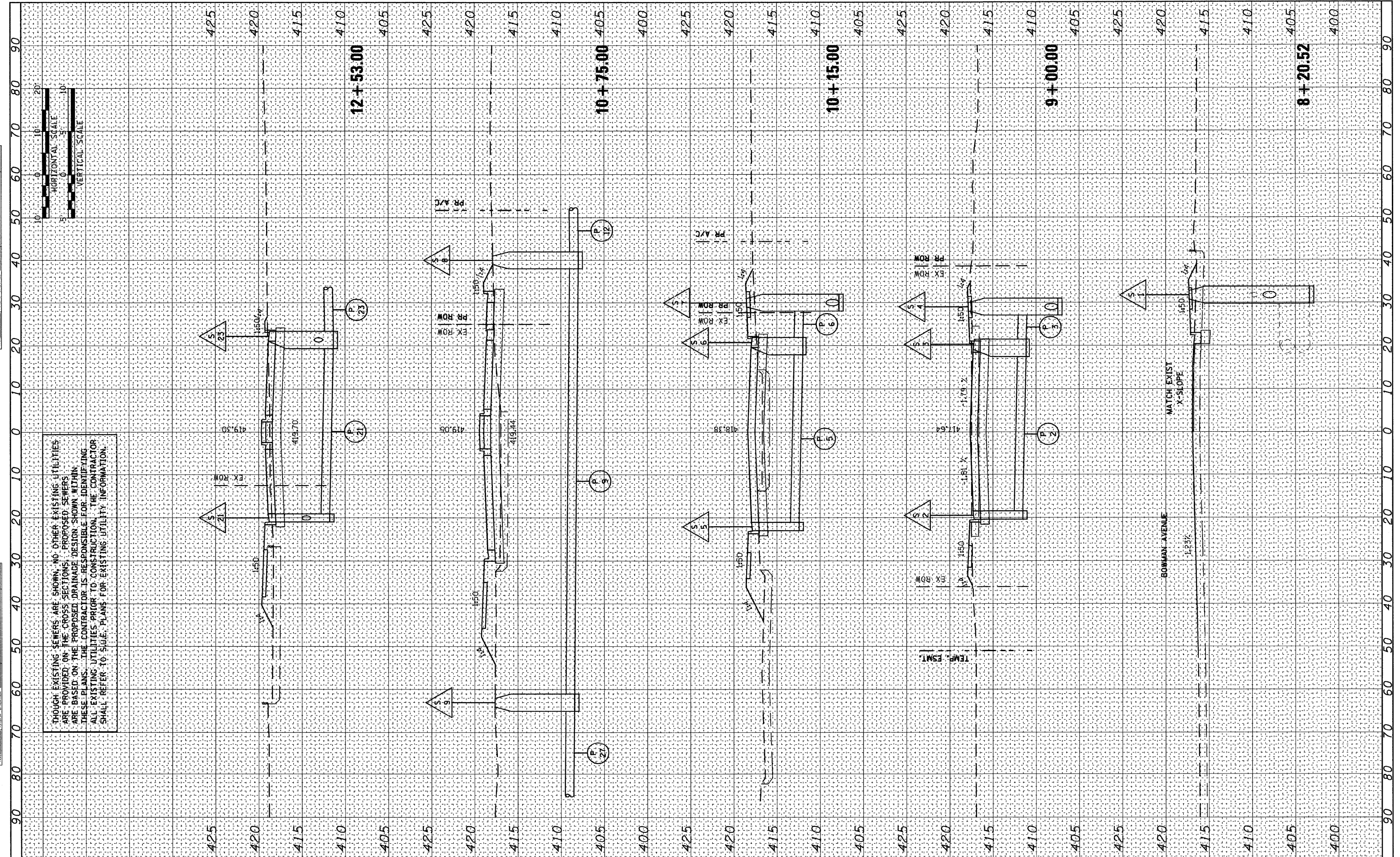

6/8/2011 11:31:33 AM
 FILE NAME = D8TRI-76C51-shr-xs-drn-01-03.dgn
 USER NAME = jlt
 MODEL NAME = 9th-xs-drainage-sheet-01
 PLOT SCALE = 1:20
 PLOT DATE = 6/8/2011

DESIGNED - LDC	REVISED -
DRAWN - JDF	REVISED -
CHECKED - GEB	REVISED -
DATE - 03/31/11	REVISED -

**STATE OF ILLINOIS
 DEPARTMENT OF TRANSPORTATION**

9TH STREET DRAINAGE CROSS SECTIONS

SCALE: 1"=10' SHEET NO. 1 OF 10 SHEETS STA. 8+20.52 TO STA. 12+53.00

F.A.J. RTE.	SECTION	COUNTY	TOTAL SHEETS	SHEET NO.
•	82-1-3HB, 82-2N, 82-1-12RS	ST. CLAIR	352	330
•	FAT 64/9166/9180			
FED. ROAD DIST. NO.	ILLINOIS FED. AID PROJECT			

P:\08-0030 CTE TRI LEVEL 900 CAD\901_DRAWING\08 CONTRACT SHEET\CIVIL\CROSSSECTIONS\08TRI-76C51-SH-XS-DRN-01-03.dgn