

THOUGH EXISTING SEWERS ARE SHOWN, NO OTHER EXISTING UTILITIES ARE PROVIDED ON THE CROSS SECTIONS. PROPOSED SEWERS ARE BASED ON THE PROPOSED DRAINAGE DESIGN SHOWN WITHIN THESE PLANS. THE CONTRACTOR IS RESPONSIBLE FOR IDENTIFYING ALL EXISTING UTILITIES PRIOR TO CONSTRUCTION. THE CONTRACTOR SHALL REFER TO S.U.E. PLANS FOR EXISTING UTILITY INFORMATION.

DATE	
BY	
FINAL SURVEY	
PLOTTED	
NOTE BOOK	
AREAS CHECKED	

DATE	
BY	
ORIGINAL SURVEY	
PLOTTED	
NOTE BOOK	
AREAS CHECKED	

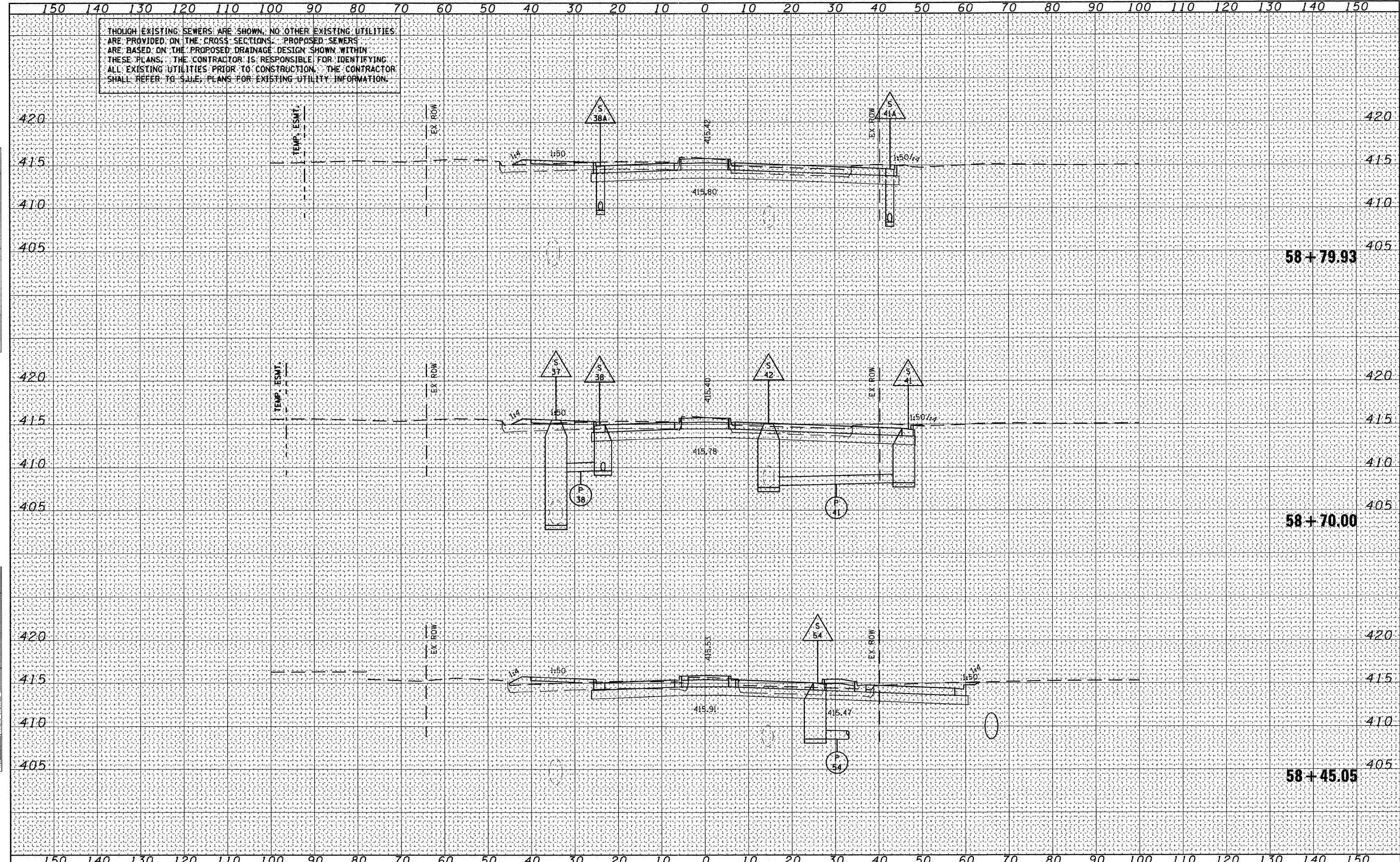

FILE NAME = D8TRI-76C51-sht-xs-drn-05-09.dgn
 USER NAME = jlt
 MODEL NAME = St.Clair-xs-drainage-sheet-02
 PLOT SCALE = 1:20
 PLOT DATE = 6/8/2011

DESIGNED	- LDC	REVISED	-
DRAWN	- JDF	REVISED	-
CHECKED	- GEB	REVISED	-
DATE	- 03/31/11	REVISED	-

STATE OF ILLINOIS
DEPARTMENT OF TRANSPORTATION

ST. CLAIR AVENUE DRAINAGE CROSS SECTIONS

SCALE: 1"=10' SHEET NO. 6 OF 10 SHEETS STA. 58+45.05 TO STA. 58+79.93

F.A.U. RTE.	SECTION	COUNTY	TOTAL SHEETS	SHEET NO.
• 82-1-3HB, 82-2N, 82-1-12RS		ST. CLAIR	352	335
• FAI 64/9166/9180				CONTRACT NO. 76C51
FED. ROAD DIST. NO.	ILLINOIS	FED. AID PROJECT		

P:\08-0030 CTE TRILEVEL\900_CAD\901_DRAWING\08_CONTRACT\SHEET\CIVIL\CROSSSECTION\08TRI-76C51-SHT-XS-DRN-05-09.DGN