

| F.A.U. RTE. | SECTION | COUNTY | TOTAL SHEETS | SHEET NO. |
|---------------------------------|----------|-----------|-----------------|-----------|
| * FAI 64/FAP 998 D-98-058-08 | 82-1-B-2 | ST. CLAIR | 399 | 1 |
| | | | * 399 + 5 = 404 | |

FOR INDEX OF SHEETS AND STANDARDS SEE SHEET NO. 2

STATE OF ILLINOIS
DEPARTMENT OF TRANSPORTATION

DIVISION OF HIGHWAYS
**PROPOSED
HIGHWAY PLANS**

VARIOUS ROUTES
SECTION 82-1-B-2
I-64 FROM 2ND STREET TO
COLLINSVILLE AVENUE
ST. CLAIR COUNTY
C-98-028-10

| NPDES PERMIT INFORMATION | |
|-------------------------------------|------------------|
| NPDES Disturbed | |
| Area = | 6.36 Acres |
| Approximate Location of Roadway is: | |
| Longitude | 90° 08' 16.87" W |
| Latitude | 38° 37' 38.02" N |

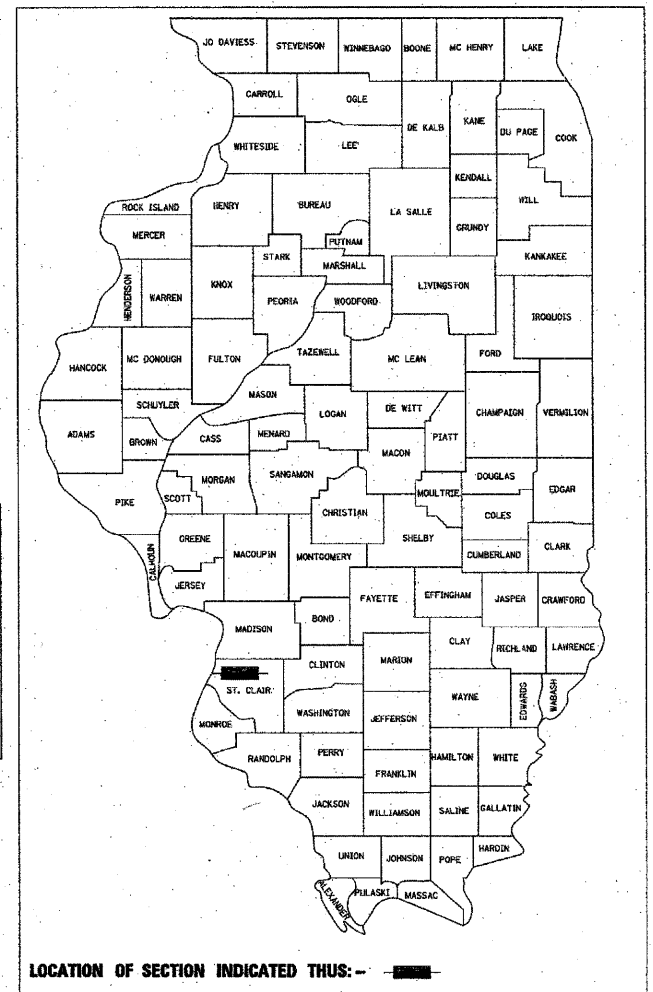

DESIGN DESIGNATIONS:

RAMP 70E55N: 19,350 (30) FREEWAY DIRECTIONAL RAMP 16.22(PCC-20)
RAMP 70E64E: 16,050 (30) FREEWAY DIRECTIONAL RAMP 26.91(PCC-20)
EB I-70: 32,900 (30) INTERSTATE 45.21(PCC-20)
RAMP P: 2,420 (30) FREEWAY DIRECTIONAL RAMP 11.17(PCC-20)

RAMP 70E55N:
DESIGN SPEED = 50 MPH /POSTED SPEED = 50 MPH

RAMP 70E64E:
DESIGN SPEED = 50 MPH /POSTED SPEED = 50 MPH

EB I-70:
DESIGN SPEED = 70 MPH /POSTED SPEED = 50 MPH

RAMP P
DESIGN SPEED = 25 MPH /POSTED SPEED = 25 MPH

DANNY B. MANOJLOSKI 7/1/11
062-051232 REGISTERED PROFESSIONAL ENGINEER OF ILLINOIS
DANNY B. MANOJLOSKI DATE 7/1/11
LICENSE EXPIRES 11/30/2011
SHEET RANGE 1-79, 93, 99-101, 369-371, 374-399
371A, 371B

ORANIT PIMSARN 7/1/11
062-062643 REGISTERED PROFESSIONAL ENGINEER OF ILLINOIS
ORANIT PIMSARN DATE 7/1/11
LICENSE EXPIRES 11/30/2011
SHEET RANGE 1-79, 93, 99-101, 369-371, 374-399
371A, 371B

JAMES P. COLEMAN 7/1/11
062-033912 REGISTERED PROFESSIONAL ENGINEER OF ILLINOIS
JAMES P. COLEMAN DATE 7/1/11
LICENSE EXPIRES 11/30/2011
SHEET RANGE 94-98

MICHAEL P. WALTON 7/1/11
062-049145 REGISTERED PROFESSIONAL ENGINEER OF ILLINOIS
MICHAEL P. WALTON DATE 7/1/11
LICENSE EXPIRES 11/30/2011
SHEET RANGE 102-127

DONALD D. BELL 07/01/11
081-004544 LICENSED STRUCTURAL ENGINEER OF ILLINOIS
DONALD D. BELL DATE 07/01/11
LICENSE EXPIRES 11/30/2012
SHEET RANGE 128-361B

AMISH T. BHATT 7/1/11
081-006249 LICENSED STRUCTURAL ENGINEER OF ILLINOIS
AMISH T. BHATT DATE 7/1/11
LICENSE EXPIRES 11/30/2012
SHEET RANGE 372-373

MICROFILMED _____
REEL NUMBER _____
AWARDED _____
RESIDENT ENGINEER _____
AS BUILT CHANGES WERE MADE ON THE FOLLOWING SHEETS _____

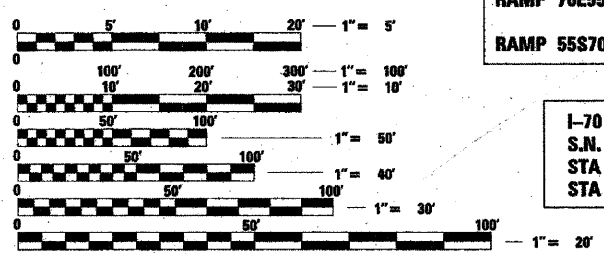

FULL SIZE PLANS HAVE BEEN PREPARED USING STANDARD ENGINEERING SCALES. REDUCED SIZED PLANS WILL NOT CONFORM TO STANDARD SCALES. IN MAKING MEASUREMENTS ON REDUCED PLANS, THE ABOVE SCALES MAY BE USED.

J.U.L.I.E.
JOINT UTILITY LOCATION INFORMATION FOR EXCAVATION
1-800-892-0123
or 811

PROJECT ENGINEER **MIKE PRITCHETT**
SQUAD LEADER **CHAD SANDERS**
CONTRACT NO. 76C76

I-70: STA 194+17.33 TO STA 196+35.37
RAMP 70E55N: STA 50+25.76 TO STA 51+92.00
STA 74+78.50 TO STA 78+50.00
RAMP 55S70W: STA 86+02.22 TO STA 87+70.02

I-70 OVER I-55, CSX & KCS RAILROADS
S.N. 082-0322 & 082-0324
STA 51+92.00 TO STA 74+78.50
STA 54+99.00 TO STA 64+93.50

RAMP 70E64E: (APPROACH SLAB)
STA 64+93.50 TO STA 65+23.50

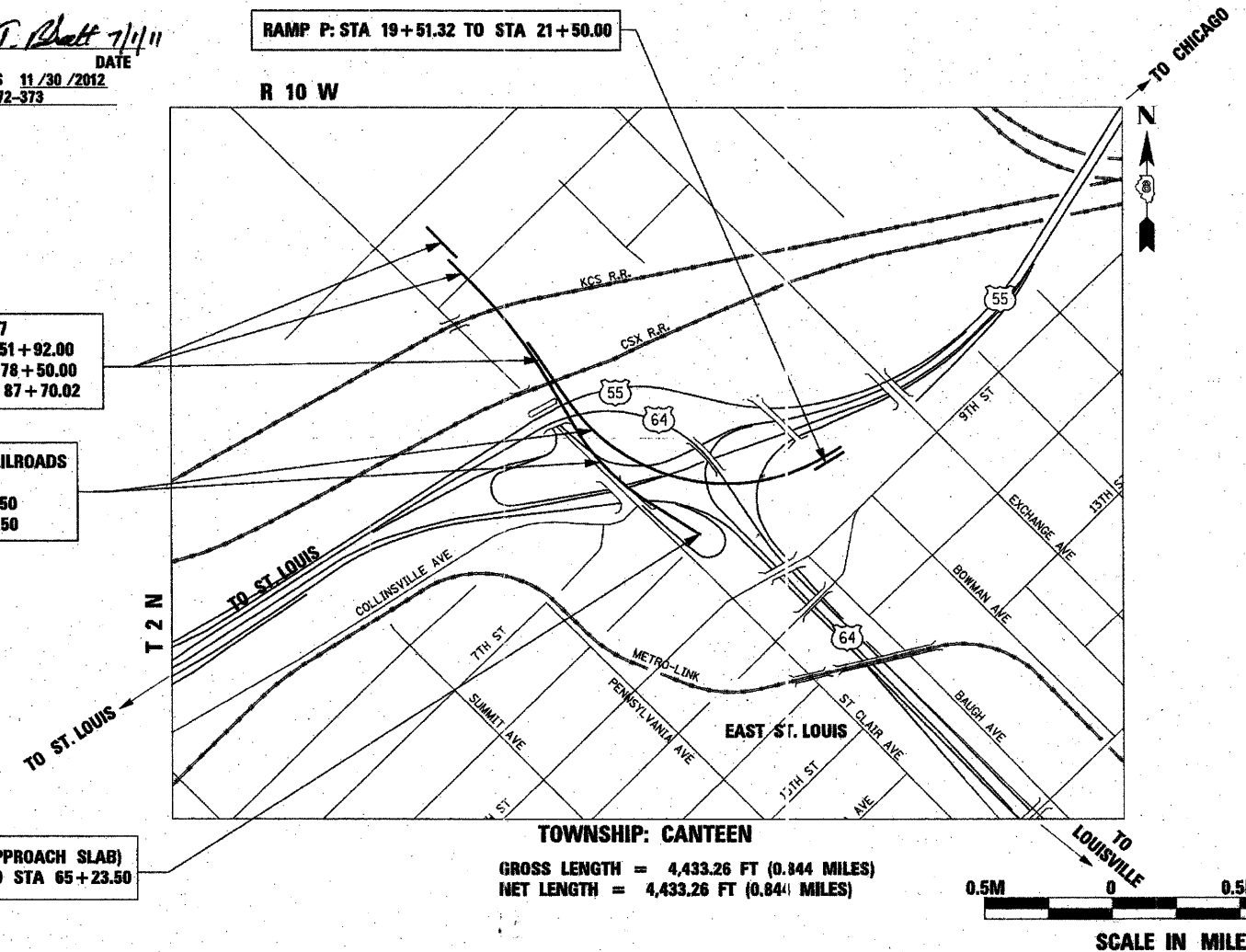

STATE OF ILLINOIS
DEPARTMENT OF TRANSPORTATION
DIVISION OF HIGHWAYS

SUBMITTED September 1, 2011
James M. Oman
DEPUTY DIRECTOR OF HIGHWAY, REGION ENGINEER

October 14, 2011
Scott E. Stitt
acting ENGINEER OF DESIGN AND ENVIRONMENT

October 14, 2011
Christine M. Reed
DIRECTOR OF HIGHWAYS, CHIEF ENGINEER

PRINTED BY THE AUTHORITY
OF THE STATE OF ILLINOIS

AECOM VOLKERT

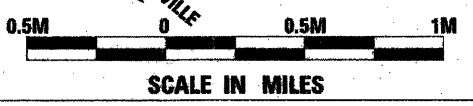

PLOT DATE: *DATE-TIME*