

MISCELLANEOUS REMOVAL

POINT	STA	O/S	NOTES
A	57+50.39	16.38' RT	BEGIN SIDEWALK REMOVAL
B	57+49.33	13.40' RT	BEGIN FENCE REMOVAL
C	57+32.33	1.03' RT	BEGIN PAVED DITCH REMOVAL, BEGIN PAVED DITCH (SPECIAL)
D	58+25.08	28.24' LT	END PAVED DITCH REMOVAL, END PAVED DITCH (SPECIAL)
E	58+53.60	7.00' LT	END SHOULDER REMOVAL
F	58+44.78	19.02' LT	BEGIN SHOULDER REMOVAL
G	58+01.59	2.53' RT	SHOULDER REMOVAL LIMIT
H	57+96.83	15.39' RT	END PAVEMENT REMOVAL
I	57+75.70	21.81' RT	BEGIN PAVEMENT REMOVAL
J	57+51.48	20.82' RT	BEGIN CONCRETE CURB REMOVAL
K	57+18.64	43.73' RT	BEGIN CONC CURB REMOVAL
L	57+85.83	30.86' RT	END CONC MEDIUM SURF REM, BEGIN SIDEWALK REMOVAL
M	57+88.14	37.52' RT	END CONC MEDIUM SURF REM, BEGIN SIDEWALK REMOVAL
N	58+04.29	36.56' RT	END CONC CURB REMOVAL
O	58+11.64	30.28' RT	END SIDEWALK REMOVAL
P	58+07.03	30.37' RT	BEGIN FENCE REMOVAL
Q	58+11.60	29.90' RT	END FENCE REMOVAL
R	58+21.44	17.98' RT	END CONC REM REMOVAL

POINT	STA	O/S	NOTES
S	61+41.32	29.96' RT	BEGIN SHOULDER REMOVAL
T	61+81.88	2.93' RT	END SHOULDER REMOVAL
U	61+42.41	31.63' RT	BEGIN PAVEMENT REMOVAL
V	61+82.97	4.61' RT	END PAVEMENT REMOVAL
W	57+59.76	31.84' LT	PI PAVED DITCH (SPECIAL)
X	57+84.82	39.85' LT	PI PAVED DITCH (SPECIAL)

NOTES:
ALL STATIONS AND OFFSETS ARE TAKEN OF RAMP 70E64E

EXISTING RETAINING WALL PILES ARE IMPACTED BY PIER 9 DRILLED SHAFT CONSTRUCTION - SEE STRUCTURAL PLANS FOR SOIL NAILS DETAILS FOR EXISTING RETAINING WALL

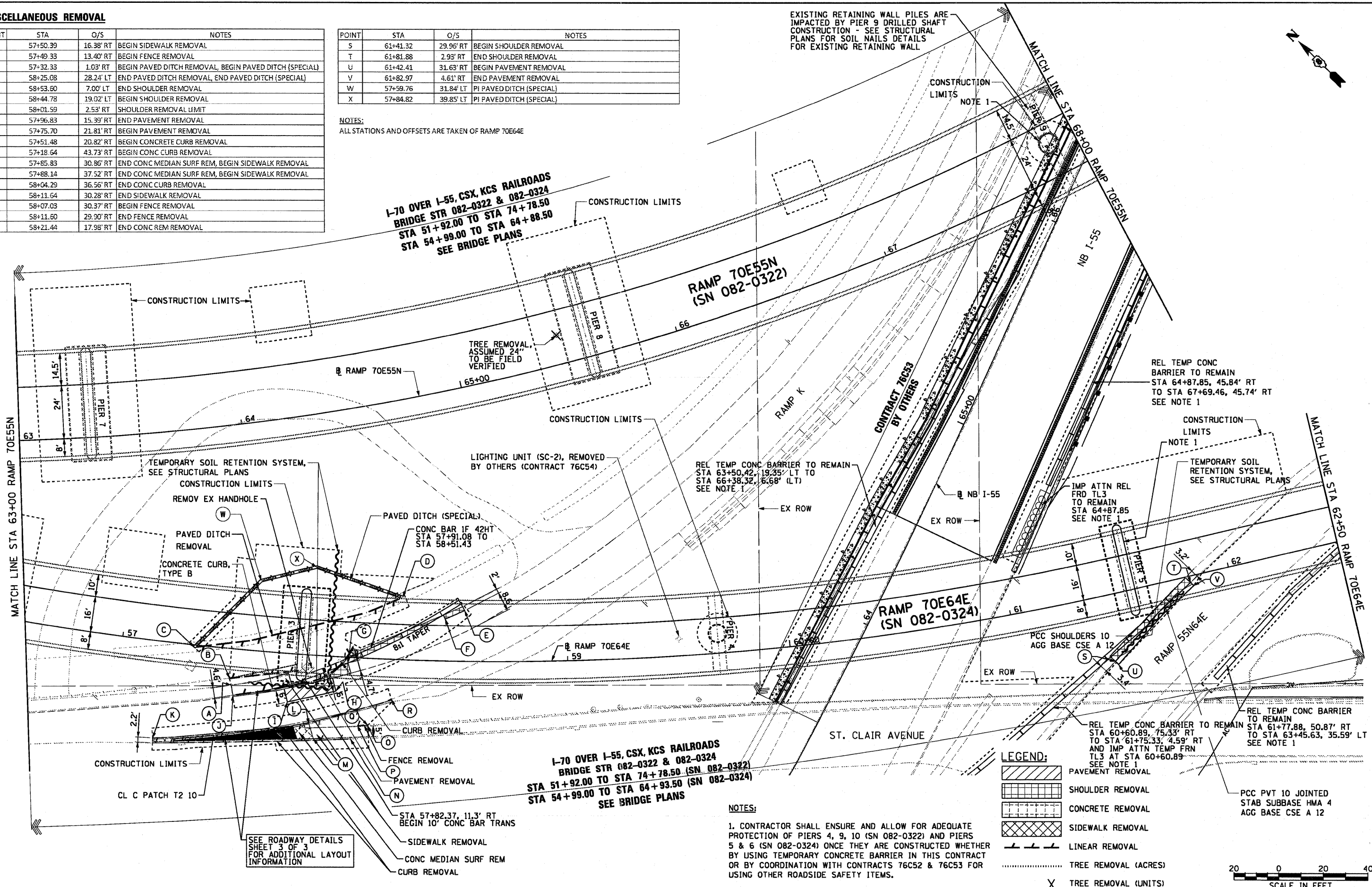
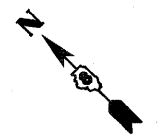

I-70 OVER I-55, CSX, KCS RAILROADS
BRIDGE STR 082-0322 & 082-0324
STA 51+92.00 TO STA 74+78.50 (SN 082-0322)
STA 54+99.00 TO STA 64+93.50 (SN 082-0324)
SEE BRIDGE PLANS

LEGEND:

	PAVEMENT REMOVAL
	SHOULDER REMOVAL
	CONCRETE REMOVAL
	SIDEWALK REMOVAL
	LINEAR REMOVAL
	TREE REMOVAL (ACRES)
	TREE REMOVAL (UNITS)

PCC PVT 10 JOINTED STAB SUBBASE HMA 4 AGG BASE CSE A 12

NOTES:
1. CONTRACTOR SHALL ENSURE AND ALLOW FOR ADEQUATE PROTECTION OF PIERS 4, 9, 10 (SN 082-0322) AND PIERS 5 & 6 (SN 082-0324) ONCE THEY ARE CONSTRUCTED WHETHER BY USING TEMPORARY CONCRETE BARRIER IN THIS CONTRACT OR BY COORDINATION WITH CONTRACTS 76C52 & 76C53 FOR USING OTHER ROADSIDE SAFETY ITEMS.



USER NAME = pimarno	DESIGNED OP	REVISED -
PLDT SCALE = 1/4" = 20'	DRAWN PHP	REVISED -
PLDT DATE = 8/9/2011	CHECKED DBM	REVISED -
	DATE 08-12-11	REVISED -

STATE OF ILLINOIS
DEPARTMENT OF TRANSPORTATION

ROADWAY PLAN
RAMP 70E55N/RAMP 70E64E
 SCALE: 1" = 20' SHEET NO. 4 OF 7 SHEETS STA. 63+00 TO STA. 68+00

F.A.I. RTE.	SECTION	COUNTY	TOTAL SHEETS	SHEET NO.
64/998	82-1-B-2	ST. CLAIR	399	26
FED. ROAD DIST. NO.	ILLINOIS FED. AID PROJECT		CONTRACT NO. 76C76	

FILE NAME = P:\6804662\91920_CAD\901.Drawings\76C76.Contract\Sheet\Civil\Roadway_Plans\0817-76C76-shd-plan-04.dgn