

I-70 OVER I-55, CSX, KCS RAILROADS  
 BRIDGE STR 082-0322 & 082-0324  
 STA 51+92.00 TO STA 74+78.50 (SN 082-0322)  
 STA 54+99.00 TO STA 64+93.50 (SN 082-0324)  
 SEE BRIDGE PLANS

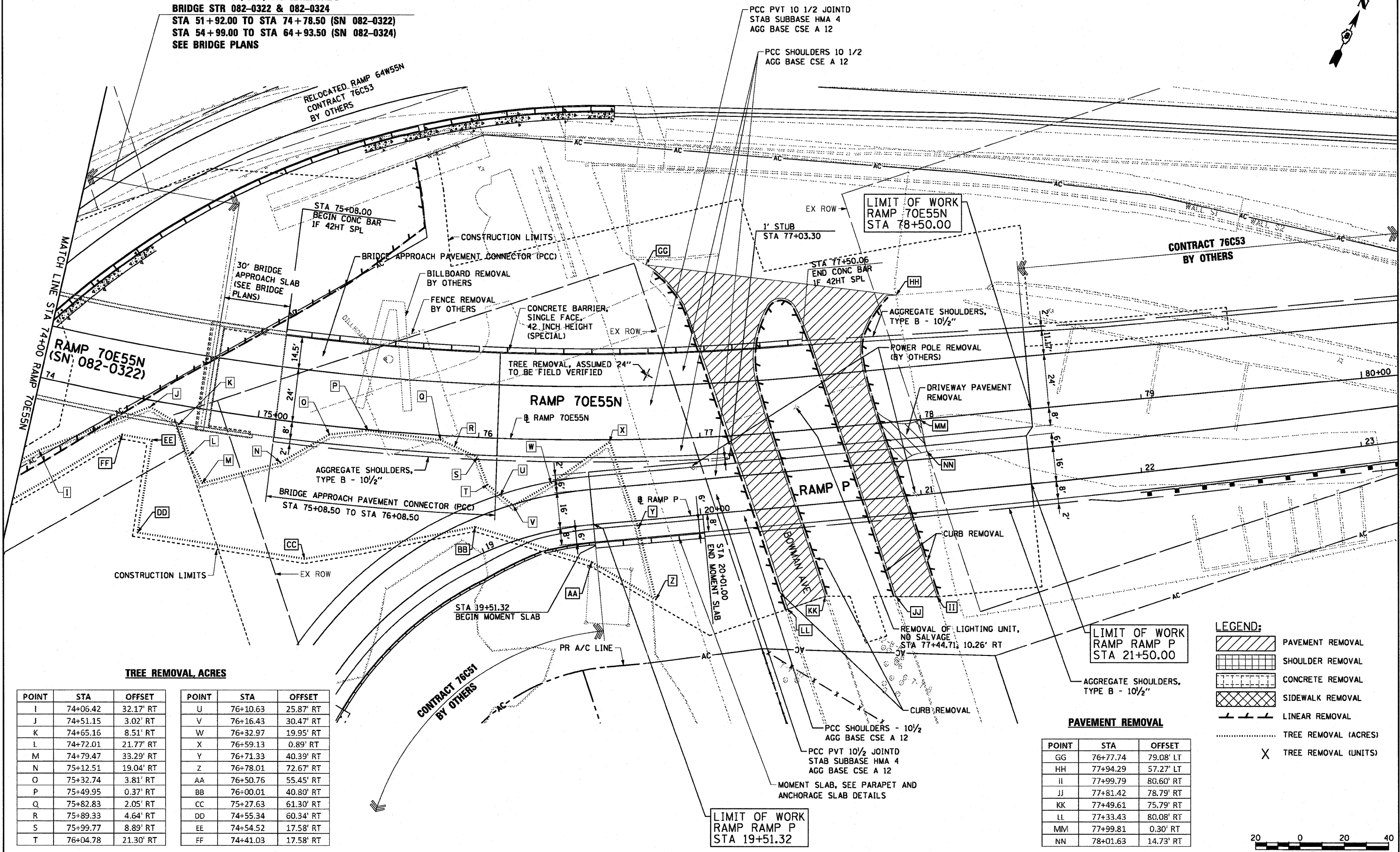
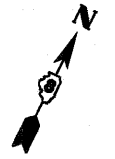

**TREE REMOVAL, ACRES**

POINT	STA	OFFSET	POINT	STA	OFFSET
I	74+06.42	32.17' RT	U	76+10.63	25.87' RT
J	74+51.15	3.02' RT	V	76+16.43	30.47' RT
K	74+65.16	8.51' RT	W	76+32.97	19.95' RT
L	74+72.01	21.77' RT	X	76+59.13	0.89' RT
M	74+79.47	33.29' RT	Y	76+71.33	40.39' RT
N	75+12.51	19.04' RT	Z	76+78.01	72.67' RT
O	75+32.74	3.81' RT	AA	76+50.76	55.45' RT
P	75+49.95	0.37' RT	BB	76+00.01	40.80' RT
Q	75+82.83	2.05' RT	CC	75+27.63	61.30' RT
R	75+89.33	4.64' RT	DD	74+55.34	60.34' RT
S	75+99.77	8.89' RT	EE	74+54.52	17.58' RT
T	76+04.78	21.30' RT	FF	74+41.03	17.58' RT

**LEGEND:**

- PAVEMENT REMOVAL
- SHOULDER REMOVAL
- CONCRETE REMOVAL
- SIDEWALK REMOVAL
- LINEAR REMOVAL
- TREE REMOVAL (ACRES)
- TREE REMOVAL (UNITS)

**PAVEMENT REMOVAL**

POINT	STA	OFFSET
GG	76+77.74	79.08' LT
HH	77+94.29	57.27' LT
II	77+99.79	80.60' RT
JJ	77+81.42	78.79' RT
KK	77+49.61	75.79' RT
LL	77+33.43	80.08' RT
MM	77+99.81	0.30' RT
NN	78+01.63	14.73' RT



USER NAME = searsb	DESIGNED OP	REVISED -
DRAWN PHP	REVISED -	
CHECKED DBM	REVISED -	
DATE 07-01-11	REVISED -	

STATE OF ILLINOIS  
 DEPARTMENT OF TRANSPORTATION

ROADWAY PLAN  
 RAMP 70E55N

SCALE: 1" = 20' SHEET NO. 6 OF 7 SHEETS STA. 74+00 TO STA. 75+41.52

F.A.I. RTE.	SECTION	COUNTY	TOTAL SHEETS	SHEET NO.
64/998	82-1-B-2	ST. CLAIR	399	28
FED. ROAD DIST. NO. ILLINOIS FED. AID PROJECT			CONTRACT NO. 76C76	

FILE NAME = P:\P62046609\900\_CAD\901\_Drawings\76C76\_Contract\Sheet\Civil\Roadway\_Plans\081-76C76-shr-plan-06.dgn