

PLAN	SURVEYED	BY	DATE
	ALIGNED		
	CHECKED		
	RT. OF WAY		
	CHECKED		
	NO. _____		
	PAID FILE NAME		

PROFILE	SURVEYED	BY	DATE
	GRADES		
	CHECKED		
	S.M. NOTED		
	STRUCTURE		
	NOTATIONS		
	CHRD		
	NO. _____		

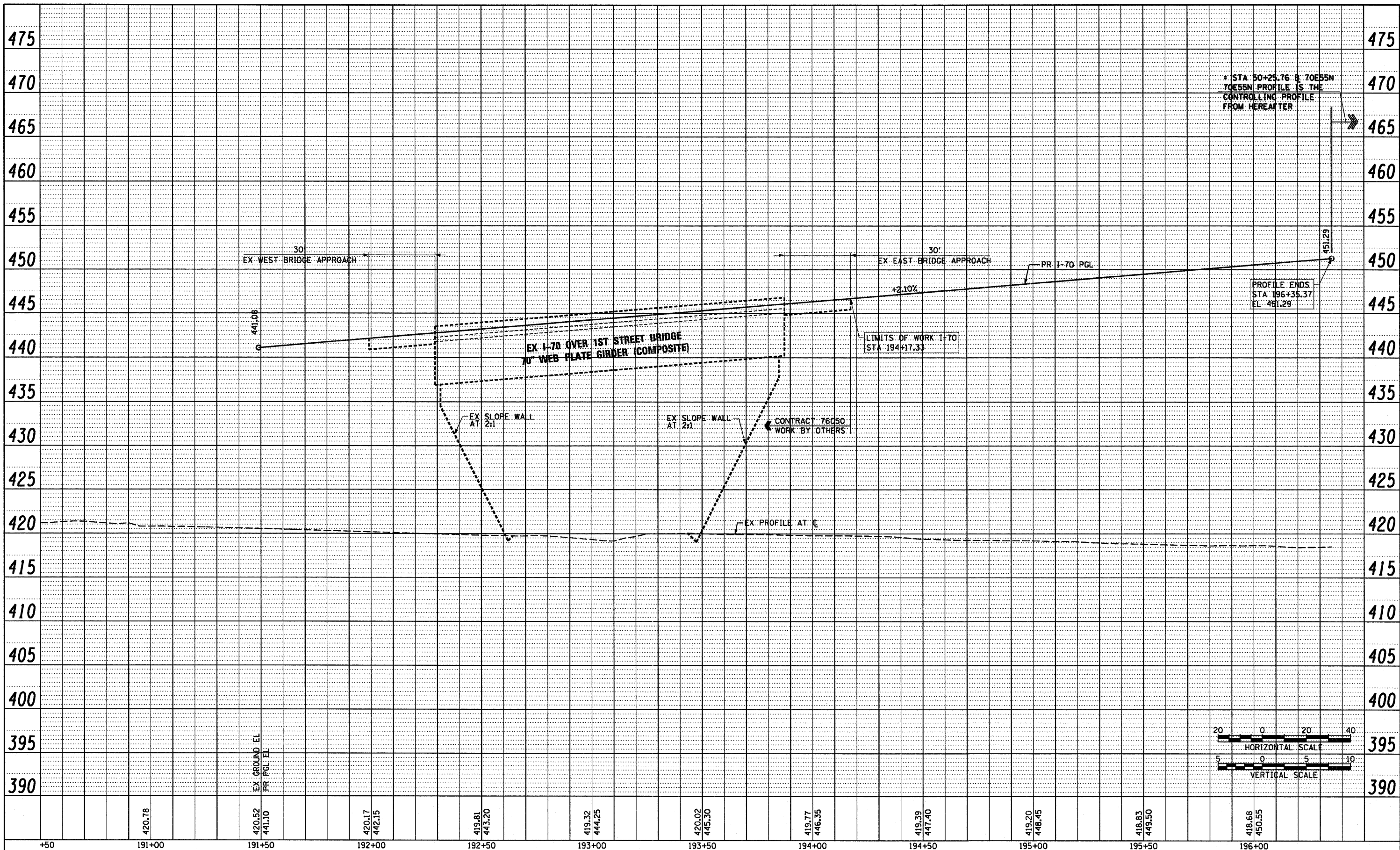

* STA 50+25.76 @ 70E55N
70E55N PROFILE IS THE
CONTROLLING PROFILE
FROM HEREATER

PROFILE ENDS
STA 196+35.37
EL 451.29

LIMITS OF WORK I-70
STA 194+17.33

CONTRACT 76C50
WORK BY OTHERS

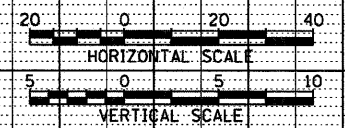

+50	191+00	191+50	192+00	192+50	193+00	193+50	194+00	194+50	195+00	195+50	196+00
-----	--------	--------	--------	--------	--------	--------	--------	--------	--------	--------	--------

PROPOSED I-70

USER NAME = searsb	DESIGNED OP	REVISED -	STATE OF ILLINOIS DEPARTMENT OF TRANSPORTATION	ROADWAY PROFILE I-70		F.A.I. RTE. 64/998	SECTION 82-1-B-2	COUNTY ST. CLAIR	TOTAL SHEETS 399	SHEET NO. 30	
PLDT SCALE = 48.0000' / in.	DRAWN OP	REVISED -		SCALE: H: 20 V: 5	SHEET NO. 1 OF 1 SHEETS	STA. 190+92.60 TO STA. 196+35.36	FED. ROAD DIST. NO.	ILLINOIS FED. AID PROJECT			
PLDT DATE = 6/30/2011	CHECKED DBM	REVISED -									
	DATE 07-01-11	REVISED -									

FILE NAME = P:\P68846689\988.CAD\981.Drawings\76C76.Contract\Sheet\Civil\Roadway\Plans\081-76C76-sht-Profile-178-01.dgn