

PLAN	DATE
BY	
NO.	
NO.	
NO.	
NO.	

PROFILE	DATE
BY	
NO.	
NO.	
NO.	
NO.	

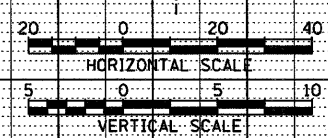
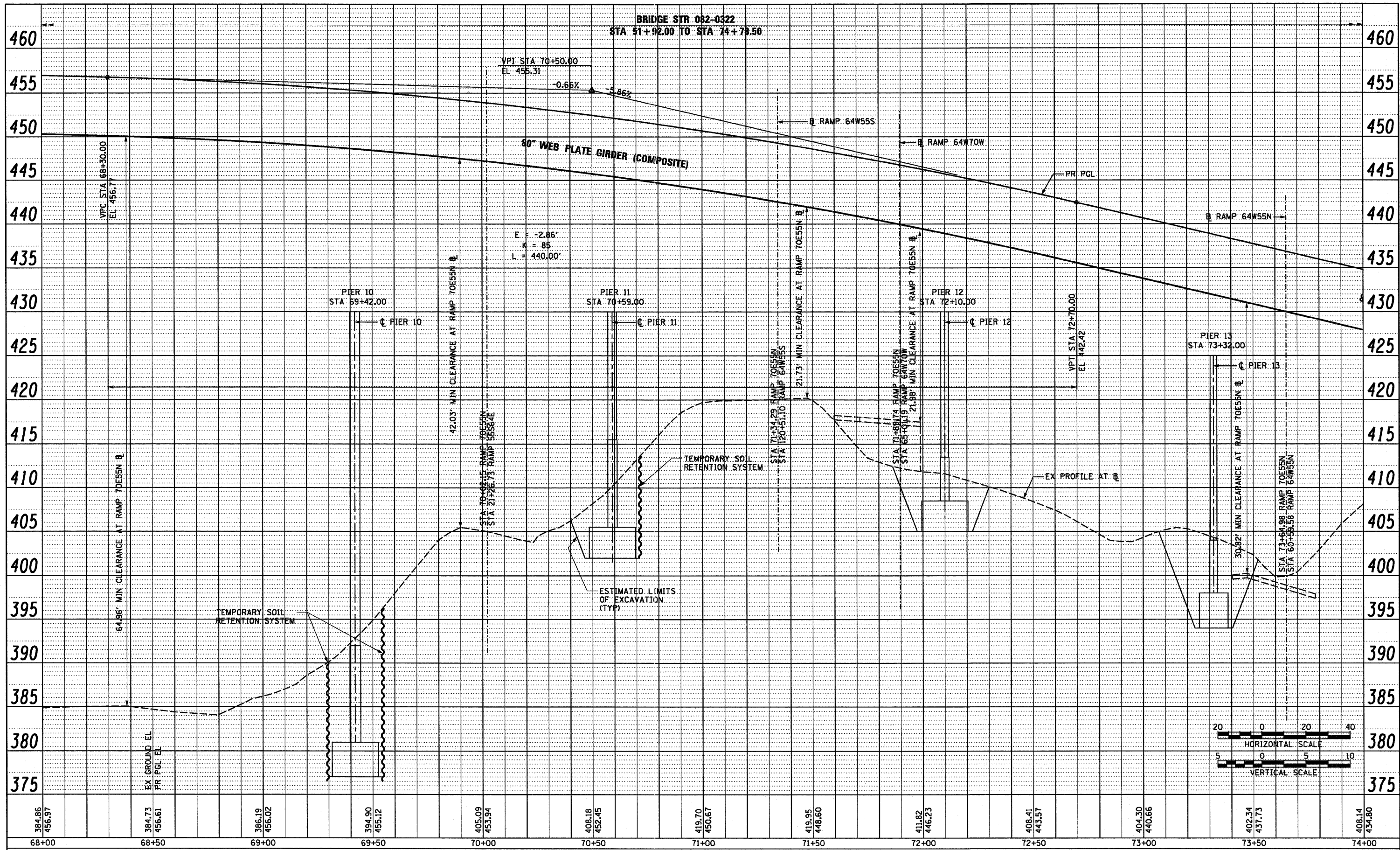

PROPOSED RAMP 70E55N

USER NAME = pimsarno	DESIGNED OP	REVISED -
	DRAWN PHP	REVISED -
PLOT SCALE = 40,0000' / in.	CHECKED DBM	REVISED -
PLOT DATE = 8/9/2011	DATE 08-12-11	REVISED -

**STATE OF ILLINOIS
DEPARTMENT OF TRANSPORTATION**

**ROADWAY PROFILE
RAMP 70E55N**

SCALE: H: 20 V: 5 SHEET NO. 4 OF 5 SHEETS STA. 68+00 TO STA. 74+00

F.A.I. RTE. 64/998	SECTION 82-1-B-2	COUNTY ST. CLAIR	TOTAL SHEETS 399	SHEET NO. 34
FED. ROAD DIST. NO.		ILLINOIS FED. AID PROJECT		
		CONTRACT NO. 76C76		

FILE NAME = P:\P68046609\9208_CAD\981_Drawings\76C76_Contract\Sheet\Civil\Roadway\Plans\081-1-76C76-shr-Profile-70E55N-04.dgn