

DATE	
BY	
REVIEWED	
PLANNED	
ALIGNED	
CHECKED	
NO. _____	
NO. _____	
NO. _____	

DATE	
BY	
REVIEWED	
PLANNED	
CHECKED	
NO. _____	
NO. _____	
NO. _____	

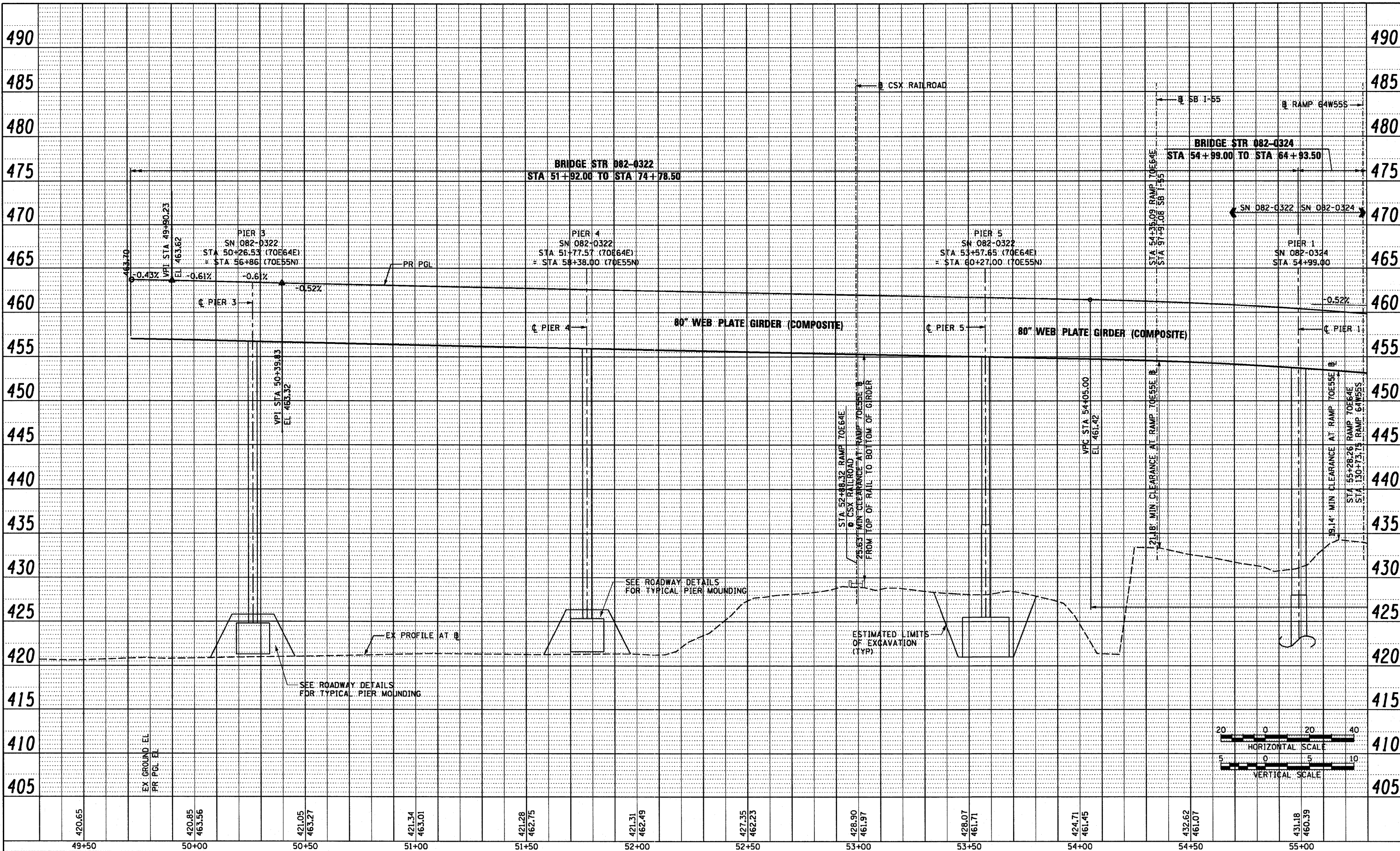

420.65		420.85	463.56	421.05	463.27	421.34	463.01	421.28	462.75	421.31	462.49	421.35	462.23	428.90	461.57	428.07	461.71	424.71	461.45	432.62	461.07	431.18	460.39
49+50		50+00		50+50		51+00		51+50		52+00		52+50		53+00		53+50		54+00		54+50		55+00	

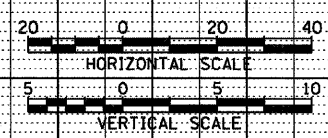

PROPOSED RAMP 70E64E

USER NAME = searab	DESIGNED OP	REVISED -
PLANNED PHP	DRAWN PHP	REVISED -
CHECKED DBM	DATE 07-01-11	REVISED -
PLLOT SCALE = 40.0000' / in.		
PLLOT DATE = 6/30/2011		

**STATE OF ILLINOIS
DEPARTMENT OF TRANSPORTATION**

ROADWAY PROFILE		RAMP 70E64E	
SCALE: H: 20 V: 5	SHEET NO. 1 OF 3 SHEETS	STA. 49+30 TO STA. 55+30	

F.A.I. RTE.	SECTION	COUNTY	TOTAL SHEETS	SHEET NO.
64/998	82-1-B-2	ST. CLAIR	399	36
CONTRACT NO. 76C76				
ILLINOIS FED. AID PROJECT				

FILE NAME = P:\P62046689\9000_CAD\901_Drawings\76C76_Contract\Sheet\Civil\Roadway\Plans\081-76C76-ht-Profile-70E64E-01.dgn