

PLAN	DATE	BY
NO.		
NO.		
NO.		

PROFILE	DATE	BY
NO.		
NO.		
NO.		

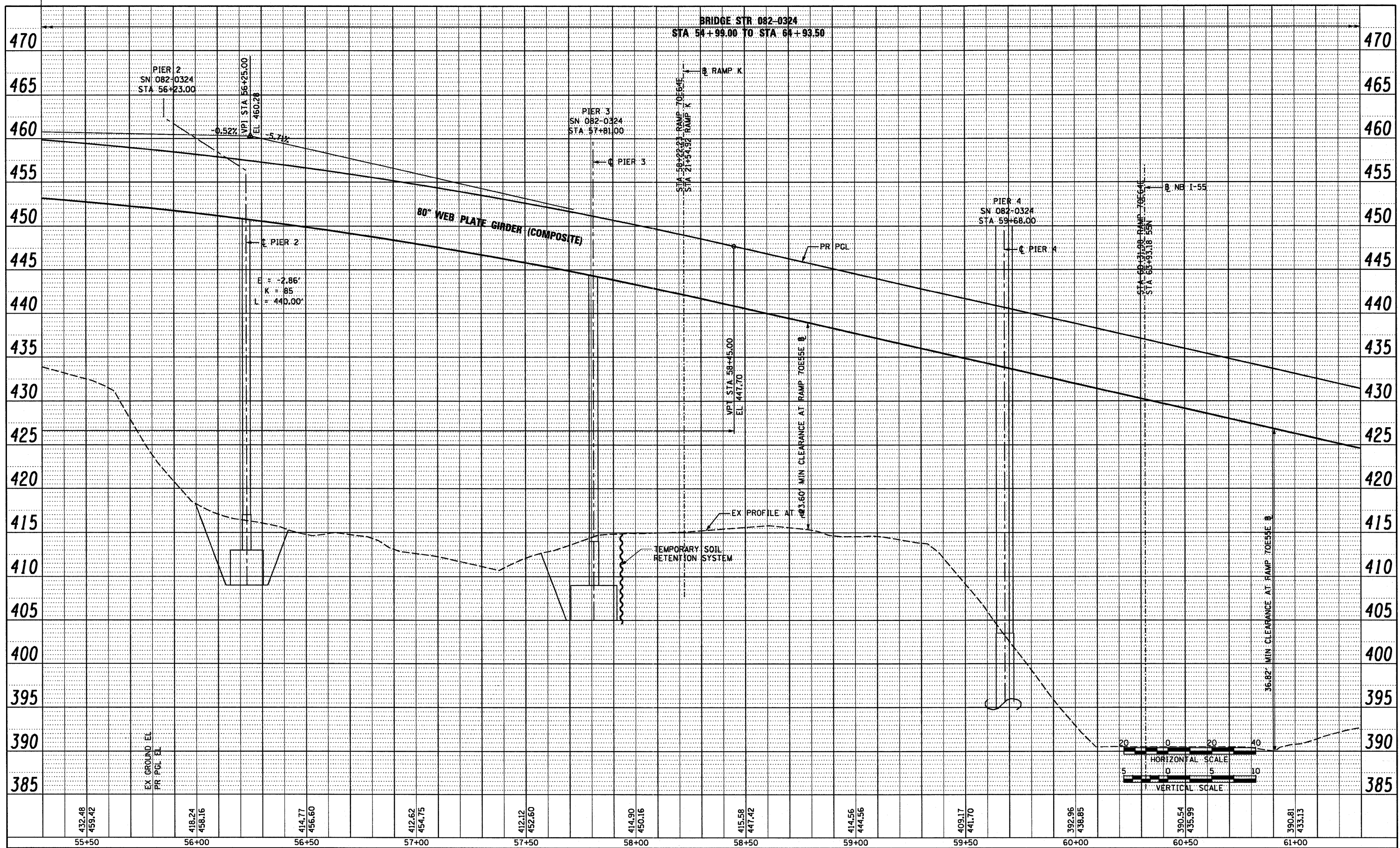

PROPOSED RAMP 70E64E

USER NAME = pimsarno	DESIGNED OP	REVISED -
PLDT SCALE = 40.0000' / in.	DRAWN OP	REVISED -
PLDT DATE = 8/9/2011	CHECKED DBM	REVISED -
	DATE 08-12-11	REVISED -

**STATE OF ILLINOIS
DEPARTMENT OF TRANSPORTATION**

**ROADWAY PROFILE
RAMP 70E64E**

F.A.I. RTE. 64/998	SECTION 82-1-B-2	COUNTY ST. CLAIR	TOTAL SHEETS 399	SHEET NO. 37
FED. ROAD DIST. NO.		ILLINOIS FED. AID PROJECT		

SCALE: H: 20 V: 5 SHEET NO. 2 OF 3 SHEETS STA. 55+30 TO STA. 61+30