

PLAN	DATE
BY	
NO.	
DATE	
BY	
NO.	
DATE	
BY	
NO.	
DATE	
BY	
NO.	
DATE	

PROFILE	DATE
BY	
NO.	
DATE	
BY	
NO.	
DATE	
BY	
NO.	
DATE	
BY	
NO.	
DATE	

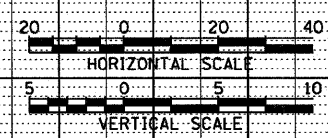
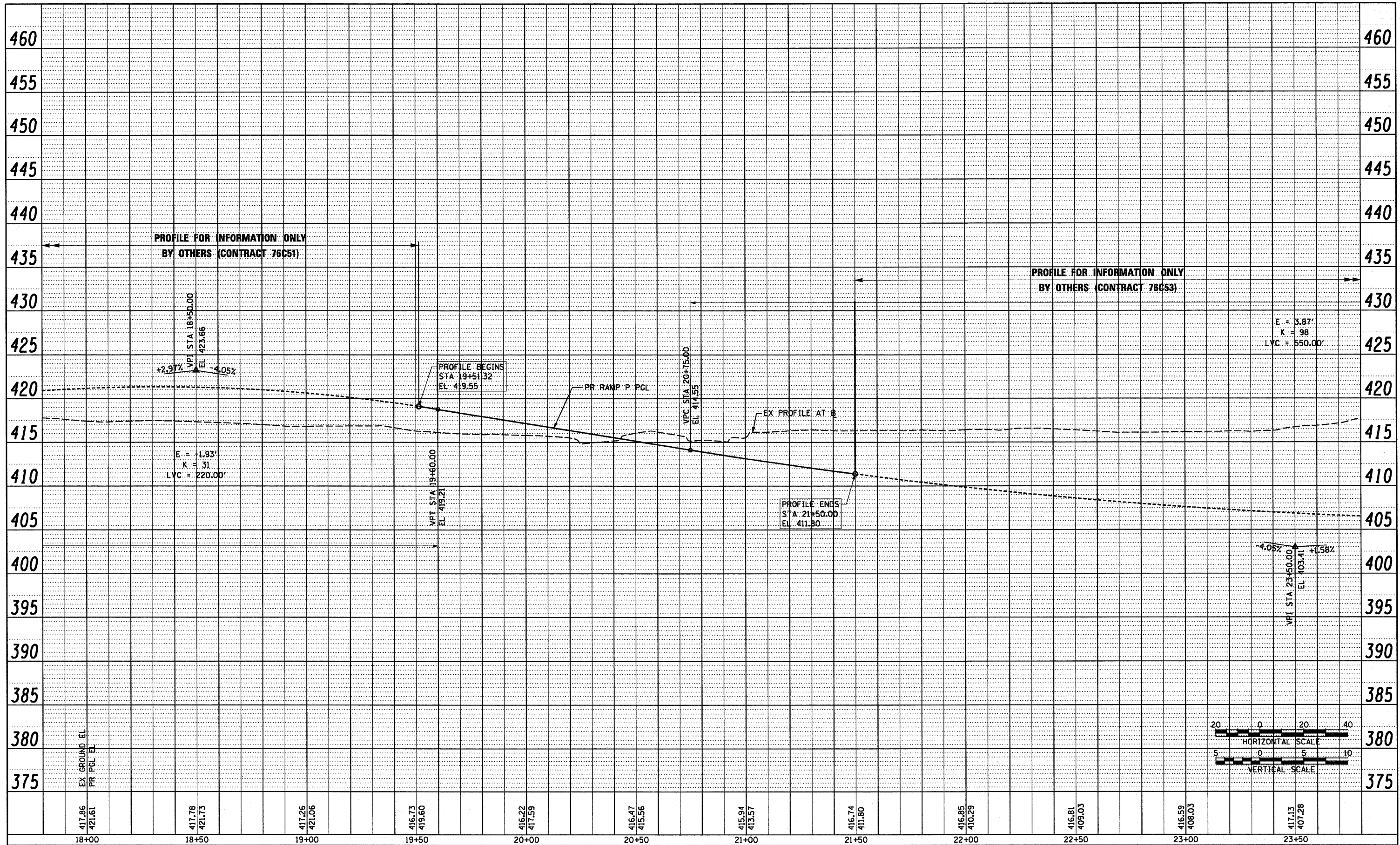

417.86 EX GROUND EL	417.78 PR POL EL	417.26 PR POL EL	416.73 PR POL EL	416.22 PR POL EL	415.94 PR POL EL	415.74 PR POL EL	415.85 PR POL EL	416.81 PR POL EL	416.59 PR POL EL	417.13 PR POL EL	
421.61	421.73	421.06	419.60	417.59	415.56	413.57	411.80	409.03	408.03	407.28	
18+00	18+50	19+00	19+50	20+00	20+50	21+00	21+50	22+00	22+50	23+00	23+50

PROPOSED RAMP P

USER NAME = searab	DESIGNED OP	REVISED -	STATE OF ILLINOIS DEPARTMENT OF TRANSPORTATION	ROADWAY PROFILE RAMP P		F.A.I. RTE. 64/998	SECTION 82-1-B-2	COUNTY ST. CLAIR	TOTAL SHEETS 399	SHEET NO. 40	
PLDT SCALE = 48.0000' / in.	DRAWN OP	REVISED -		SCALE: Ht 20 Vt 5	SHEET NO. 1 OF 1 SHEETS	STA. 19+51.32 TO STA. 21+50.00	FED. ROAD DIST. NO.	ILLINOIS FED. AID PROJECT	CONTRACT NO. 76C76		
PLDT DATE = 6/30/2011	CHECKED DBM	REVISED -									
	DATE 07-01-11	REVISED -									

FILE NAME = P:\P68846689\988_CAD\98L Drawings\76C76_Contract\Sheet\Civil\Roadway\Plans\08Tr-76C76-sh-Profile-RAMP-01.dgn